

FLOOR PLANS

BANQUET

AUDITORIUM



CAPACITY
320 (with dance floor)
360 (no dance floor)

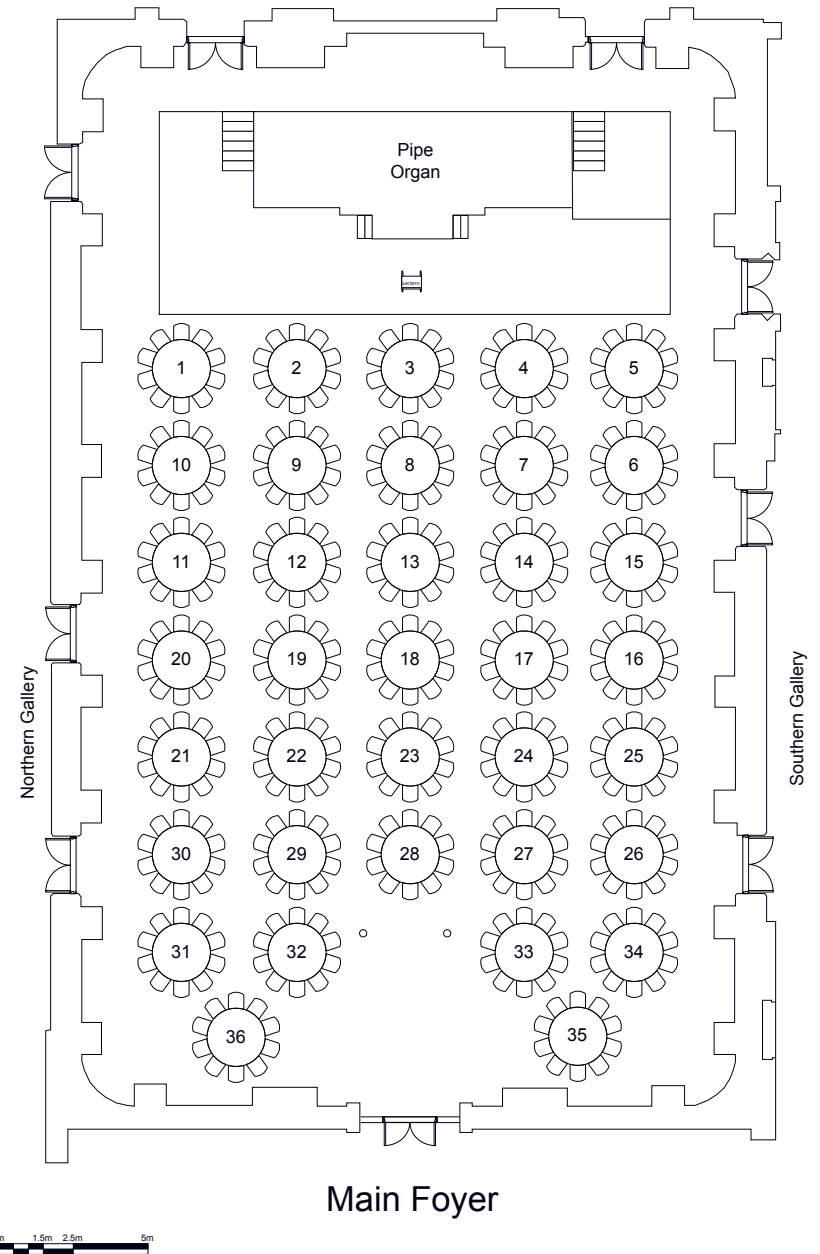

FLOOR PLANS

CABARET

AUDITORIUM

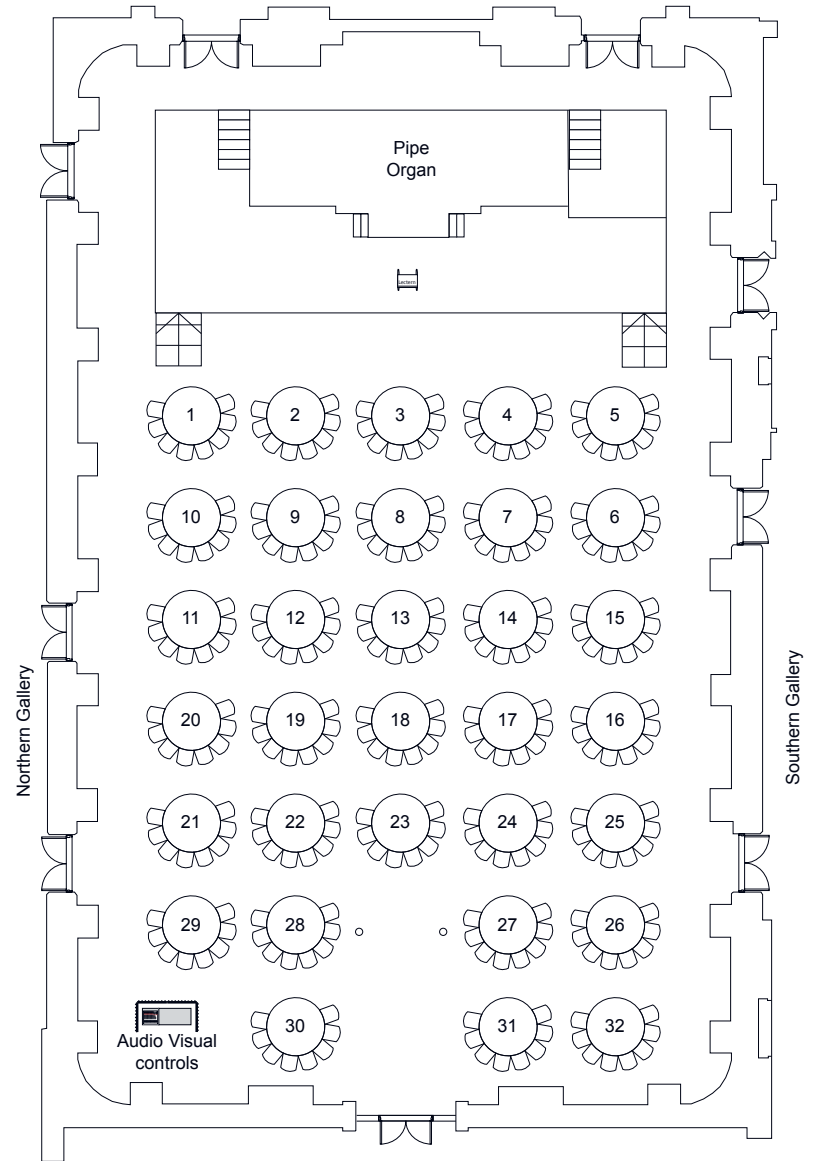

Main Foyer



CAPACITY
256

FLOOR PLANS

COCKTAIL

AUDITORIUM

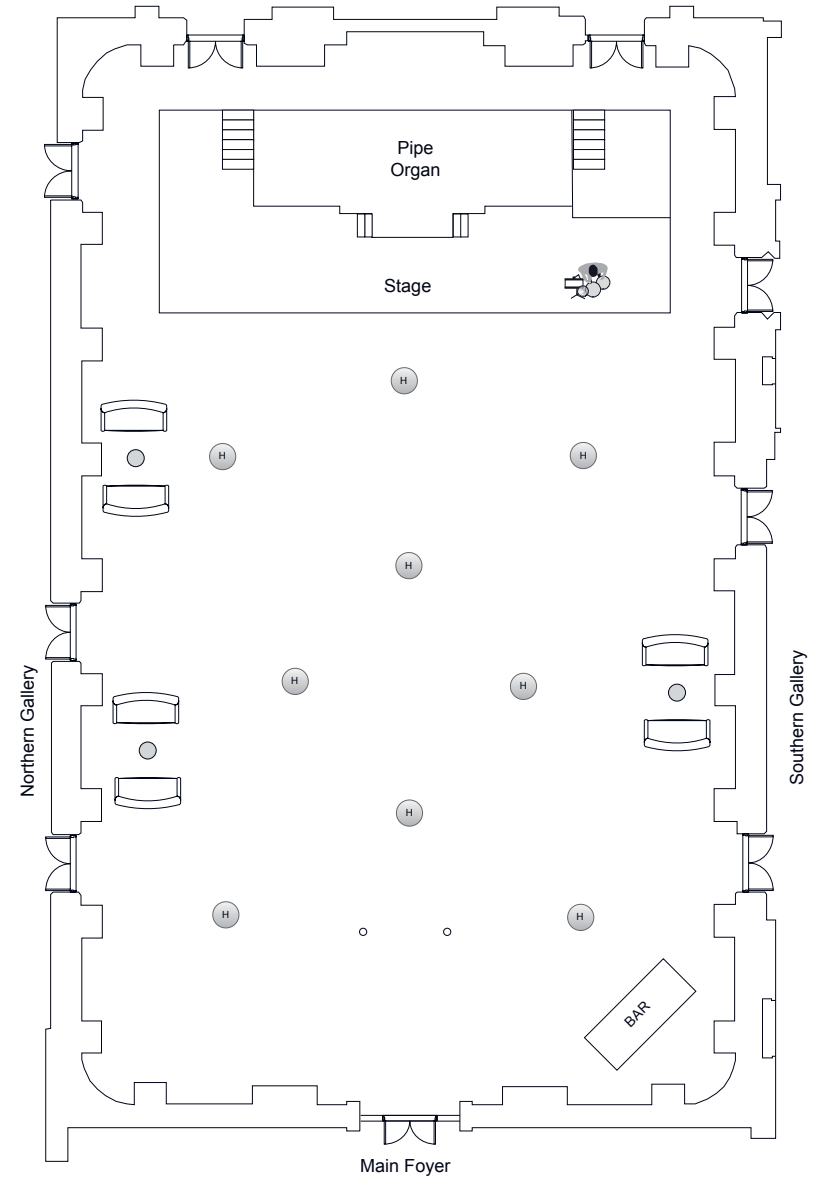

CAPACITY
650

FLOOR PLANS

CONCERT

AUDITORIUM



Please note that this floorplan features our basic stage (2.4m D x 16m W).
 Stage extensions and audio-visual requirements will impact the capacity of this room.
 For a tailored floor plan, please consult the Venue Office.

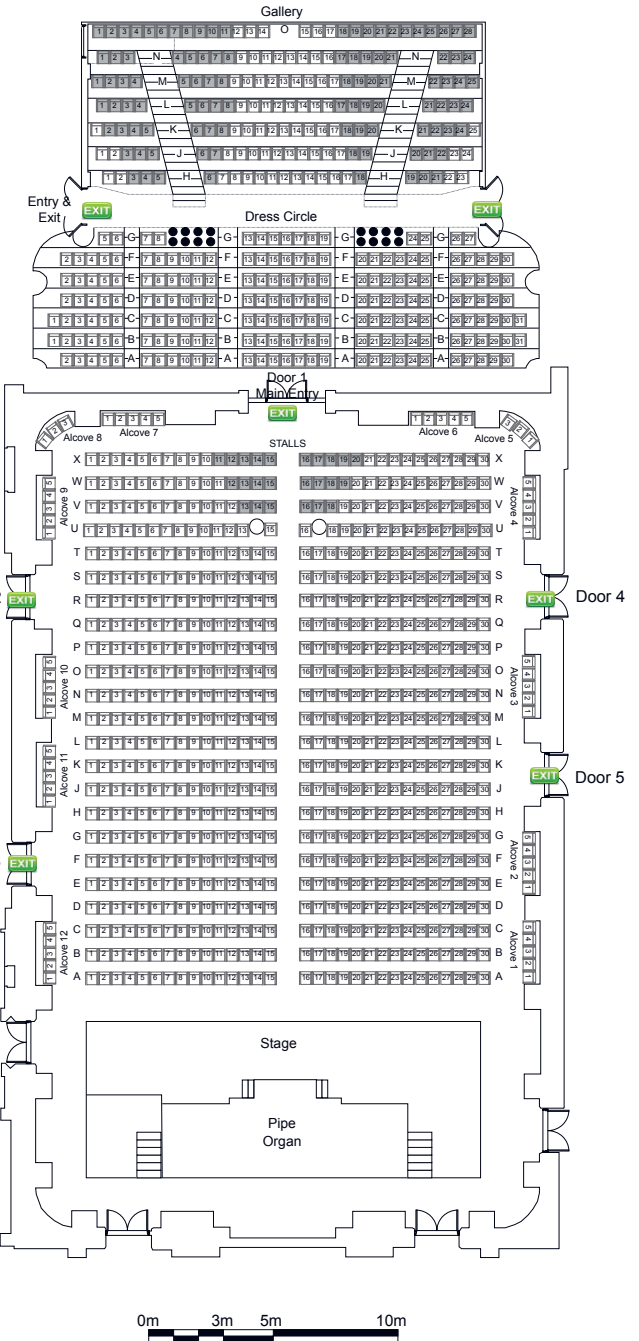

CAPACITY
1,110