

FLOOR PLANS

# BANQUET

AUDITORIUM



CAPACITY  
320 (with dance floor)  
360 (no dance floor)

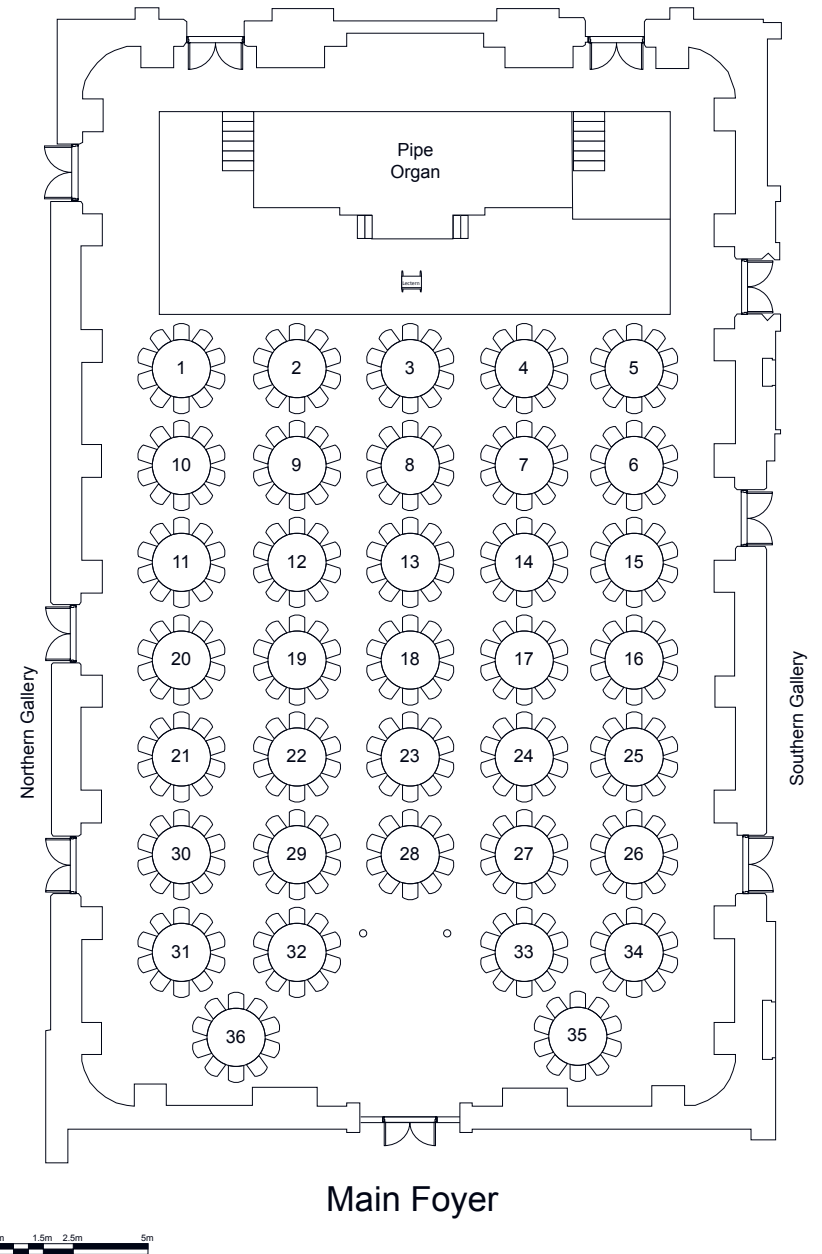

FLOOR PLANS

# CABARET

AUDITORIUM

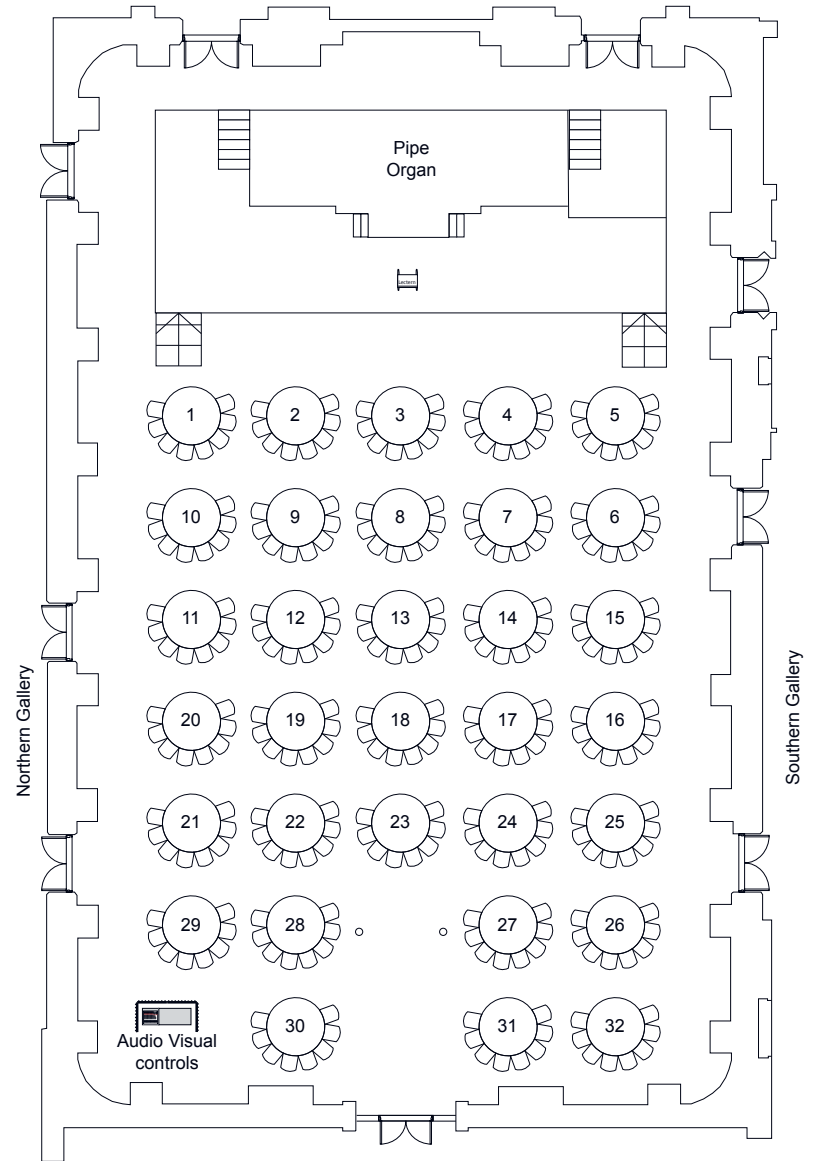

Main Foyer



CAPACITY  
256

FLOOR PLANS

# COCKTAIL

AUDITORIUM

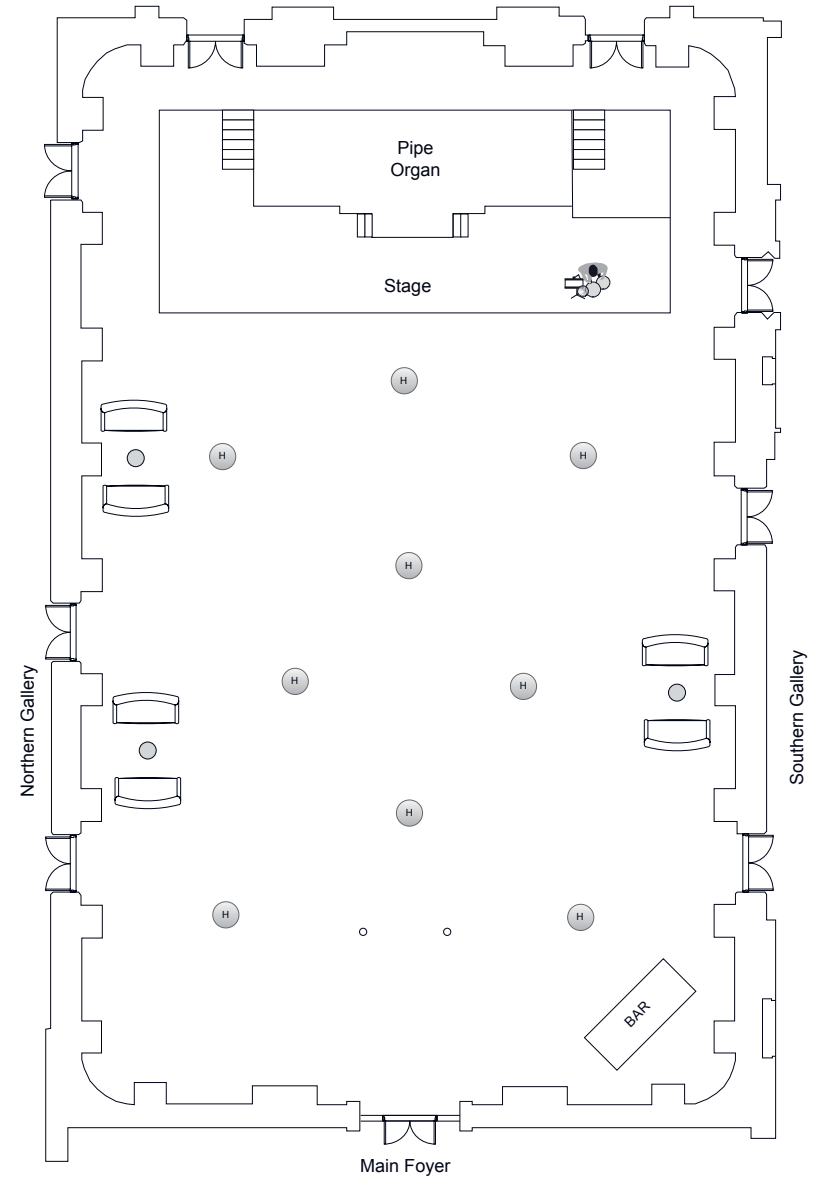

CAPACITY  
650



FLOOR PLANS

# CONCERT

AUDITORIUM



Please note that this floorplan features our basic stage (2.4m D x 16m W).  
 Stage extensions and audio-visual requirements will impact the capacity of this room.  
 For a tailored floor plan, please consult the Venue Office.

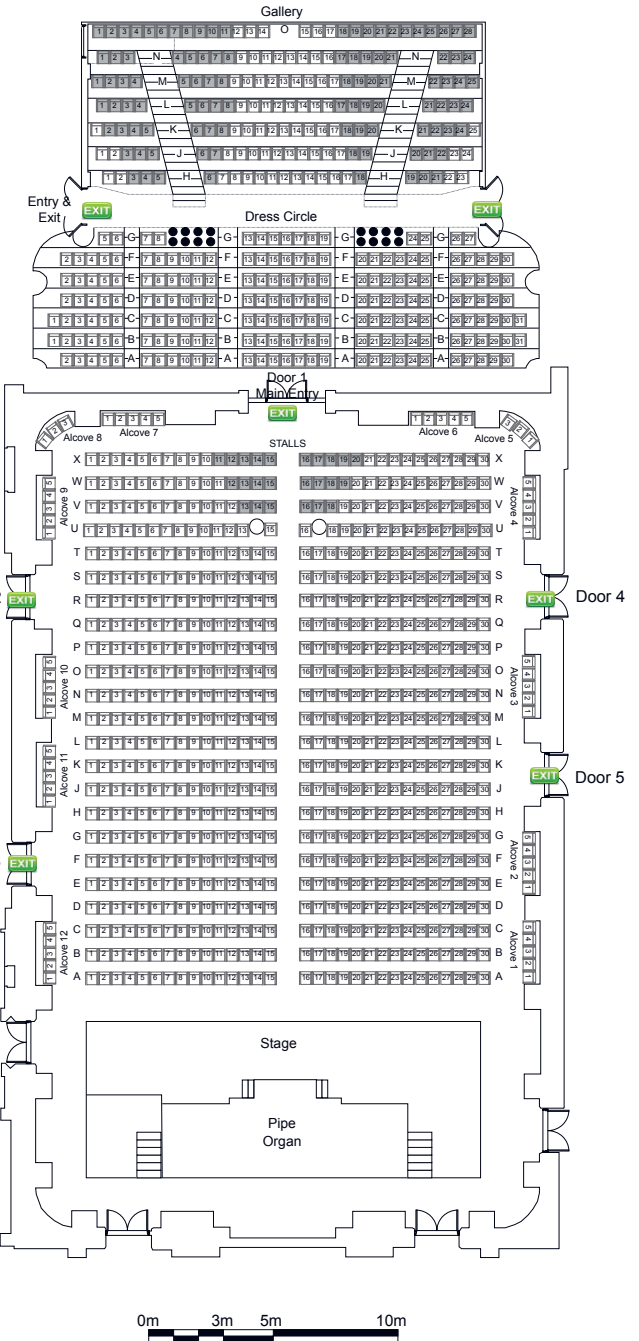

CAPACITY  
1,110