

CoA 106 **100mm STANDARD UPRIGHT KERB & OUTFALL TRAY**
SCALE 1:10 @ A3

MINOR STREETS WITH LOW TRAFFIC VOLUMES WITHIN THE CITY (EXCLUDING ADELAIDE PARK LANDS) WHERE THE INSTALLATION OF 140mm UPRIGHT KERB IS NOT ACHIEVABLE OR PRACTICAL.

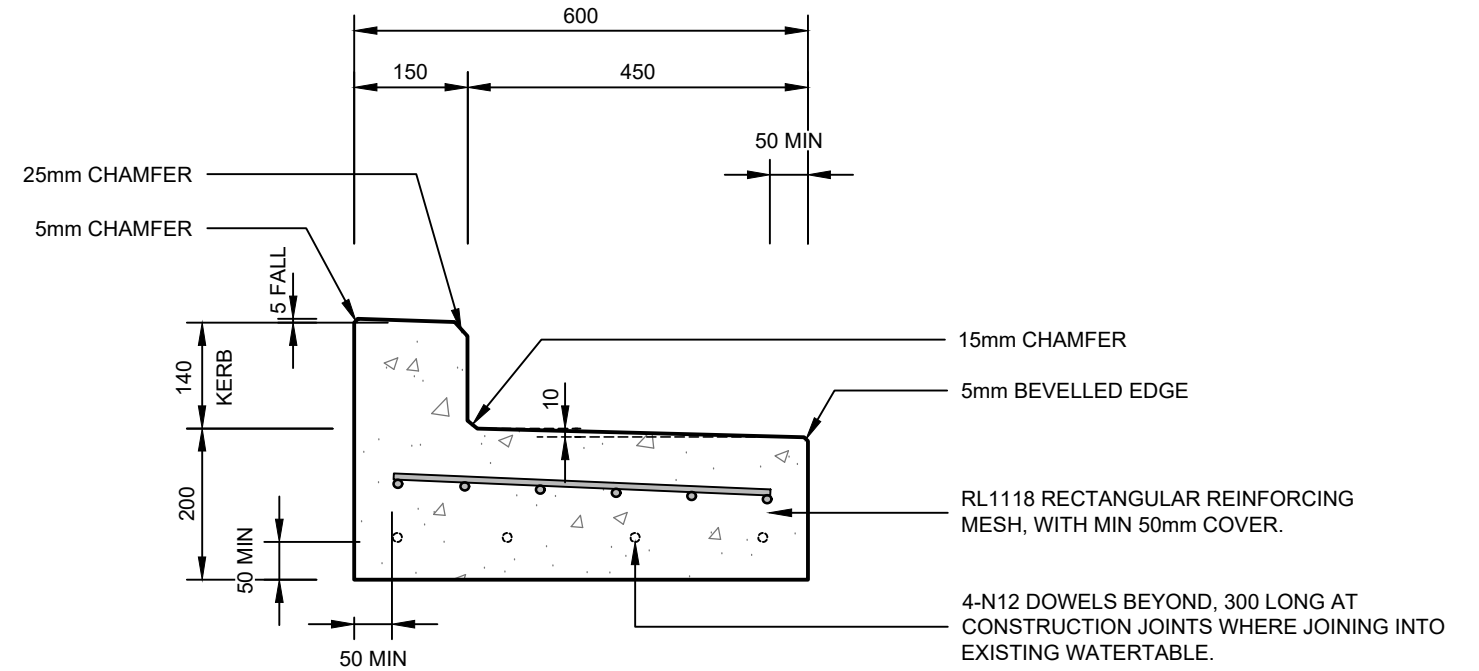

CoA 107 **140mm STANDARD UPRIGHT KERB & OUTFALL TRAY**
SCALE 1:10 @ A3

MINOR STREETS WITH LOW TRAFFIC VOLUMES WITHIN THE CITY (EXCLUDING ADELAIDE PARK LANDS) WHERE ROAD AND FOOTPATH GRADES ALLOW WITHOUT COMPROMISING DRAINAGE CAPACITY.

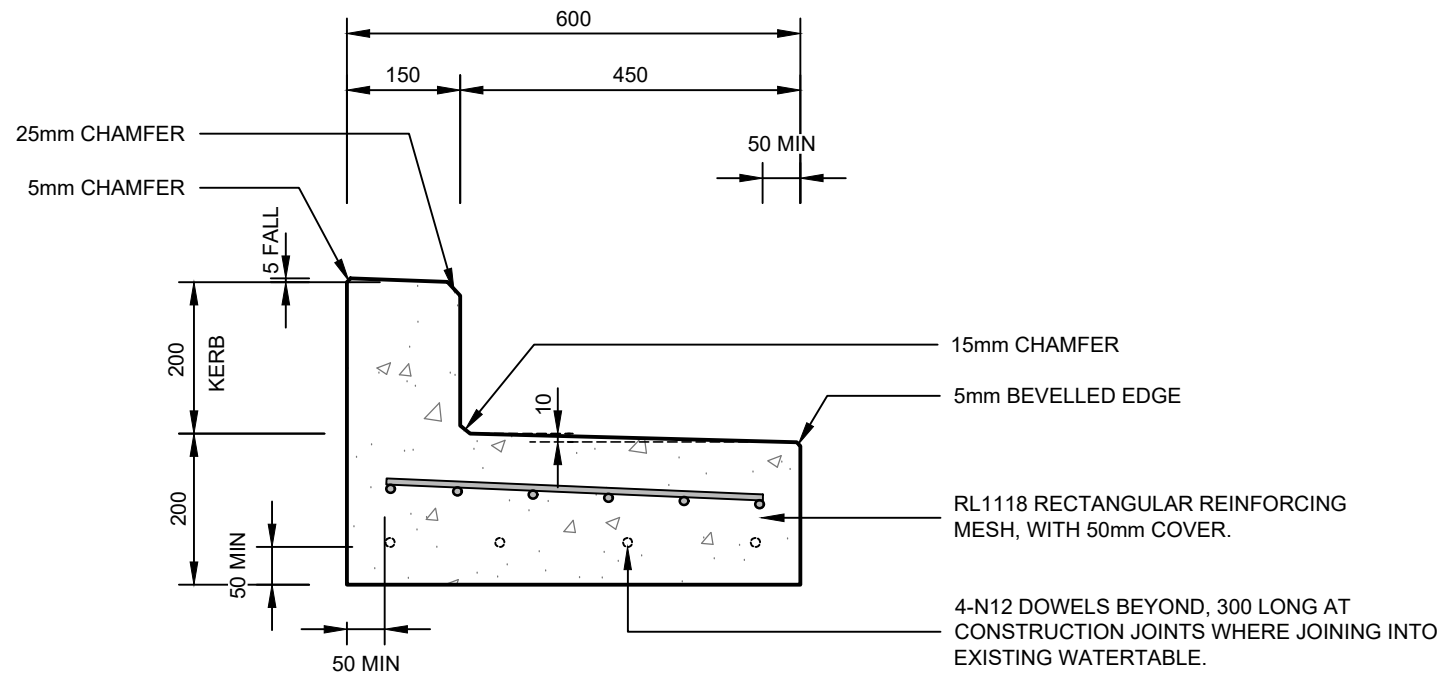

CoA 108 **200mm STANDARD UPRIGHT KERB & OUTFALL TRAY**
SCALE 1:10 @ A3

MINOR STREETS WITH LOW TRAFFIC VOLUMES WITHIN OR ADJACENT THE ADELAIDE PARK LANDS.

GENERAL NOTES:

1. THIS KERB PROFILE IS TO BE USED FOR MINOR STREETS WITH LOW TRAFFIC VOLUMES.
2. THIS KERB PROFILE IS NOT TO BE USED AT BUS STOP LOCATIONS.
3. CONCRETE STRENGTH TO BE 32MPa UNLESS NOTED OTHERWISE.
4. ALL CONCRETE TO BE WATER CURED CONTINUOUSLY FOR 3 DAYS OR ALTERNATIVELY COATED WITH AN APPROVED CURING COMPOUND.
5. CONCRETE KERBING SHALL BE CONSTRUCTED IN ACCORDANCE WITH AS2876, UNLESS NOTED OTHERWISE.
6. SHRINKAGE CONTROL TOOLED JOINTS SHALL BE CONSTRUCTED IN ACCORDANCE WITH AS2876 AT SPACINGS OF 2.5m - 3.0m.
7. FOR INSTALLATION REQUIREMENTS REFER TO CoA 900 / CoA 901.
8. EXPANSION JOINTS (EJ) TO BE CONSTRUCTED AT 15m INTERVALS WITH 10x10mm HIGH PERFORMANCE SILYL MODIFIED POLYMER SEALANT OVER RIGID FOAM FILLER STRIP - FULL DEPTH OF KERB & WATERTABLE SECTION. ALLOW FOR 4-N12 HDG STEEL DOWEL, 400 LONG, WITH MATCHING DOWEL SLEEVES.
9. COLOUR OF KERB TO MATCH ADJACENT KERB (STANDARD GREY, BRIGHTON LITE OR CHARCOAL GREY).

REV	DESCRIPTION	DATE
A	ORIGINAL ISSUE	03/23
B	5mm BEVELLED EDGE	03/23

CONSTRUCTION STANDARD CONCRETE KERBS

100/140/200mm STANDARD UPRIGHT KERB & OUTFALL TRAY - OUTFALL TYPE



SHEET NUMBER	REVISION
CK003	B