

**CoA 120** **THRESHOLD EDGE BEAM - STANDARD**  
SCALE 1:10 @ A3

**NOTES:**

1. THRESHOLD EDGE BEAM IS USED AS AN EDGE RESTRAINT INSTALLED IN PAVED AREAS WITH STEEP SLOPES IN ORDER TO PREVENT HORIZONTAL CREEP AND THE SUBSEQUENT OPENING OF PAVING JOINTS.
2. CONCRETE KERBING SHALL BE CONSTRUCTED IN ACCORDANCE WITH AS2876, UNLESS NOTED OTHERWISE.
3. SHRINKAGE CONTROL TOOLED JOINTS SHALL BE CONSTRUCTED IN ACCORDANCE WITH AS2876 AT SPACINGS 2.5m - 3.0m
4. COLOUR OF KERB TO MATCH ADJACENT KERB (STANDARD GREY, BRIGHTON LITE OR CHARCOAL GREY).

BED: 100mm THICK PM2/20 QG, COMPACTED TO 98% MMDD EXTENDED 300mm EITHER SIDE OF KERB

FINISH: STEEL TROWEL

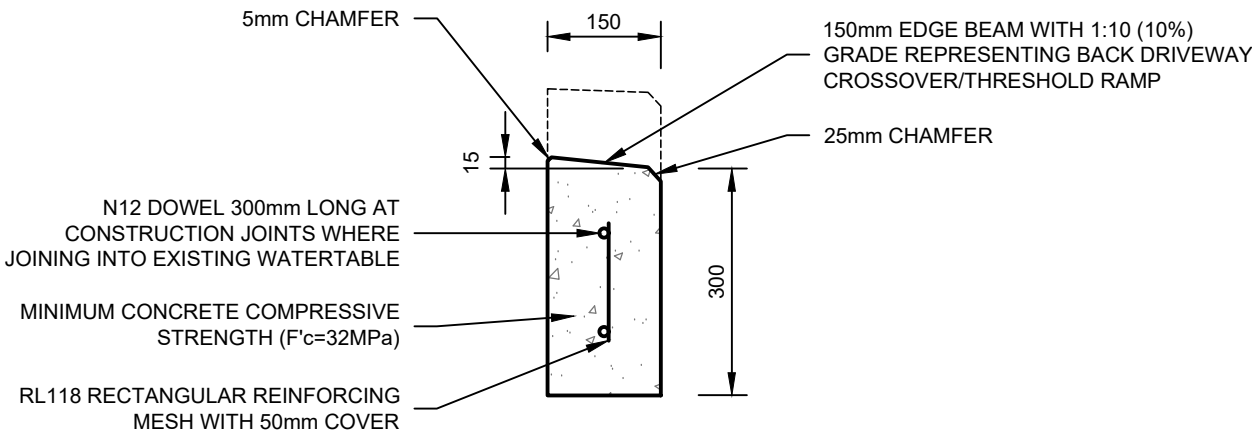

**CoA 121** **THRESHOLD EDGE BEAM - HEAVY DUTY**  
SCALE 1:10 @ A3

**NOTES:**

1. THRESHOLD EDGE BEAM IS USED AS AN EDGE RESTRAINT INSTALLED IN PAVED AREAS WITH STEEP SLOPES IN ORDER TO PREVENT HORIZONTAL CREEP AND THE SUBSEQUENT OPENING OF PAVING JOINTS.
2. CONCRETE KERBING SHALL BE CONSTRUCTED IN ACCORDANCE WITH AS2876, UNLESS NOTED OTHERWISE.
3. SHRINKAGE CONTROL TOOLED JOINTS SHALL BE CONSTRUCTED IN ACCORDANCE WITH AS2876 AT SPACINGS 2.5m - 3.0m.
4. COLOUR OF KERB TO MATCH ADJACENT KERB (STANDARD GREY, BRIGHTON LITE OR CHARCOAL GREY).

BED: 100mm THICK PM2/20 QG, COMPACTED TO 98% MMDD EXTENDED 300mm EITHER SIDE OF KERB

FINISH: STEEL TROWEL

REV	DESCRIPTION	DATE	<div>CONSTRUCTION STANDARD</div> <div>CONCRETE KERBS</div> <div>EDGE BEAMS</div>	<div>CITY OF ADELAIDE</div>	
A	ORIGINAL ISSUE	03/23			
				SHEET NUMBER	REVISION
				CK007	A