

CoA 127 **100mm ROLLOVER KERB & OUTFALL TRAY - RESTRICTED USE**
SCALE 1:10 @ A3

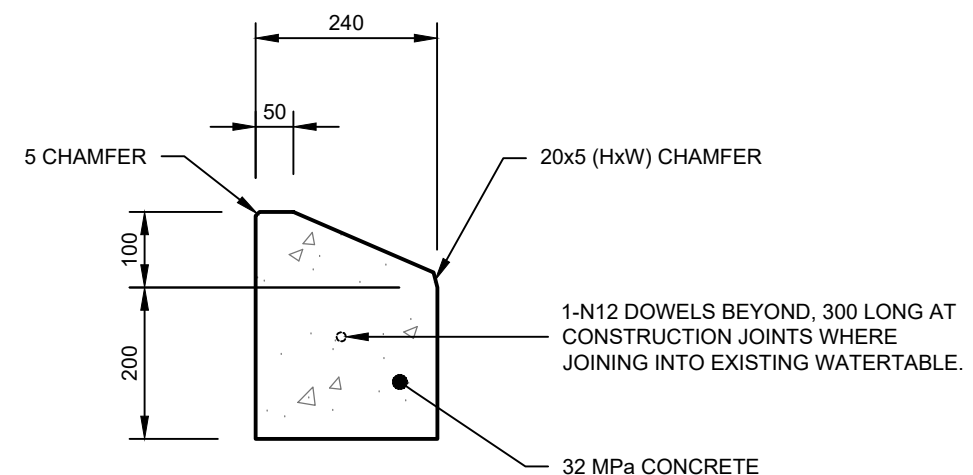

CoA 129 **100mm ROLLOVER KERB - RESTRICTED USE**
SCALE 1:10 @ A3

GENERAL NOTES:

- THIS KERB PROFILE IS TO BE USED FOR MINOR STREETS WITH LOW TRAFFIC VOLUMES.
- THIS KERB PROFILE IS NOT TO BE USED AT BUS STOP LOCATIONS.
- CONCRETE STRENGTH TO BE 32MPa UNLESS NOTED OTHERWISE.
- ALL CONCRETE TO BE WATER CURED CONTINUOUSLY FOR 3 DAYS OR ALTERNATIVELY COATED WITH AN APPROVED CURING COMPOUND.
- CONCRETE KERBING SHALL BE CONSTRUCTED IN ACCORDANCE WITH AS2876, UNLESS NOTED OTHERWISE.
- SHRINKAGE CONTROL TOOLED JOINTS SHALL BE CONSTRUCTED IN ACCORDANCE WITH AS2876 AT SPACINGS OF 2.5m - 3.0m.
- ANY OTHER REINFORCEMENT REQUIRED COVER MINIMUM 30mm, UNLESS OTHERWISE SPECIFIED.
- FOR INSTALLATION REQUIREMENTS REFER TO CoA 900 / CoA 901.
- EXPANSION JOINTS (EJ) TO BE CONSTRUCTED AT 15m INTERVALS WITH 10x10mm HIGH PERFORMANCE SILYL MODIFIED POLYMER SEALANT OVER RIGID FOAM FILLER STRIP - FULL DEPTH OF KERB & WATERTABLE SECTION. ALLOW FOR 4-N12 HDG STEEL DOWEL, 400 LONG, WITH MATCHING DOWEL SLEEVES.
- COLOUR OF KERB TO MATCH ADJACENT KERB (STANDARD GREY, BRIGHTON LITE OR CHARCOAL GREY).
- BED - 100mm THICK, 20mm QUARRY RUBBLE TO PM2/20QG, COMPACTED TO 98% MMDD.
- ANY OTHER REINFORCEMENT REQUIRED COVER MINIMUM 30mm, UNLESS OTHERWISE SPECIFIED.

REV	DESCRIPTION	DATE
A	ORIGINAL ISSUE	03/23
B	5mm BEVELLED EDGE	03/23

CONSTRUCTION STANDARD CONCRETE KERBS

ROLLOVER KERB OUTFALL TRAY / KERB ONLY - RESTRICTED USE



SHEET NUMBER
CK010

REVISION
B