

## HAMPSHIRE HOTEL

110-112 Grote Street

This hotel was erected in 1911 for F.J. Blades and W. Chambers, formerly of the Dragon Brewery, South Terrace. Built to a design by F. Kenneth Milne, a prominent Adelaide architect who first took up practice in South Australia in 1909, it replaced an earlier hotel on the site. The present hotel is believed to be Milne's first major commission. The works of Milne are important to South Australian architecture as he brought influences from the eastern states which show an affinity with the Arts and Crafts Movement and abstracted elements of art nouveau. His suburban bungalows and the Electricity Trust of South Australia office at Clare (1917) embody such influences. After a later sojourn in Britain, Milne became proficient in the Georgian idiom; Arbury Park and his own house, Sunnyside, Stanley Street, being notable examples of this later phase.



(CD Ref 3971/94)

The Hampshire Hotel is one of the most distinctive, if diminutive, hotels in Adelaide. Its asymmetry, use of red brick, the extensive and unusual design of joinery to eaves, and the cantilevered balcony are evocative of the architectural revolution of the early part of the twentieth century. The attenuation of joinery, paned upper sashes and leadlight windows are typical of the period, although such devices were rare in commercial buildings at the time. The integrity of the building is extremely high.

The Hampshire Hotel occupies a corner site, adjacent to a prominent church complex and opposite the former schools, all of which create a distinctive townscape character.

MLSA, Historical photographs (Town Acre 311); Page, M., *Sculptors in space*, 1986, pp. 129-30.

The text in this Information Sheet was copied from the **Heritage of the City of Adelaide: An Illustrated Guide**, (1996). The photographs contained in this Information Sheet are a selection of those held by Heritage Services, in digital format.

The property described in this Information Sheet is included in the Register of State Heritage places. A heritage listing does not mean or imply right of access by the public to such properties.

## Heritage of the City of Adelaide

---

*The heritage related Principles of Development Control as well as the Precinct specific objectives and Principles of Development Control are contained in the Adelaide (City) Development Plan. These should be referred to in whole when contemplating any development.*

*Further information on the Heritage Incentives Scheme, an initiative of Council to sponsor timely and appropriate conservation action is available upon request of the Customer Service Centre.*



## CITY OF ADELAIDE HERITAGE STUDY

### The City Heritage Register-Definition of Items

Prepared by the Dept. of Planning and Development

Item	HAMPSHIRE HOTEL	Building No
Address	110-112 Grote Street, 33-39 Bowen Street, 1-3 Andrew Street	10/0207
		CT 4213/471

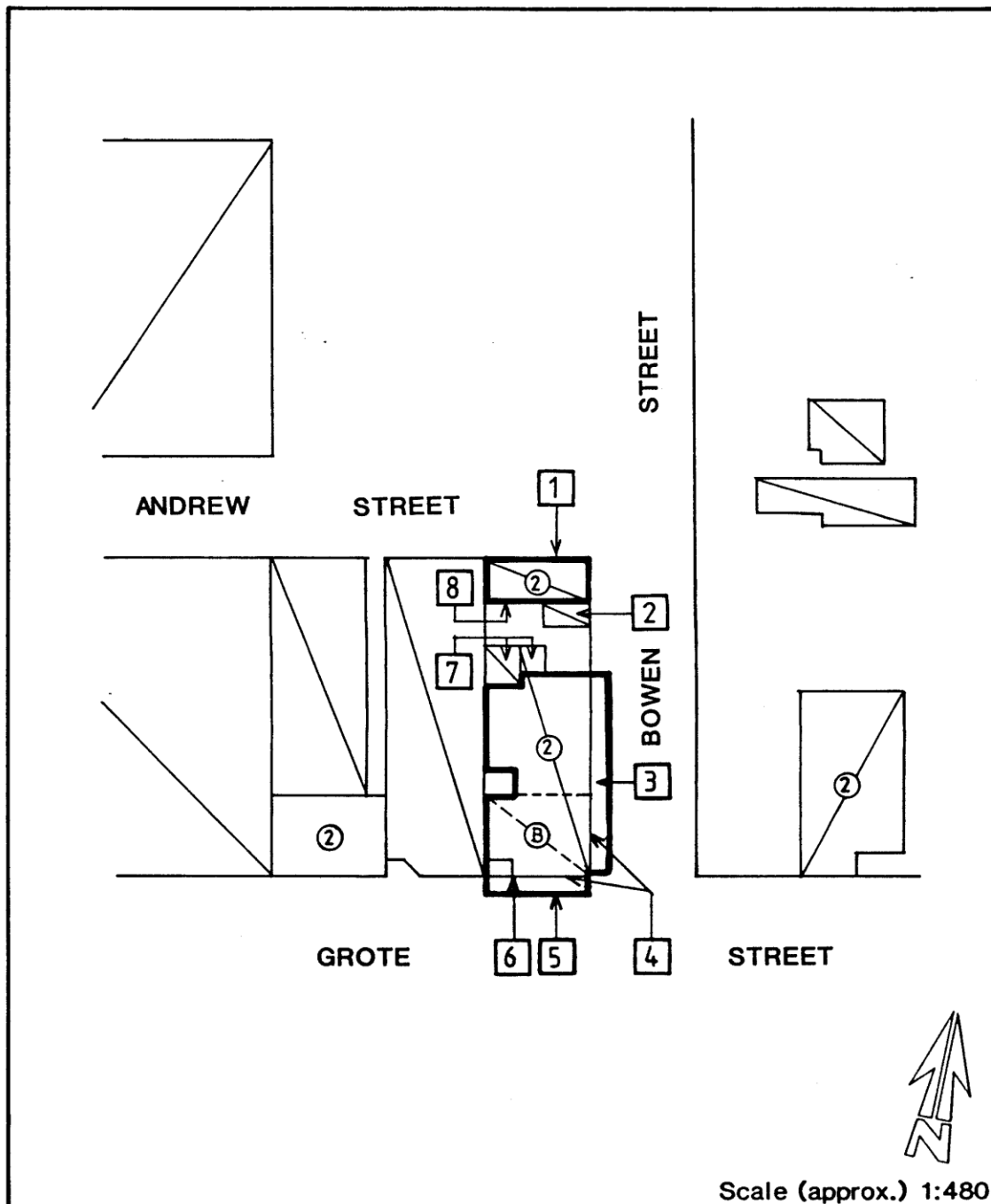

***Image scanned - not to stated scale.***

This Curtilage Map has been prepared as a guide only and no warranty or assurance is given about the accuracy of the content as it may contain obsolete information. The Corporation excludes all liability [including for negligence] in relation to your use of these documents.



## CITY OF ADELAIDE HERITAGE STUDY

### The City Heritage Register-Definition of Items

Prepared by the Dept. of Planning and Development

<b>Item</b>	<b>HAMPSHIRE HOTEL</b>	<b>Building No</b>
<b>Address</b>	110-112 Grote Street, 33-39 Bowen Street, 1-3 Andrew Street	10/0207 CT 4213/471

#### NOTES:

1. Rendered.
2. Recent brick addition.
3. Note: Timber brackets supporting wide eaves.
4. Note: Leadlight and multi-paned windows.
5. Note: Timber joinery to balcony.
6. Brick (English Bond).
7. Early brick additions.
8. Random bluestone.