

ETHNIC AFFAIRS COMMISSION BUILDING

14-20 Flinders Street

This building which has a colourful history was originally constructed as the Stow Memorial Manse in 1869. It is also significant because of its use as Dr Timothy Augustine Hynes' sanatorium from 1901-11. Dr Hynes' sanatorium was the first of its kind in Adelaide where a doctor was continually in attendance. Since 1911, the building has successfully functioned as offices.

Architecturally its interest lies in the successful transformation of a bluestone Gothic structure to one of an Italianate rendered building.

In an area containing several other important buildings such as the Treasury, the Adelaide Town Hall and the Meeting Hall tucked in behind the Pilgrim Church, this building contributes to the environment and complements the other historical styles represented.

The minister of the former Stow Memorial Church (next door) found it difficult to rent a suitable residence in the city so a design competition was held for a manse, and in 1868 Wright, Woods and Hamilton's design was chosen. Described as Gothic, it was a manse with ten apartments designed in keeping with the chaste style of the church.

The manse was constructed by Brown and Thompson using Glen Osmond stone with white dressings, and in places, coloured brick. Venetian shutters were added. In 1877 further additions were made before the building was rented out. It was sold in 1901 to eliminate church debts.

The property was bought by 'the popular Adelaide medico' Dr Hynes. Under the supervision of Edward John Woods the original bluestone building was rendered and transformed into a structure of Italianate style with the addition of a colonnaded facade to the south, west and rear extensions.

Dr Hynes was born at Blumberg (Birdwood) in 1865, graduating in medicine and surgery at Edinburgh University and eventually returning as senior surgeon to the Royal Adelaide Hospital. In 1889 he bought the practice of Dr O'Connell, one the city's leading physicians. Hynes' sanatorium which was based on the American model was regarded as an innovation in hospitals. It was the first of its kind in Adelaide, and in the heart of the city 'in coo-ee of the General Post office'.

Dr Hynes believed that illness was best treated ' . . . when mental conditions are soothed and improved by cheerful surroundings', and that ' . . . patients should have not the minimum but the maximum of comfort'. A fixed fee of five guineas a week provided for all medical and nursing treatment at the sanatorium as well as such comforts as the free use of ' . . . a roomy motor car and a box at the theatre', orchestral concerts and a handball court.

As Forbes Sage remarks in his article on Hynes, ' . . . it must have been a pretty good place in which to suffer!'.

Heritage of the City of Adelaide

In 1911 the building was sold to the state government and used as the registry office. A large two storey extension was added to the north side in the 1920s which was occupied by the Attorney General's Department.

In 1975-76 the building was totally renovated, particular attention being paid to restore the facade to the period of Dr Hynes' sanatorium. The interior, with its large, pleasant rooms, was also retained, and further opened up with archways, ' . . . thus providing spaces suitable for modern office requirements without destroying the character of the structure'. The project was awarded the Royal Australian Institute of Architects, South Australian Chapter Award for Merit in 1978.

ACA, Smith Survey 1880; Burgess, H.T., *Cyclopedia of South Australia*, Vol. 2, 1909, pp. 57-8; Dallwitz, J.C., & Danvers, R.A., *An urban design and conservation study of the old attorney general's building*, Super Environment Design and Research Studio, September 1974; MLSA, *Bierbaum files*, Historical photographs (Town Acre 235), Jones, B.L., *History of Stow Memorial Church*, A1248, 1954; *Observer*, 14 November 1868, 19 September 1868; *Perspective*, Vol. 4, No. 3, 1979, p. 19; *Quiz*, 2 September 1904; Sage, F., When doctors used motor cars to cure in *Public Service Association Review*, 5 November 1973; Smillie, J. (ed), *Descriptive Australia and federal guide*, 1890.

The text in this Information Sheet was copied from the **Heritage of the City of Adelaide: An Illustrated Guide**, (1996). The photographs contained in this Information Sheet are a selection of those held by Heritage Services, in digital format.

The property described in this Information Sheet is included in the Register of State Heritage places. A heritage listing does not mean or imply right of access by the public to such properties.

The heritage related Principles of Development Control as well as the Precinct specific objectives and Principles of Development Control are contained in the Adelaide (City) Development Plan. These should be referred to in whole when contemplating any development.

Further information on the Heritage Incentives Scheme, an initiative of Council to sponsor timely and appropriate conservation action is available upon request of the Customer Service Centre.



CITY OF ADELAIDE HERITAGE STUDY

The City Heritage Register - Definition of Items

Prepared by the Dept. of Planning and Development

Item	ETHNIC AFFAIRS COMMISSION	Building No 7/2008
Address	14-20 Flinders Street	CT 681/180

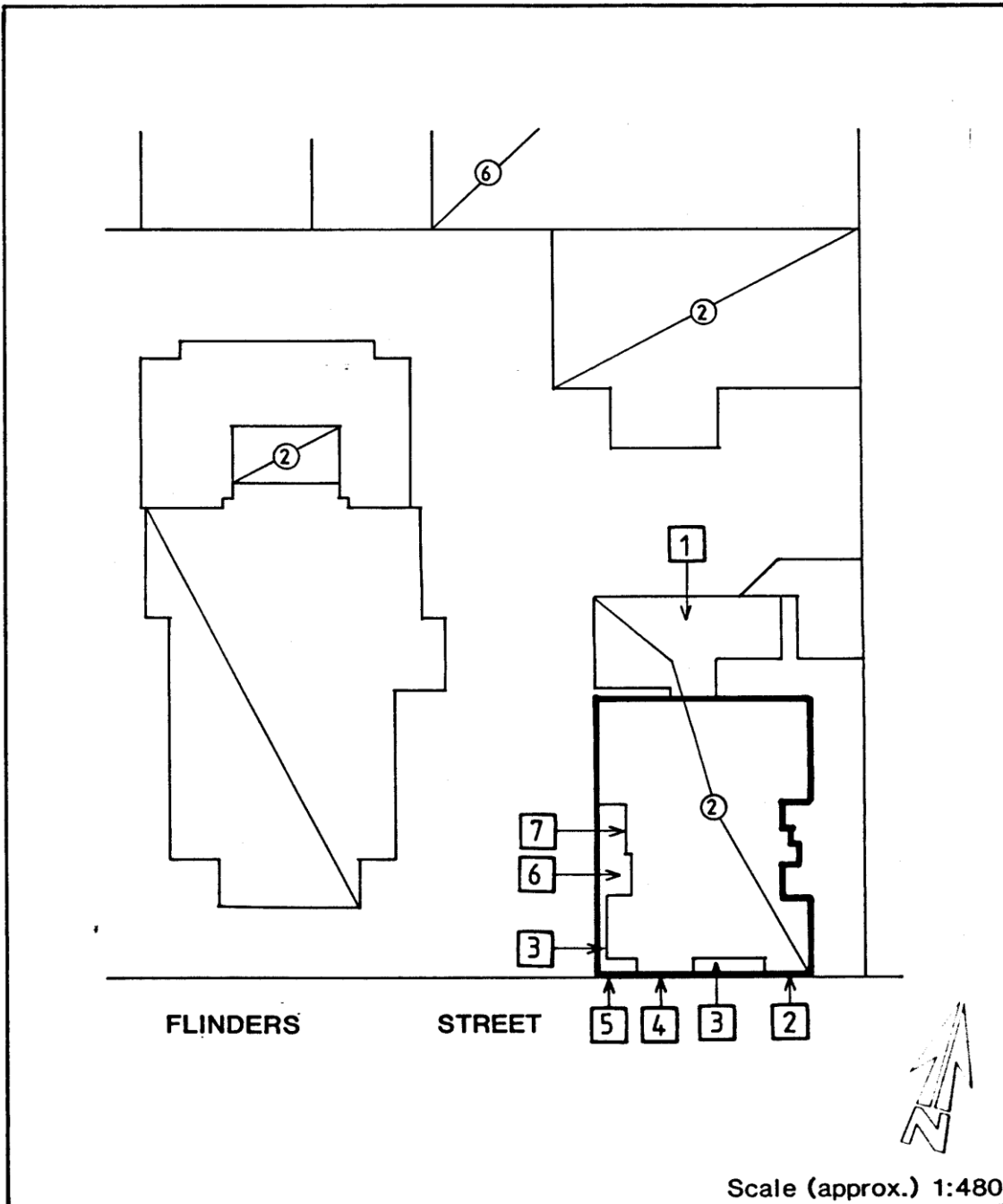

Image scanned - not to stated scale.

This Curtilage Map has been prepared as a guide only and no warranty or assurance is given about the accuracy of the content as it may contain obsolete information. The Corporation excludes all liability [including for negligence] in relation to your use of these documents.



CITY OF ADELAIDE HERITAGE STUDY

The City Heritage Register-Definition of Items

Prepared by the Dept. of Planning and Development

Item	ETHNIC AFFAIRS COMMISSION	Building No 7/2008
Address	14-20 Flinders Street	CT 681/180

NOTES:

1. Brick addition.
2. Brick facade (English bond) with stucco enrichment and plinth, rusticated quoins.
3. Brick and stucco arched verandah.
4. Note Floral decoration and pediment above windows.
5. Note Parapet all round.
6. Cast iron stairs and gate.
7. Rendered.