

STABLES AND FORMER HOUSE

off 147 Frome Street

As the elaborate head offices of South Australia's leading businesses were erected at the city centre, their equally important warehouses and transport depots were constructed in less public thoroughfares at the margins of the centre. As stabling was required for the many hundreds of horses which hauled the firms' goods and supplies, many of these, together with several large livery and letting stables, were located within the city. During the late nineteenth century livery stables stood cheek-by-jowl with cottages, shops and churches of the surrounding city, as shown in panoramic views of Adelaide at the time. Probably the best surviving example of such large horse transport premises is this extensive brick and stone complex off Frome Street.



Prior to Adaptation (CD Ref 3964/53)

The stable block, two storey house and other buildings, and the boundary wall, form an extensive, if partly ruined complex. This well illustrates the scale and type of horse transport depots which were such an important feature of the city during the nineteenth century. The complex is built of sandstone rubble. Dressings and parts of the stable floors are of red brick. The large stable block with its wide opening spanned by cast-iron members and segmentally arched self-supporting corrugated iron roof is of great interest. The first floor is supported by cast-iron members, spans being achieved by covered sheets of corrugated iron, a method of construction reminiscent of early bridge decking.

Heritage of the City of Adelaide

The stable complex served two wine and spirit firms. It was built in 1883 for Reid, Jay, and Co., later Reid and Heseltine, a wine and spirit company in Grenfell Street operated by William Reid and Samuel Heseltine. In 1891 the company was bought out by A.E. and F. Tolley, a rival and much larger wine and spirit company and general merchants. This company was set up in Adelaide in 1874, becoming a partnership of two Tolley brothers in 1877. By the 1890s the company was a significant Australian import-export business, importing goods from England and exporting wine and other produce to centres throughout South Australia, Western Australia, Queensland and New South Wales.

The firm needed offices at Port Adelaide as well as its own large transport facilities to carry merchandise to and from the port. The premises off Frome Street were chosen, but it seems to have been used only until about 1911 as at least part of the premises was sold in that year.

ACA, Assessments; *Ford's York Hotel guide to Adelaide*, 1894; *Mail*, 18 April 1936; Morrison, W E, *The Aldine history of South Australia*, Vol. 2, 1890, p. 817; Tolley, A.E., & Tolley, F., *The first hundred years*, C. 1974.

The text in this Information Sheet was copied from the **Heritage of the City of Adelaide: An Illustrated Guide**, (1996). The photographs contained in this Information Sheet are a selection of those held by Heritage Services, in digital format.

The property described in this Information Sheet is included in the Register of State Heritage places. A heritage listing does not mean or imply right of access by the public to such properties.

The heritage related Principles of Development Control as well as the Precinct specific objectives and Principles of Development Control are contained in the Adelaide (City) Development Plan. These should be referred to in whole when contemplating any development.

Further information on the Heritage Incentives Scheme, an initiative of Council to sponsor timely and appropriate conservation action is available upon request of the Customer Service Centre.



CITY OF ADELAIDE HERITAGE STUDY

The City Heritage Register-Definition of Items

Prepared by the Dept. of Planning and Development

Item	Former STABLES AND OUTBUILDINGS	Building No 8/2017-2 & 8/2017-3 CT 398/107
Address	Off 147 Frome Street, West of Frome Street between Pirie and Flinders Streets	

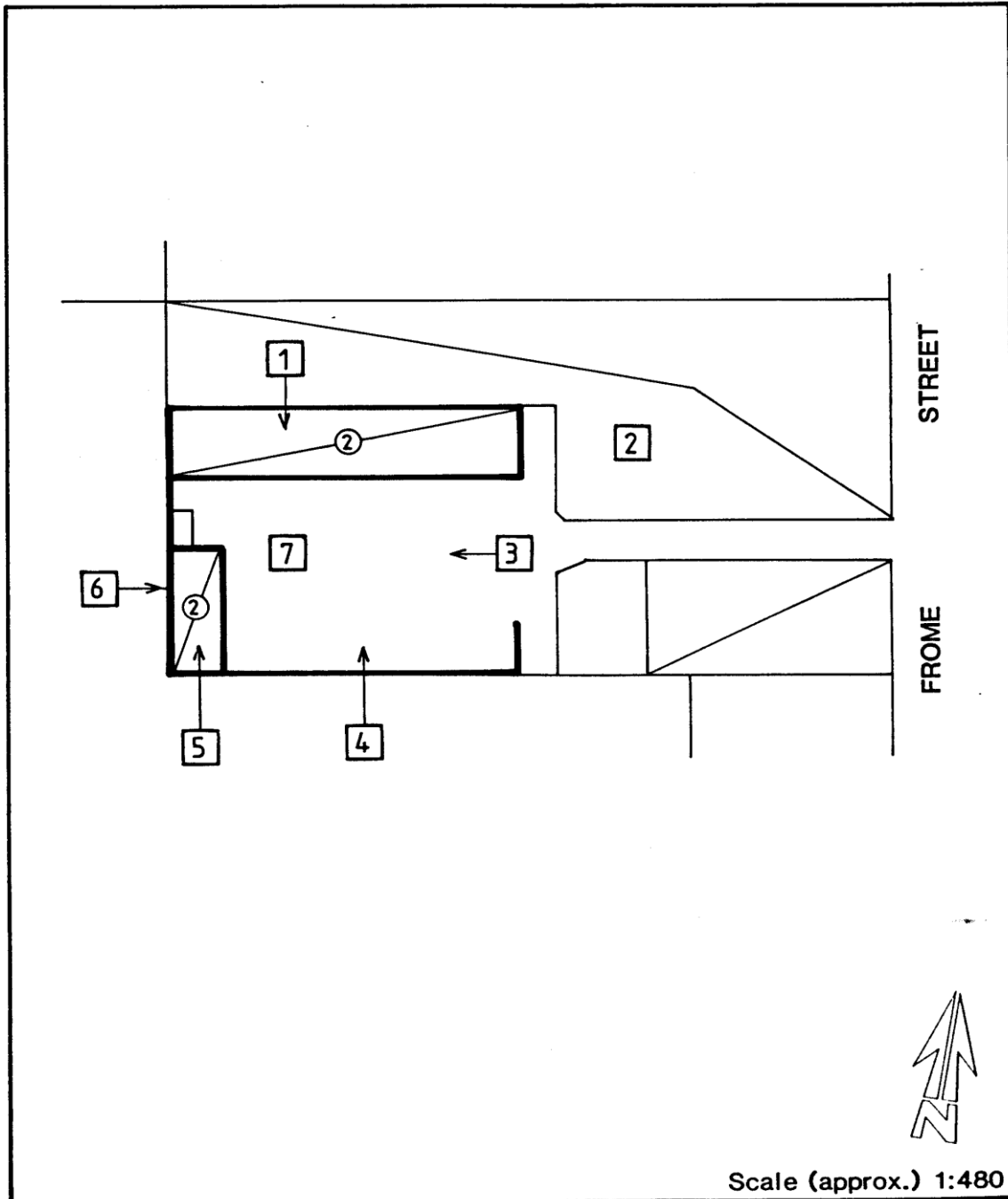

Image scanned - not to stated scale.

This Curtilage Map has been prepared as a guide only and no warranty or assurance is given about the accuracy of the content as it may contain obsolete information. The Corporation excludes all liability [including for negligence] in relation to your use of these documents.



CITY OF ADELAIDE HERITAGE STUDY

The City Heritage Register-Definition of Items

Prepared by the Dept. of Planning and Development

Item	Former STABLES AND OUTBUILDINGS	Building No
Address	Off 147 Frome Street, West of Frome Street between Pirie and Flinders Streets	8/2017-2 & 8/2017-3 CT 398/107

NOTES:

1. Barrel-vaulted, double storeyed stable block.
2. Note cast iron supporting columns and internal structure.
3. Brick paved court.
4. Former lean-to (formerly having barrel-vaulted roofing).
5. Former residential quarters.
6. Sandstone rubble with brick quoins and bluestone plinth.
7. Brick.