

HOUSE (Formerly Creveen)

153-159 Kermode Street



(CD Ref 1721/95)

In 1879 one of the ' . . . more conspicuous buildings put up during the year' was the impressive house erected for Reverend Osric Copeland. This house was described as being of two storeys with about nine rooms, and costing about £1800. The architect was Thomas Frost, the contractors J. King and Son. Frost also designed Whinham College at the corner of Ward and Jeffcott streets and the villas in Barnard, Molesworth and Hill

streets for the City Land Investment Company, and worked on the construction and extensions to Brougham Place Congregational church. Because of this association Frost designed this house as Copeland was pastor of the church from 1877 to 1884.

The *South Australian Register*, 8 September 1923 described Copeland as ' . . . a thoughtful and poetic preacher, a faithful pastor and the loving friend of the poor. He was largely instrumental in the formation of the fellowship at Meningie which took place in 1882'. The impulse for house construction was probably his marriage which took place in September 1879 when his stipend was increased from £500 to £600. Copeland was very actively involved in the public questions of the day such as the removal of the opportunities for vice, especially drinking and gambling. He led a crusade against the latter: the totalizator had been introduced in 1879 and the volume of gambling had increased. Copeland and Conigrave (a church member) and other leading Congregationalists were successful in having the totalizator abolished, but as their influence waned, it was reinstated in 1888. By then Copeland had moved on to Melbourne.

The building was later used as a girls' school known as Creveen, started by Miss Rita Cussen in 1910. Additions were made to the house in 1915-16 when Creveen became a secondary girls' school under the guidance of Miss Kathleen Cussen. It was closely associated with the Church of England, religious services being held regularly at Christ Church (across Palmer Place) with the rector acting as school chaplain:

By 1922 the school was in a very flourishing condition and was considered one of the most influential schools of its type in South Australia . . . the enrolment had grown to 125 scholars . . . For the next decade, the school continued to hold an honoured place in the educational life of the State.

Heritage of the City of Adelaide

The school was, however, badly affected by the Depression, enrolments dropped, and it was closed at the end of 1934.

Apart from its historical associations, the distinguished design of the house gives it special prominence in Palmer Place and Kermode Street. The unusual plan form makes excellent use of the corner site. The design features crisp stucco work combined with squared sandstone. It presents remarkably original elevations to both streets, the entrance surround to Kermode Street being a particularly strong visual element.

ACA, Smith Survey 1880; Morgan, E.J.R., & Gilbert, S.H., *Early Adelaide architecture 1836 to 1886*, 1969, p. 101; North Adelaide Congregational Church, *Our first century 1859-1959*, 1959, pp. 12-13; PRO, Nicholas, R.J., 'Private and denominational secondary schools of South Australia', University of Melbourne, 1951, p. 219; *South Australian Register*, 2 January 1880, 8 September 1923.

The property described in this Information Sheet is included in the Register of State Heritage places. A heritage listing does not mean or imply right of access by the public to such properties.



(CD Ref 1721/96)

The text in this Information Sheet was copied from the **Heritage of the City of Adelaide: An Illustrated Guide**, (1996). The photographs contained in this Information Sheet are a selection of those held by Heritage Services, in digital format.

The heritage related Principles of Development Control as well as the Precinct specific objectives and Principles of Development Control are contained in the Adelaide (City) Development Plan. These should be referred to in whole when contemplating any development.

Further information on the Heritage Incentives Scheme, an initiative of Council to sponsor timely and appropriate conservation action is available upon request of the Customer Service Centre.



CITY OF ADELAIDE HERITAGE STUDY

The City Heritage Register-Definition of Items

Prepared by the Dept. of Planning and Development

Item	HOUSE	Building No
Address	91-92 Palmer Place, North Adelaide; 153-159 Kermode Street	35/2001 CT 2851/199

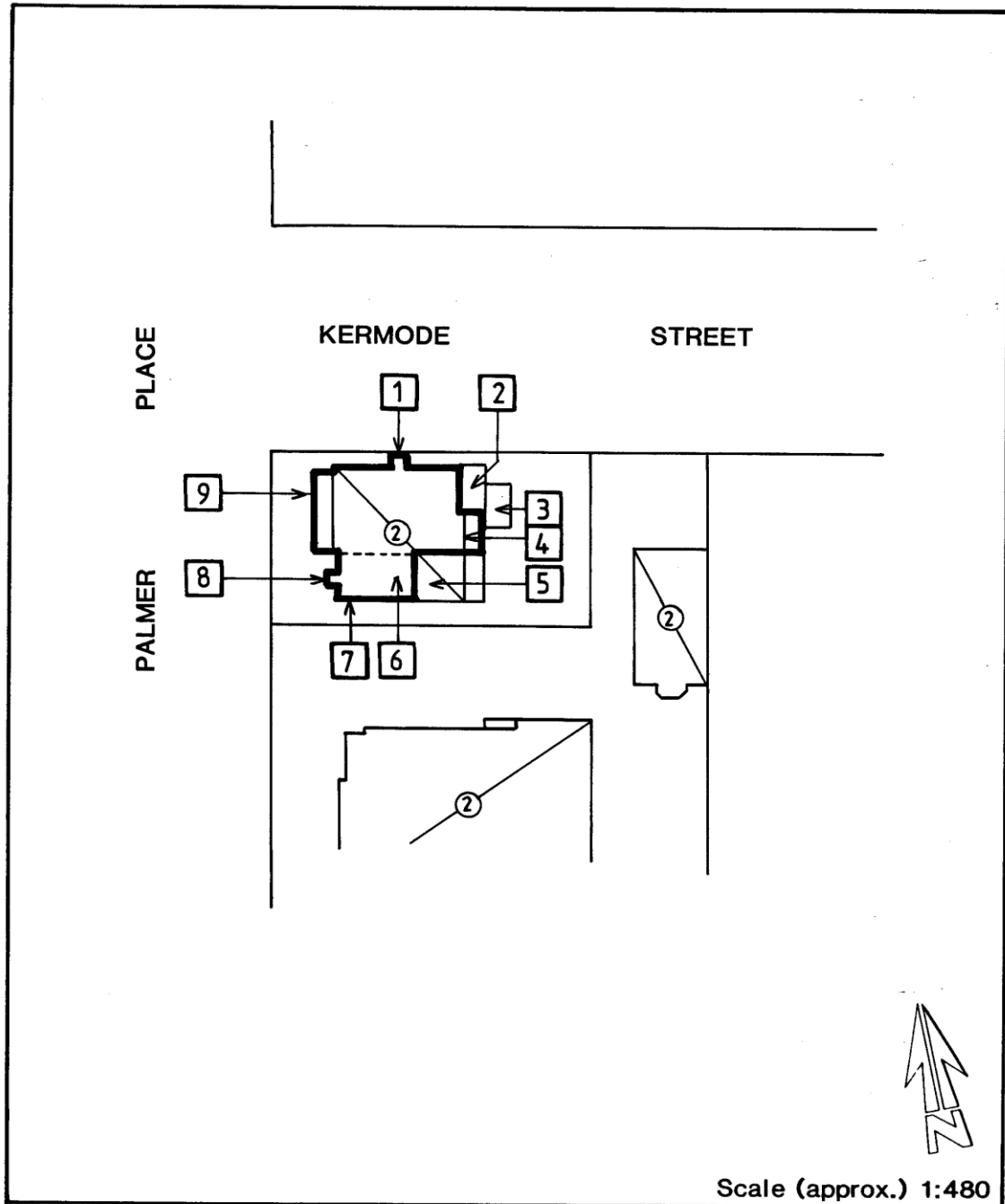

Image scanned - not to stated scale.

This Curtilage Map has been prepared as a guide only and no warranty or assurance is given about the accuracy of the content as it may contain obsolete information. The Corporation excludes all liability [including for negligence] in relation to your use of these documents.



CITY OF ADELAIDE HERITAGE STUDY

The City Heritage Register-Definition of Items

Prepared by the Dept. of Planning and Development

Item	HOUSE	Building No
Address	91-92 Palmer Place, North Adelaide; 153-159 Kermode Street	35/2001 CT 2851/199

NOTES:

1. Rendered rusticated entrance.
2. Rendered addition.
3. Stairs.
4. Balcony.
5. Early brick addition.
6. Early brick addition at first floor level.
7. Coursed squared sandstone with stucco enrichment and rusticated quoins.
8. Note window hood.
9. Note timber joinery to verandah.