

## QUEEN ADELAIDE CLUB

182-184 North Terrace

The Queen Adelaide Club is the female equivalent of the Adelaide Club and embodies the conservatism, exclusiveness and respectability which has always been a feature of Adelaide society. The club, founded in 1909, is much younger than its male counterpart, and was created at a time of increasing independence of women. The North Terrace buildings were erected originally as doctors' rooms, and the club gradually expanded into them, finally purchasing the buildings from the South Australian Company in 1920. The complex harks back to the residential nature of North Terrace which was once its most prominent feature. Although the three buildings which form the complex have been greatly altered they retain the appearance of distinctive structures and provide variety of scale and punctuation to the architecture of the North Terrace streetscape.

Part of the Queen Adelaide Club premises was once owned by Dr Thomas Cawley. In 1894 Cawley purchased land at the south-eastern corner of Stephens Place and North Terrace from the South Australian Company and in March 1895 the architects Williams and Good advertised tenders for the erection of Cawley's rooms. This is the two storey building on the corner. Additions were carried out in 1897 and 1900. By the time of Dr Cawley's death in 1906 the South Australian Company appears to have repurchased the property. Dr Souter and Dr Driscoll leased the rooms, Driscoll asking the South Australian Company to remove the ground floor veranda as it darkened his rooms. This was carried out in 1907-8, leaving the cantilevered balcony to North Terrace seen today.



(CD Ref 2016/17)

The back rooms were mainly built of wood and iron and were reportedly very hot in summer. The company decided to erect in their place a modern brick building. In November 1908 the architects English & Soward advertised tenders for consulting rooms in Stephens Place. In March 1909 it was noted that ' . . . all the rooms now in course of construction, other than the three taken by Dr Driscoll, have been let to the Committee of the Ladies Club'. This Queen Adelaide Club was officially opened by Lady Bosanquet in July 1909. In 1911 additions were built on the North Terrace frontage between

the North Terrace frontage between Stephens Place and Gawler Chambers, the offices of the South Australian Company. In 1920 the complex of three buildings was purchased by the Queen Adelaide Club for £16 000.

ACA, Assessments 1879, 1892, 1896, 1902-14, 1920, *Digest of Proceedings*, 29 March 1909, p. 144; MLSA, BRG 42 South Australian Company: register of places, Letters of director to

## Heritage of the City of Adelaide

---

London, 1906-20; Historical photographs (Town Acre 19), *South Australian Register*, 2 March 1895, 4 January 1897, 7 November 1908, 2 July 1909.

The text in this Information Sheet was copied from the **Heritage of the City of Adelaide: An Illustrated Guide**, (1996). The photographs contained in this Information Sheet are a selection of those held by Heritage Services, in digital format.

The property described in this Information Sheet is a place of Local Heritage (City Significance). A heritage listing does not mean or imply right of access by the public to such properties.

*The heritage related Principles of Development Control as well as the Precinct specific objectives and Principles of Development Control are contained in the Adelaide (City) Development Plan. These should be referred to in whole when contemplating any development.*

*Further information on the Heritage Incentives Scheme, an initiative of Council to sponsor timely and appropriate conservation action is available upon request of the Customer Service Centre.*



# CITY OF ADELAIDE HERITAGE STUDY

## The City Heritage Register-Definition of Items

Prepared by the Dept. of Planning and Development

Item	QUEEN ADELAIDE CLUB	Building No	3/0201
Address	182-184 North Terrace; 2-6 Stephens Place		CT 1376/39

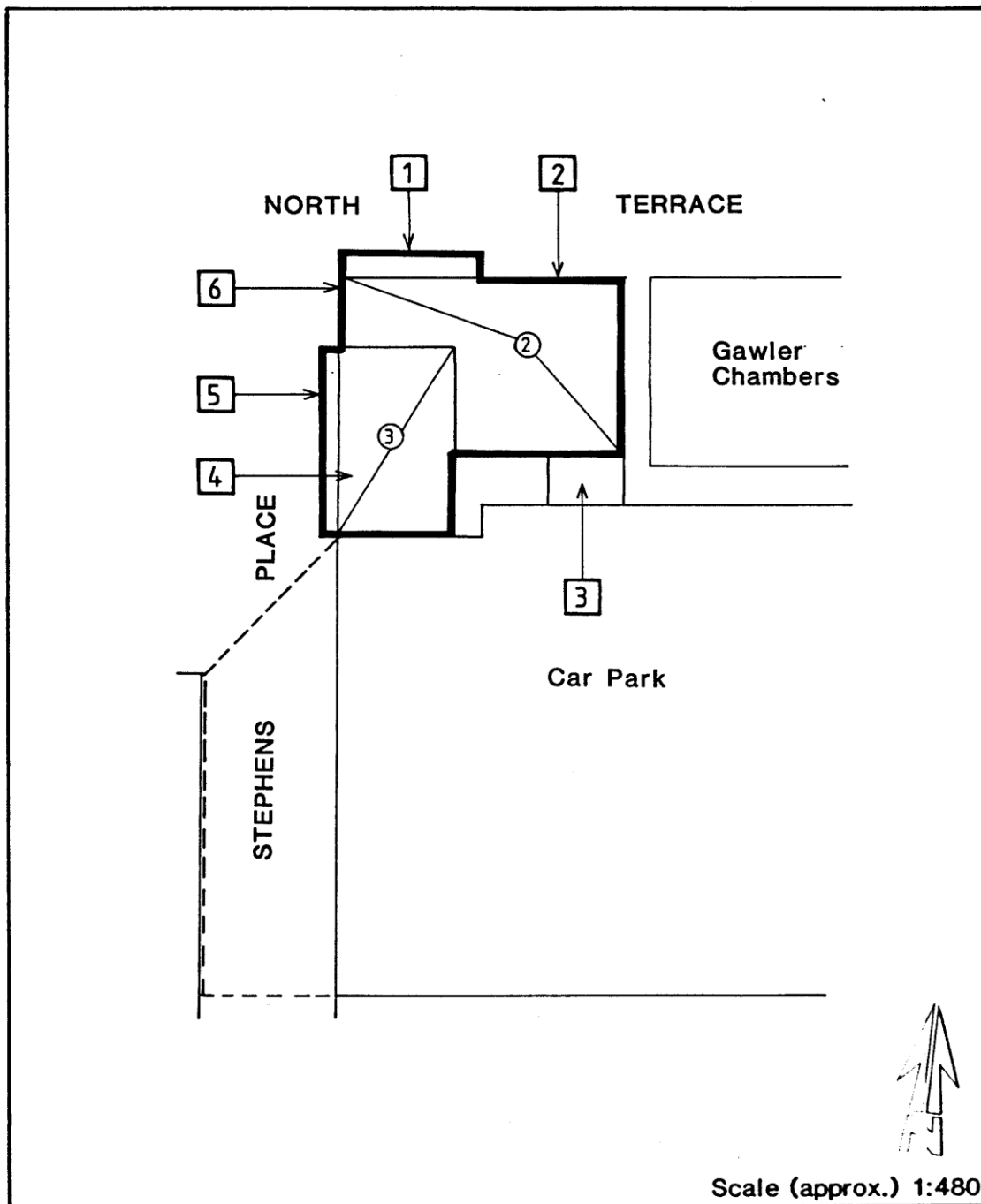

***Image scanned - not to stated scale.***

This Curtilage Map has been prepared as a guide only and no warranty or assurance is given about the accuracy of the content as it may contain obsolete information. The Corporation excludes all liability [including for negligence] in relation to your use of these documents.



# CITY OF ADELAIDE HERITAGE STUDY

## The City Heritage Register - Definition of Items

Prepared by the Dept. of Planning and Development

<b>Item</b>	QUEEN ADELAIDE CLUB	<b>Building No</b>
<b>Address</b>	182-184 North Terrace; 2-6 Stephens Place	3/0201  CT 1376/39

### NOTES:

1. Cantilevered balcony. Note timber joinery.
2. Rendered facade with line jointing. Balustraded parapet.
3. Lean-to.
4. Terra cotta tiled roof and cresting.
5. Cantilevered eaves.
6. Brick construction (Flemish bond) and detailing.