

## THE GALLERIE (Part Former G & R Wills Warehouse)

201-205 North Terrace

The original owner of these substantial warehouses, the merchant firm of G & R Wills, played a large part in the commercial development of South Australia. George Wills established the firm in small premises in Rundle Street and in 1859 opened a 'buying-house' in London. The firm prospered, moving into these premises in 1867, by which time Wills' premises extended from Rundle Street to North Terrace. The firm had a clothing factory in Pulteney Street and a shoe factory in Pirie Street, becoming one of the largest softgoods businesses in South Australia. G & R Wills traded throughout Australia, with branches being established at Broken Hill, Melbourne, Fremantle and Kalgoorlie. The extent of the firm's trade illustrated the extent of South Australian commercial influence in pre-federation Australia.

In 1865 architects Wright Woods & Hamilton were engaged to supervise the erection of a store for G & R Wills at a cost of £2600 by the contractors English and Brown. By February 1867 the cost of construction had risen to £3890, its dimensions then being given as 90 feet by 100 feet with a lofty cellar. The complex was refaced and substantially extended to the design of Daniel Garlick and constructed by Brown and Thompson in the 1870s. By the time of the 1880 Smith Survey the complex had reached its present form. Between 1872 and 1881 the annual rateable value of the complex rose from £220 to £800, reflecting the expansion and prosperity of G & R Wills' operation in Adelaide.



(CD Ref 3974/78)

The present character of the building is marked by the separate nature of the two sections, each, however, being of similar design. This duality is emphasised by the setback of the western structure and the originally symmetrical design of each elevation. Both facades are notable for sandstone ashlar walling and cement dressings. Enrichment to Corinthian pilasters, quoins, string courses, surrounds to openings and

parapets are particularly well executed and remarkably intact. Detailing is derived from Renaissance design elements with Italianate flourishes.

These buildings are important visual elements in the North Terrace streetscape because of their style and detailing. Their contribution is reinforced by the neo-Gothic building immediately to the east. The western half of the buildings is occupied by part of the Galerie (shopping arcade) affecting the integrity of that section but has been sympathetically handled resulting in the preservation of the important facade. The eastern half - until recently

## Heritage of the City of Adelaide

---

occupied by John Martin & Co. Ltd. - is almost original, the interior being notable for its cast-iron column supported flooring.

ACA, Assessments 1867, 1873, 1877, 1881, 1888, 1894, 1906; Burgess, H.T., *Cyclopedia of South Australia*, Vol. 1, 1909, pp. 582-4; Huffadine, H.N., *The hundred years: the story of G. & R. Wills and Co.*, 1949; Jensen, E., & R., *Colonial architecture in South Australia*, 1980, p. 354, 364; MLSA, Historical photographs (Town Acre 21).



(CD Ref 3974/79)

The text in this Information Sheet was copied from the **Heritage of the City of Adelaide: An Illustrated Guide**, (1996). The photographs contained in this Information Sheet are a selection of those held by Heritage Services, in digital format.

The property described in this Information Sheet is included in the Register of State Heritage places. A heritage listing does not mean or imply right of access by the public to such properties.

*The heritage related Principles of Development Control as well as the Precinct specific objectives and Principles of Development Control are contained in the Adelaide (City) Development Plan. These should be referred to in whole when contemplating any development.*

*Further information on the Heritage Incentives Scheme, an initiative of Council to sponsor timely and appropriate conservation action is available upon request of the Customer Service Centre.*



## CITY OF ADELAIDE HERITAGE STUDY

### The City Heritage Register-Definition of Items

Prepared by the Dept. of Planning and Development

Item	Former G. & R. WILLS WAREHOUSE (Part GALLERIE)	Building NO 3/0304
Address	201-202 North Terrace	CT 4176/917

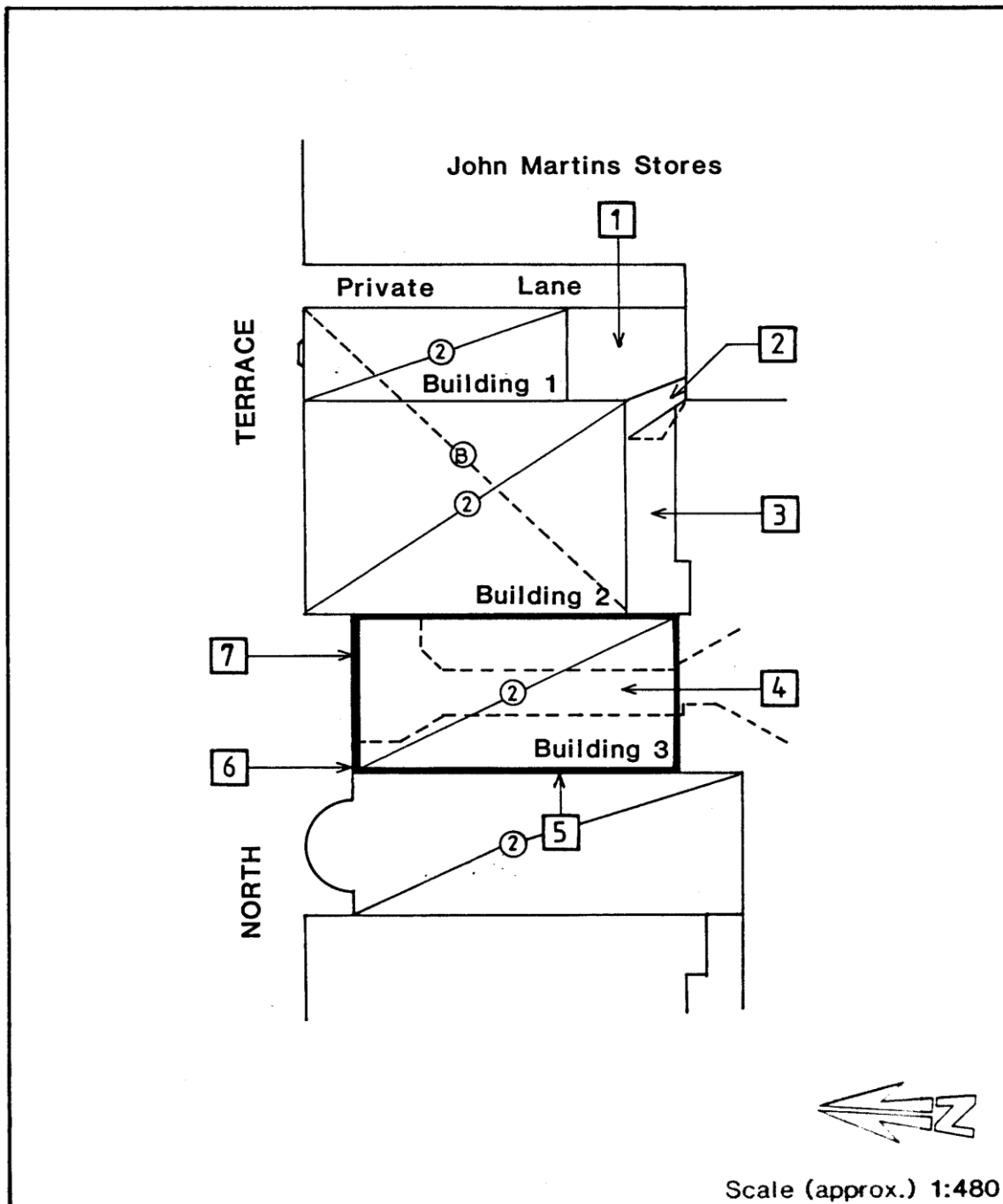

**Image scanned - not to stated scale.**

This Curtilage Map has been prepared as a guide only and no warranty or assurance is given about the accuracy of the content as it may contain obsolete information. The Corporation excludes all liability [including for negligence] in relation to your use of these documents.



## CITY OF ADELAIDE HERITAGE STUDY

### The City Heritage Register-Definition of Items

Prepared by the Dept. of Planning and Development

Item	Former G. & R. WILLS WAREHOUSE (Part GALLERIE)	Building No 3/0304
Address	201-202 North Terrace	CT 4176/917

#### NOTES:

1. J.M. Storage area.
2. Through to John Martins.
3. No access to this area.
4. Gallerie.
5. Bluestone rubble.
6. Note vermiculated quoins.
7. Squared, punch faced sandstone with extensive stucco and bluestone plinth. Fenestration altered at ground floor level. Note balustraded parapet.



## CITY OF ADELAIDE HERITAGE STUDY

### The City Heritage Register-Definition of Items

Prepared by the Dept. of Planning and Development

Item Former G. & R. WILLS WAREHOUSE

Building No  
3/0305

Address 203-205 North Terrace

CT 4182/923

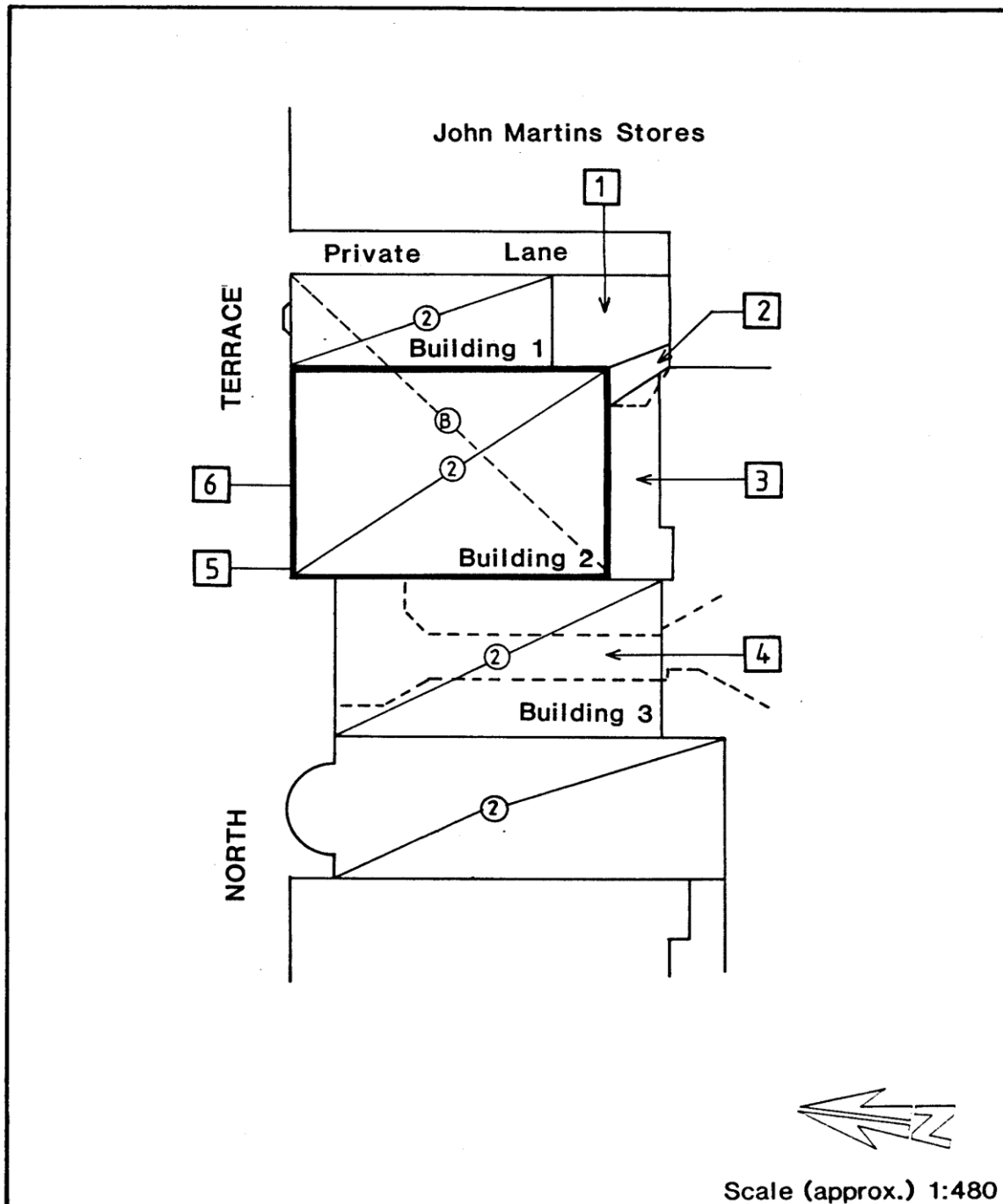

**Image scanned - not to stated scale.**

This Curtilage Map has been prepared as a guide only and no warranty or assurance is given about the accuracy of the content as it may contain obsolete information. The Corporation excludes all liability [including for negligence] in relation to your use of these documents.



## CITY OF ADELAIDE HERITAGE STUDY

### The City Heritage Register-Definition of Items

Prepared by the Dept. of Planning and Development

Item      Former G. & R. WILLS WAREHOUSE

Building No  
3/0305

Address   203-205 North Terrace

CT 4182/923

#### NOTES:

1.    J.M. Storage area.
2.    Through to John Martins.
3.    No access to this area.
4.    Gallerie.
5.    Note vermiculated quoins.
6.    Squared, punch faced sandstone with extensive stucco enrichment and bluestone plinth. Note balustraded parapet.