

ST MARGARET'S HOUSE AND COACH HOUSE

21-25 Brougham Place



(CD Ref 1215/18)

St Margaret's demonstrates the attraction of the 'well-to-do' to Park Lands frontages. It is an important example in the city of the few high quality houses erected when South Australia was entering the depression of the 1890s. Beside the main house there is a former coach house and an impressive paved forecourt off Ward Street.

The complex retains an integrity now rarely found.

The complex was erected in 1889-90 for the financier and developer Arthur Waterhouse. Additions to St Margaret's were carried out in 1899. Arthur Waterhouse, as a notable financier, was involved in many of Adelaide's commercial ventures, among them the rebuilding of the Majestic Theatre (now demolished) and a number of hotels including the General Gordon (now the Griffins Head in Hindmarsh Square).

The buildings are well constructed of Tapley Hill bluestone contrasted with high quality brick dressings. The 'squaring up' of bluestone to form the quoins, is particularly notable. The architect was probably George Klewitz Soward who designed a theatre and carried out hotel alterations



(CD Ref 1215/21)

for Waterhouse. Typically Soward designed in the Gothic manner, St Margaret's displays elements of the Gothic style, particularly in the interior and stairwell.

Heritage of the City of Adelaide

The main house is prominent and impressively sited, a dominant element of the Brougham Place ridge and one which complements the group of buildings to the west, forming Lincoln College. It maintains the two storey residential scale of the area and, due to its corner site and largely original condition, is of great importance to this area of special character. The associated coach house and walling make a significant contribution to the character of Ward Street, while the elevation to Margaret Street is especially attractive.

ACA, Assessments, *Digest of Proceedings* 1888-90; Loyau, G.E., *Notable South Australians*, 1885, p. 129; MLSA, Davies biographical cuttings 23/97, Historical photographs (Town Acre 735).

The text in this Information Sheet was copied from the **Heritage of the City of Adelaide: An Illustrated Guide**, (1996). The photographs contained in this Information Sheet are a selection of those held by Heritage Services, in digital format.

The property described in this Information Sheet is included in the Register of State Heritage places. A heritage listing does not mean or imply right of access by the public to such properties.

The heritage related Principles of Development Control as well as the Precinct specific objectives and Principles of Development Control are contained in the Adelaide (City) Development Plan. These should be referred to in whole when contemplating any development.

Further information on the Heritage Incentives Scheme, an initiative of Council to sponsor timely and appropriate conservation action is available upon request of the Customer Service Centre.



CITY OF ADELAIDE HERITAGE STUDY

The City Heritage Register-Definition of Items

Prepared by the Dept. of Planning and Development

Item	OFFICES (ST. MARGARET'S) AND FORMER STABLES	Building No 34/0201 - 1&2
Address	On land 21-25 Brougham Place, North Adelaide; 2-20 Margaret Street; 41-49 Ward Street	CT 4212/139 & 141

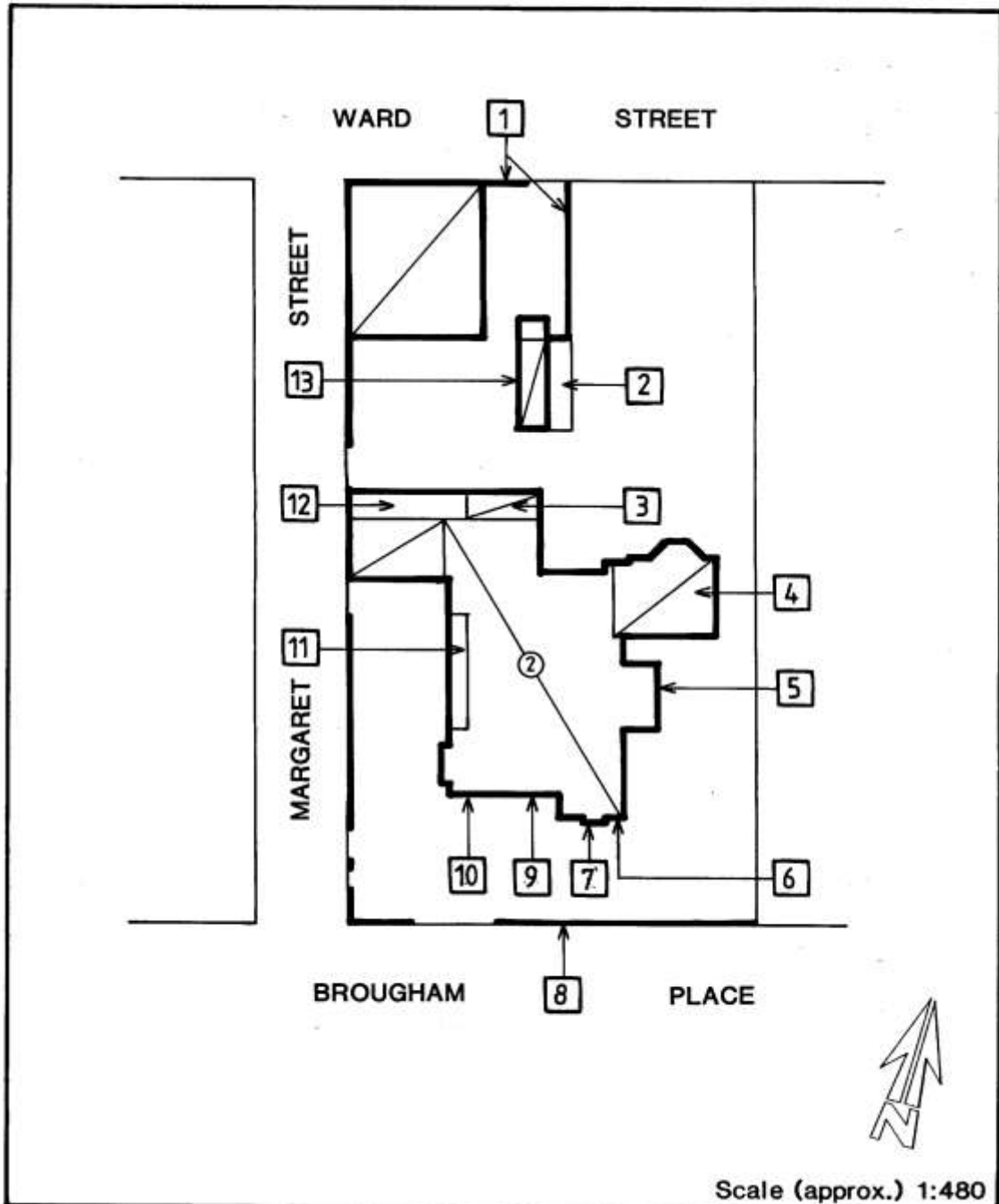

Image scanned - not to stated scale.

This Curtilage Map has been prepared as a guide only and no warranty or assurance is given about the accuracy of the content as it may contain obsolete information. The Corporation excludes all liability [including for negligence] in relation to your use of these documents.



CITY OF ADELAIDE HERITAGE STUDY

The City Heritage Register-Definition of Items

Prepared by the Dept. of Planning and Development

Item	OFFICES (ST. MARGARET'S) AND FORMER STABLES	Building No 34/0201 - 1&2
Address	On land 21-25 Brougham Place, North Adelaide; 2-20 Margaret Street; 41-49 Ward Street	CT 4212/139 & 141

NOTES:

1. Coursed, squared bluestone with brick detailing.
2. Timber addition.
3. Timber verandah.
4. Brick (English Bond) addition.
5. Half timbered, coarsely rendered facade.
6. Coursed squared bluestone with brick quoins and detailing.
7. Oriel window.
8. Bluestone and brick wall.
9. Note: Elaborate brick entry.
10. Note: Moulded brick string courses and hooded moulding.
11. Note: Timber joinery on verandah/balcony.
12. Verandah enclosed.
13. Brick (Flemish Bond).