

HOUSE

225-226 Brougham Place



(CD Ref 1721/59)

The house is of the typical North Adelaide constructional vernacular with limestone rubble walling and slate roof. The quoins and blocked surrounds to windows and front entrance lend a robust, semi-Georgian flavour to the house which is emphasised by its totally symmetrical appearance. Apart from the replacement porch the building presents an original appearance to Brougham Place and is part of its prevailing character. This line of houses leading up to the Uniting church is of an age and scale which greatly contributes to the townscape.

The plan form of the house, like others in the area, is set into the Torrens Valley embankment, presenting an apparently single storey frontage to Brougham Place and a two storey section at the rear. The gabled addition at the rear is shown on the Smith Survey of the city of 1880 and was probably erected in the 1870s.



(CD Ref 2014/4)

Heritage of the City of Adelaide

In 1860 James Peek, a builder by trade, purchased the property for £40, selling it in 1863 to trustees of the Baptist mission for £500. This house was probably built by Peek. The Baptist trustees in turn leased the property to the Reverend George Stonehouse between 1863 and 1869.

Stonehouse was born in Kent in 1808, the third of a family line of Baptist ministers. He was encouraged to move to South Australia by George Fife Angas. From 1845 to about 1848 he lived at Angaston, then took charge of the Salem chapel in Kermode Street, and then of the chapel in Lefevre Terrace where he officiated for about eighteen years. He later established a Baptist college in Adelaide, occupying the position of principal tutor until his death in 1871.

ACA, Assessments 1861-64; Morgan, E.J.R., & Gilbert, S.H., *Early Adelaide architecture 1836 to 1886*, 1969, pp. 114-15; *South Australian Register*, 12 August 1871.

The text in this Information Sheet was copied from the **Heritage of the City of Adelaide: An Illustrated Guide**, (1996). The photographs contained in this Information Sheet are a selection of those held by Heritage Services, in digital format.

The property described in this Information Sheet is included in the Register of State Heritage places. A heritage listing does not mean or imply right of access by the public to such properties.

The heritage related Principles of Development Control as well as the Precinct specific objectives and Principles of Development Control are contained in the Adelaide (City) Development Plan. These should be referred to in whole when contemplating any development.

Further information on the Heritage Incentives Scheme, an initiative of Council to sponsor timely and appropriate conservation action is available upon request of the Customer Service Centre.



CITY OF ADELAIDE HERITAGE STUDY

The City Heritage Register - Definition of Items

Prepared by the Dept. of Planning and Development

Item	HOUSE	Building No	36/2103-1
Address	225-226 Brougham Place, North Adelaide, 100-102 Old Street	CT	4272/38

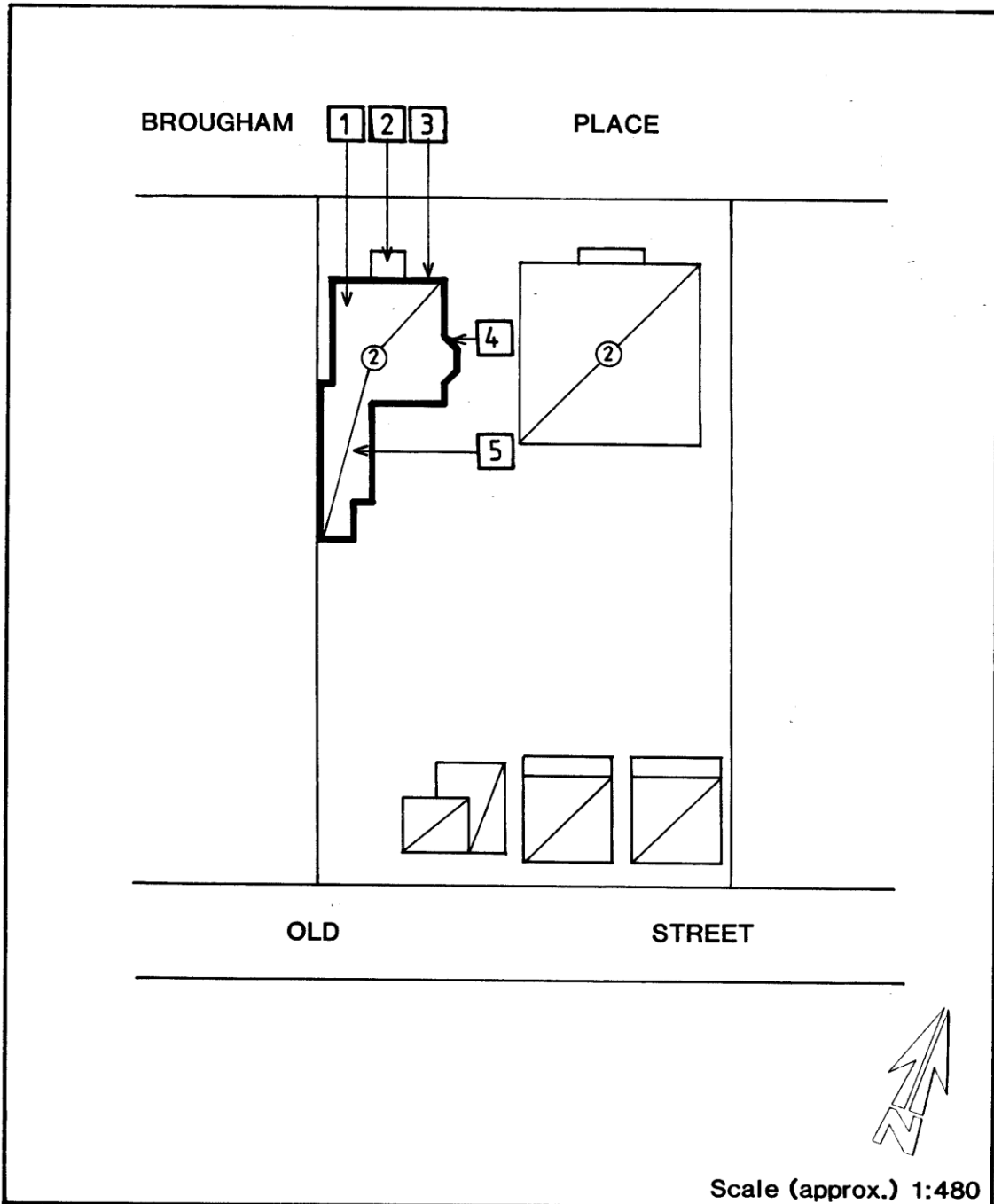

Image scanned - not to stated scale.

This Curtilage Map has been prepared as a guide only and no warranty or assurance is given about the accuracy of the content as it may contain obsolete information. The Corporation excludes all liability [including for negligence] in relation to your use of these documents.



CITY OF ADELAIDE HERITAGE STUDY

The City Heritage Register-Definition of Items

Prepared by the Dept. of Planning and Development

Item	HOUSE	Building No
Address	225-226 Brougham Place, North Adelaide, 100-102 Old Street	36/2103-1 CT 4272/38

NOTES:

1. Slate roof.
2. Portico.
3. Limestone rubble with stucco enrichment.
4. Bay window with metal roofing.
5. Early addition of limestone rubble with brick quoins.