

GREEN DRAGON HOTEL

236-240 South Terrace

There has been a Green Dragon Hotel on this prominent site since 1858, once serving the teamsters and carriers entering the city. The Dragon Brewery, now demolished, was to the west, operating until about 1910.



(CD Ref 1347/73)

The Green Dragon Hotel was built in 1858 for John Mitten as a public house of eight rooms with stables and stock yards of assessed value £110. Mitten died soon after completing the hotel, leaving it to his nine year old niece, Mary Cant. Little change was made to the building's fabric, but a weighbridge was constructed on the hotel premises around 1864. In the early 1860s the City Council passed a by-law requiring all wood, bark, hay, straw and coals coming into the city for sale to be weighed and certified by a licensed weighbridge. Hotels sited at such 'gateways' into the city were the Stag, close to the East End Market; the Elephant and Castle, on West Terrace near the south-western entry to the city; the Princess Royal in O'Connell Street (rebuilt in 1884 as the Oxford Hotel); and the Green Dragon Hotel on South Terrace.

Plans for the first addition to the hotel were passed in 1882. A two storey northern extension was erected in 1891 and a two storey north-western rear extension was added in 1898, with modifications in 1908. A balcony was added in 1924 and the



(CD Ref 1347/75)

Heritage of the City of Adelaide

weighbridge removed. In 1940 a single storey western addition and extensive upgrading was undertaken.

Despite all these additions, the hotel, with its chamfered corner form, parapet concealing the roof and its paned double hung sash windows to the first floor, retains a major proportion of the 1858 building.

ACA, Assessments; Harry, B. and Associates, *The Green Dragon conservation study*, 1987; Hoad, J.L., *Hotels and publicans in South Australia 1836-1984*, 1986, part 3, p. 264; *Illustrated Sydney News*, July 1876, etching of Adelaide, A.C. Cooke and J. Calvert; MLSA, Historical photographs (Town Acre 677); *Pictorial Australian*, July 1892 (supplement), etching of Adelaide by A.C. Cooke and J. Bruer; State Heritage Branch, Register objection report, 11 June 1986, item no. 6628-13108.

The text in this Information Sheet was copied from the **Heritage of the City of Adelaide: An Illustrated Guide**, (1996). The photographs contained in this Information Sheet are a selection of those held by Heritage Services, in digital format.

The property described in this Information Sheet is included in the Register of State Heritage places. A heritage listing does not mean or imply right of access by the public to such properties.

The heritage related Principles of Development Control as well as the Precinct specific objectives and Principles of Development Control are contained in the Adelaide (City) Development Plan. These should be referred to in whole when contemplating any development.

Further information on the Heritage Incentives Scheme, an initiative of Council to sponsor timely and appropriate conservation action is available upon request of the Customer Service Centre.



CITY OF ADELAIDE HERITAGE STUDY

The City Heritage Register-Definition of Items

Prepared by the Dept. of Planning and Development

Item	GREEN DRAGON HOTEL	Building No
Address	236-240 South Terrace; 471-479 Pulteney Street	21/2706
		CT 3731/157

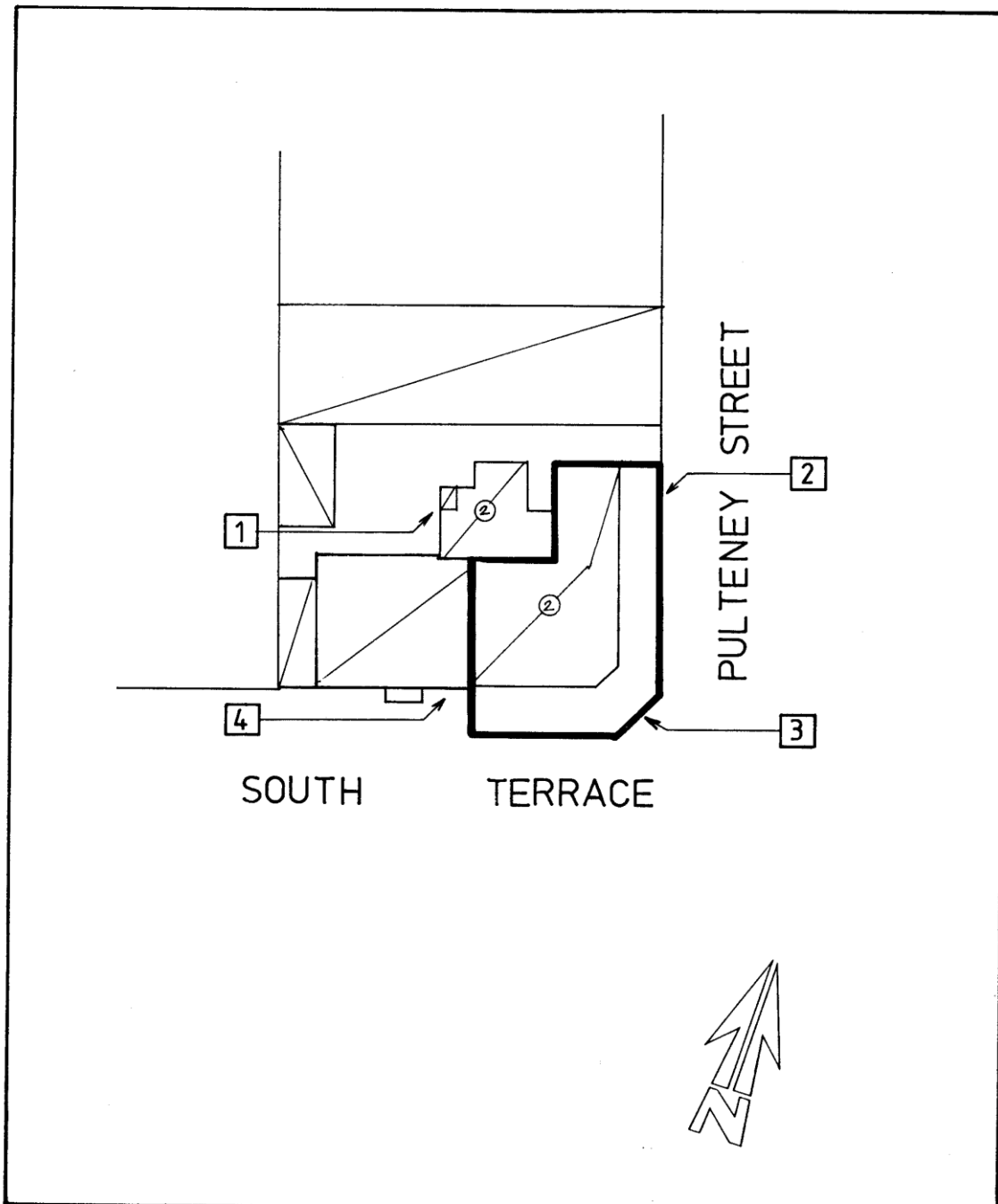

Image scanned - not to stated scale.

This Curtilage Map has been prepared as a guide only and no warranty or assurance is given about the accuracy of the content as it may contain obsolete information. The Corporation excludes all liability [including for negligence] in relation to your use of these documents.



CITY OF ADELAIDE HERITAGE STUDY

The City Heritage Register-Definition of Items

Prepared by the Dept. of Planning and Development

Item	GREEN DRAGON HOTEL	Building No 21/2706
Address	236-240 South Terrace; 471-479 Pulteney Street	CT 3731/157

NOTES:

1. Accretions at rear.
2. Addition of consistent design.
3. Substantial verandah/balcony.
4. Addition of 1930's design.