

EXETER HOTEL

246-248 Rundle Street

This hotel was rebuilt in 1888 on the site of a former two storey hotel which was first licensed in 1851. It is believed that it was possibly rebuilt because of competition with the nearby Tavistock Hotel which was rebuilt in the early 1880s.

The design is typical of many commercial structures in the city with chamfered corner and two storey form, highlighted by the veranda/balcony. The hotel has an original external appearance and quality, construction of coursed squared bush-hammered sandstone, with the original openings even on the ground floor (often these have been 'fashionably' altered in other hotels). The stuccoed detail is restricted to the first floor where surrounds to openings are particularly elaborate.

Most importantly, the Exeter Hotel reinforces the dominant character, scale and style of development in this end of Rundle Street.

ACA, Assessments, *Digest of Proceedings*, 17 October 1887, Smith Survey 1880, fieldbook, No. 10, p. 53; MLSA, Historical photographs (Town Acre 34).

The text in this Information Sheet was copied from the **Heritage of the City of Adelaide: An Illustrated Guide**, (1996). The photographs contained in this Information Sheet are a selection of those held by Heritage Services, in digital format.

The property described in this Information Sheet is a place of Local Heritage (City Significance). A heritage listing does not mean or imply right of access by the public to such properties.

The heritage related Principles of Development Control as well as the Precinct specific objectives and Principles of Development Control are contained in the Adelaide (City) Development Plan. These should be referred to in whole when contemplating any development.

Further information on the Heritage Incentives Scheme, an initiative of Council to sponsor timely and appropriate conservation action is available upon request of the Customer Service Centre.



CITY OF ADELAIDE HERITAGE STUDY

The City Heritage Register-Definition of Items

Prepared by the Dept. of Planning and Development

Item	EXETER HOTEL	Building No 4/0211
Address	246-248 Rundle Street	CT 4144/751

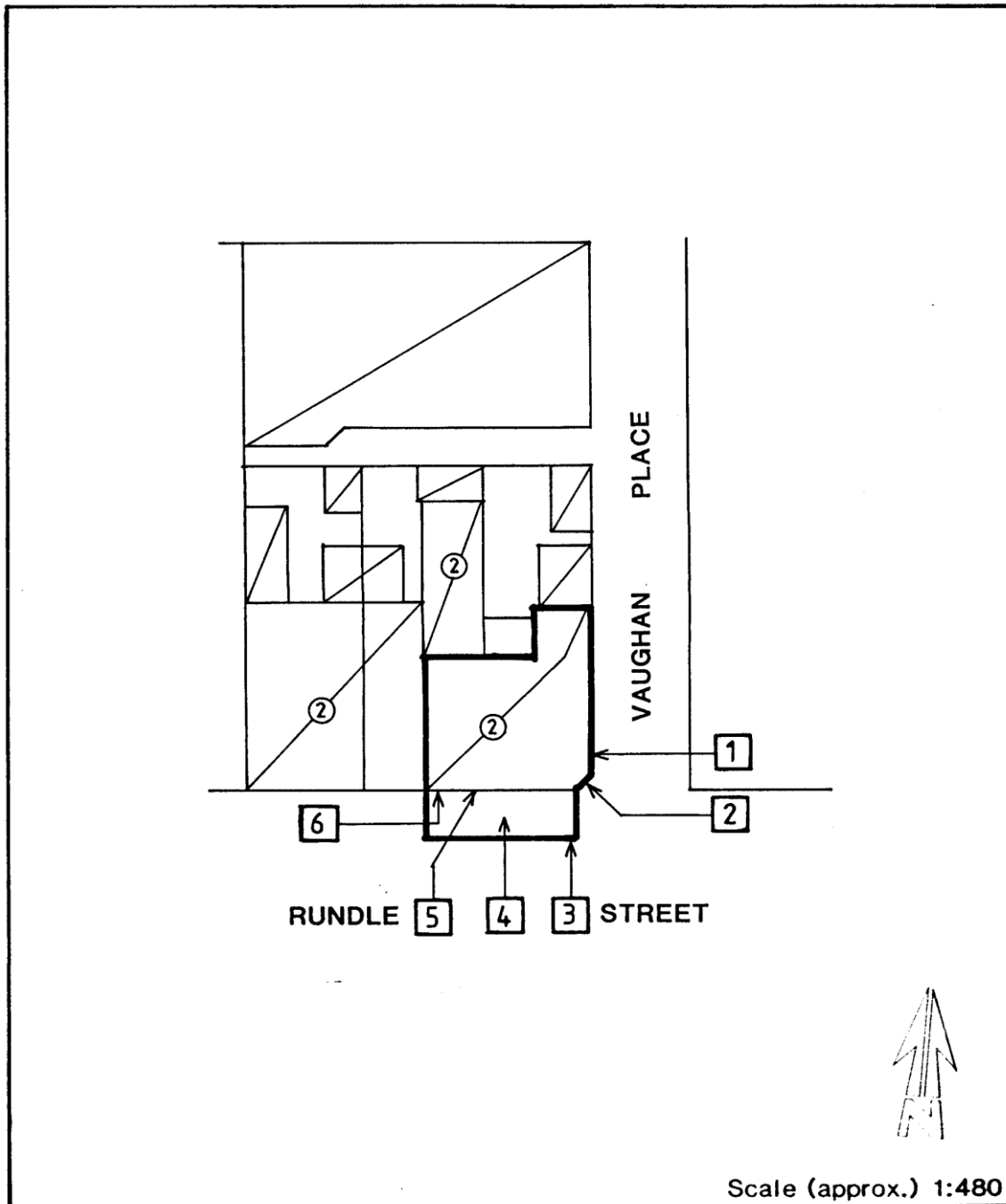

Scale (approx.) 1:480

Image scanned - not to stated scale.

This Curtilage Map has been prepared as a guide only and no warranty or assurance is given about the accuracy of the content as it may contain obsolete information. The Corporation excludes all liability [including for negligence] in relation to your use of these documents.



CITY OF ADELAIDE HERITAGE STUDY

The City Heritage Register-Definition of Items

Prepared by the Dept. of Planning and Development

Item	EXETER HOTEL	Building No 4/0211
Address	246-248 Rundle Street	CT 4144/751

NOTES:

1. Main body of building.
2. Note Original ground floor.
3. Note Cast Iron Balustrading frieze and columns.
4. Verandah/balcony.
5. Squared purnch faced sandstone with stucco enrichment and rusticated quoins.
6. Note Balustraded parapet with name plate.