

HOUSE

261-262 North Terrace

This imposing building is one of the few survivors of the fashionable homes which once graced North Terrace.

In about 1881 two small dwellings on this plot were demolished to make way for a more imposing residence, the rateable annual value increasing from £22 in November 1880, to £100 a year later, and to £175 in 1882, indicating the house was completed. Thomas Greaves Waterhouse who commissioned the building was a successful businessman who owned the Black Bull Hotel (the Princes Berkely) in Hindley Street.

The design of the house is attributed to the architect William McMinn. During the likely construction period no other large residences with an annual assessed value of over £90 were built on North Terrace. McMinn placed tender notices for 'building a residence on North Terrace' in the *South Australian Register* during that time, so it seems probable he did design the house.



(CD Ref 3974/39)

Several notable South Australians occupied the house. Sir William Milne (1822-95) took out a three year lease on the property. Milne was a wine and spirit merchant, politician, director and chairman of the Wallaroo and Moonta Mining and Smelting Co., and a trustee of the Savings Bank. He was appointed a knight of the realm in 1876.

In 1906 the residence was bought by Adelaide architect Walter Hervey Bagot and remained within the Bagot family until 1926. Bagot was a prominent early twentieth century Adelaide architect. Two buildings which reflect his preference for classical and traditional design are the Bonython Hall and the Barr Smith Library at the University of Adelaide on the opposite side of North Terrace.

The building also served as professional rooms for several medical practitioners, such as Dr J.A.G. Hamilton, Dr C.V. Wells and the well known Chinese specialist Dr Lum Yow.

The building was a guest-house between 1927 and the 1940s. In 1953 the Chamber of Manufactures Insurance Limited bought and extensively remodelled the building to house the Chamil Surgical and Physiotherapy Clinic for treatment of injured workmen employed by policy holders of the company. The premises were later used once more as a doctor's

Heritage of the City of Adelaide

professional rooms until the present owners purchased the property and restored it as a private home.



(CD Ref 3964/69)



(CD Ref 3974/38)

The building is of architectural interest because of the high quality of detailing to both the North Terrace and western elevations. The surrounds to openings are well finished, with a variety of stucco ornamentation including foliated capitals and spandrel decoration. The design has been marred by the removal of a balcony, but the imposing mansard roof with its slate cladding, the widow's walk and parapet survive intact. Morgan and Gilbert commented in *Early Adelaide architecture*, that the design ' . . . although elaborate is well scaled to so small a house'.

ACA, Assessments, Smith Survey 1880; *Australian dictionary of biography*, Vol. 5, (1974) p. 255, Vol. 7, 1979, p. 133; MLSA, Historical photographs, (Gall Collection); Michell, R., Research notes; Morgan, E.J.R., & Gilbert, S.H., *Early Adelaide architecture 1836 to 1886*, 1969, p. 21; *South Australian Register*, 15 January 1881, 10 April 1881.

The text in this Information Sheet was copied from the **Heritage of the City of Adelaide: An Illustrated Guide**, (1996). The photographs contained in this Information Sheet are a selection of those held by Heritage Services, in digital format.

Heritage of the City of Adelaide

The property described in this Information Sheet is included in the Register of State Heritage places. A heritage listing does not mean or imply right of access by the public to such properties.

The heritage related Principles of Development Control as well as the Precinct specific objectives and Principles of Development Control are contained in the Adelaide (City) Development Plan. These should be referred to in whole when contemplating any development.

Further information on the Heritage Incentives Scheme, an initiative of Council to sponsor timely and appropriate conservation action is available upon request of the Customer Service Centre.



CITY OF ADELAIDE HERITAGE STUDY

The City Heritage Register - Definition of Items

Prepared by the Dept. of Planning and Development

Item	HOUSE	Building No	4/0105-1
Address	261-262 North Terrace	CT	2179/47

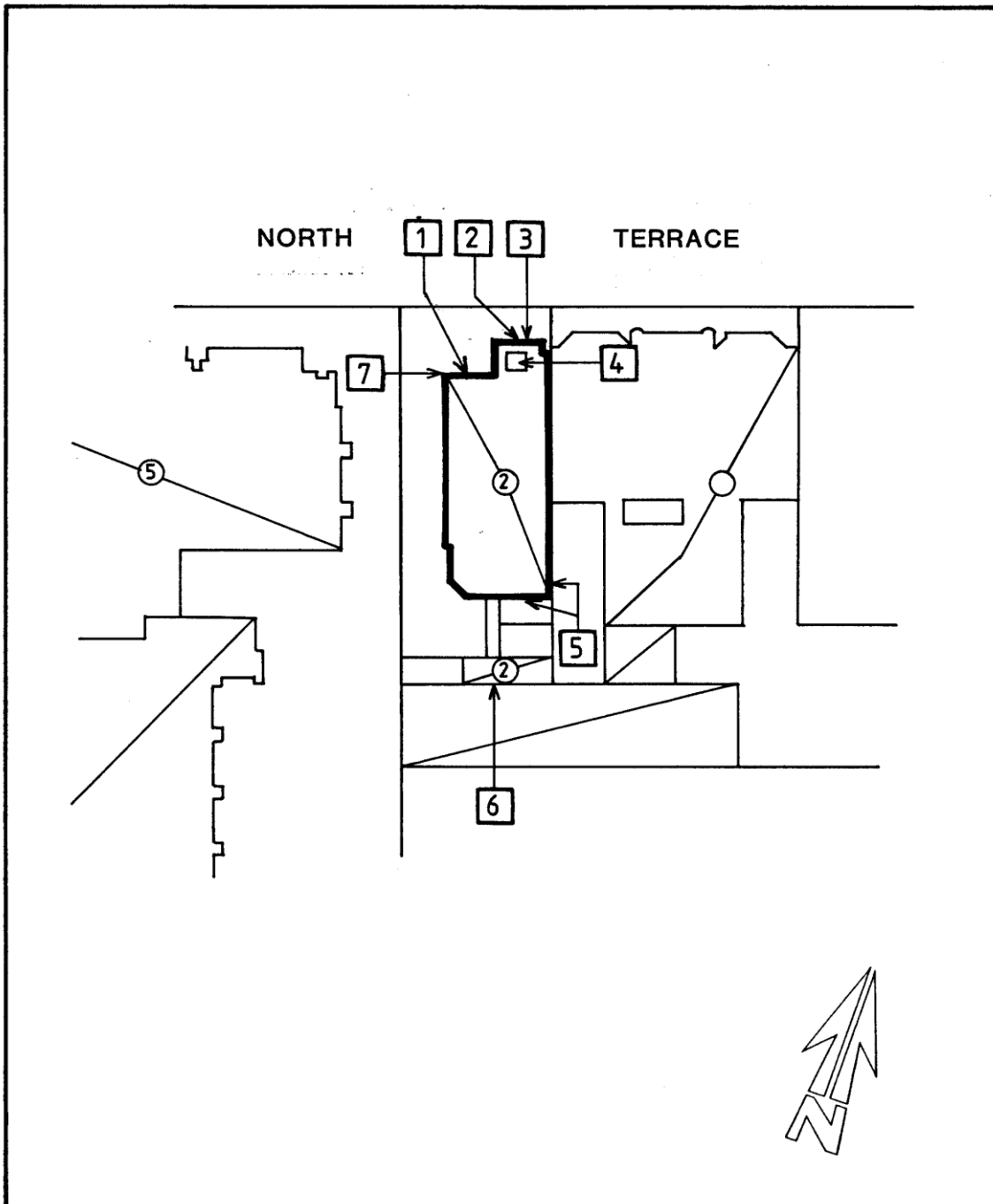

Image scanned - not to stated scale.

This Curtilage Map has been prepared as a guide only and no warranty or assurance is given about the accuracy of the content as it may contain obsolete information. The Corporation excludes all liability [including for negligence] in relation to your use of these documents.



CITY OF ADELAIDE HERITAGE STUDY

The City Heritage Register-Definition of Items

Prepared by the Dept. of Planning and Development

Item	HOUSE	Building No 4/0105-1
Address	261-262 North Terrace	CT 2179/47

NOTES:

1. Rebuilt sandstone front wall.
2. Hammered ashlar sandstone with stuccoed enrichment.
3. Facade rendered at ground floor level.
4. Dormer window, slate widows walk, mansard roof, metal cresting.
5. Rear elevations brick.
6. Brick additions.
7. Vermiculated quoins.