

HOUSES AND FORMER SHOP

302-308 Carrington Street



(CD Ref 1343/74)

The eastern property, comprising an attached house was erected for James White in the early 1880s. It is constructed of substantial bluestone walling and has distinctive iron chimney pots. The adjoining semidetached houses, with cantilevered balconies, were erected by A.G. Chapman also in the early 1880s.

Alfred George Chapman became well-known as a builder and contractor in the 1870s. He was born in London in 1834 and migrated to South Australia in his twentieth year, starting in Adelaide as a carpenter. He was the first carpenter to be employed by the Railway Department and was one of the party who assisted Charles Todd in his earliest enterprise - the first government telegraph line to Port Adelaide in 1856. Soon after this Chapman started his own business as a builder and contractor.

The best surviving example of Chapman's workmanship is the Crown & Sceptre Hotel in King William Street. He also built several additions on to public buildings, notably the servants quarters at Government House in 1869, alterations to the Legislative Council in 1874 and the Supreme Court in 1875.

James White was also a successful tradesman as a galvanised-iron worker, plumber and gasfitter. White and Chapman were well acquainted as they both worked at one time for plumbers, Gray and Co., after which White opened his own premises in Carrington Street. He

Heritage of the City of Adelaide

worked on a number of large government contracts including schools and the Adelaide Children's Hospital, as well as commercial buildings.

ACA, Assessments; Burgess, H.T., *Cyclopedia of South Australia*, Vol. 2, 1909, p. 253; *Chronicle*, 7 February 1914; Jensen, E., & R., *Colonial architecture in South Australia*, 1980, pp. 354, 372, 429, 458, 461, 466, 467, 468, 471, 605, 606; MLSA, Historical photographs (Town Acre 437); *Observer*, 7 February 1914.

The text in this Information Sheet was copied from the **Heritage of the City of Adelaide: An Illustrated Guide**, (1996). The photographs contained in this Information Sheet are a selection of those held by Heritage Services, in digital format.

The property described in this Information Sheet is included in the Register of State Heritage places. A heritage listing does not mean or imply right of access by the public to such properties.

The heritage related Principles of Development Control as well as the Precinct specific objectives and Principles of Development Control are contained in the Adelaide (City) Development Plan. These should be referred to in whole when contemplating any development.

Further information on the Heritage Incentives Scheme, an initiative of Council to sponsor timely and appropriate conservation action is available upon request of the Customer Service Centre.



CITY OF ADELAIDE HERITAGE STUDY

The City Heritage Register-Definition of Items

Prepared by the Dept. of Planning and Development

Item	HOUSES AND SHOPS	Building No	17/0713 & 17/0711.1
Address	302-304 and 306-308 Carrington Street	CT	4066/174 & 175 2057/121 & 122

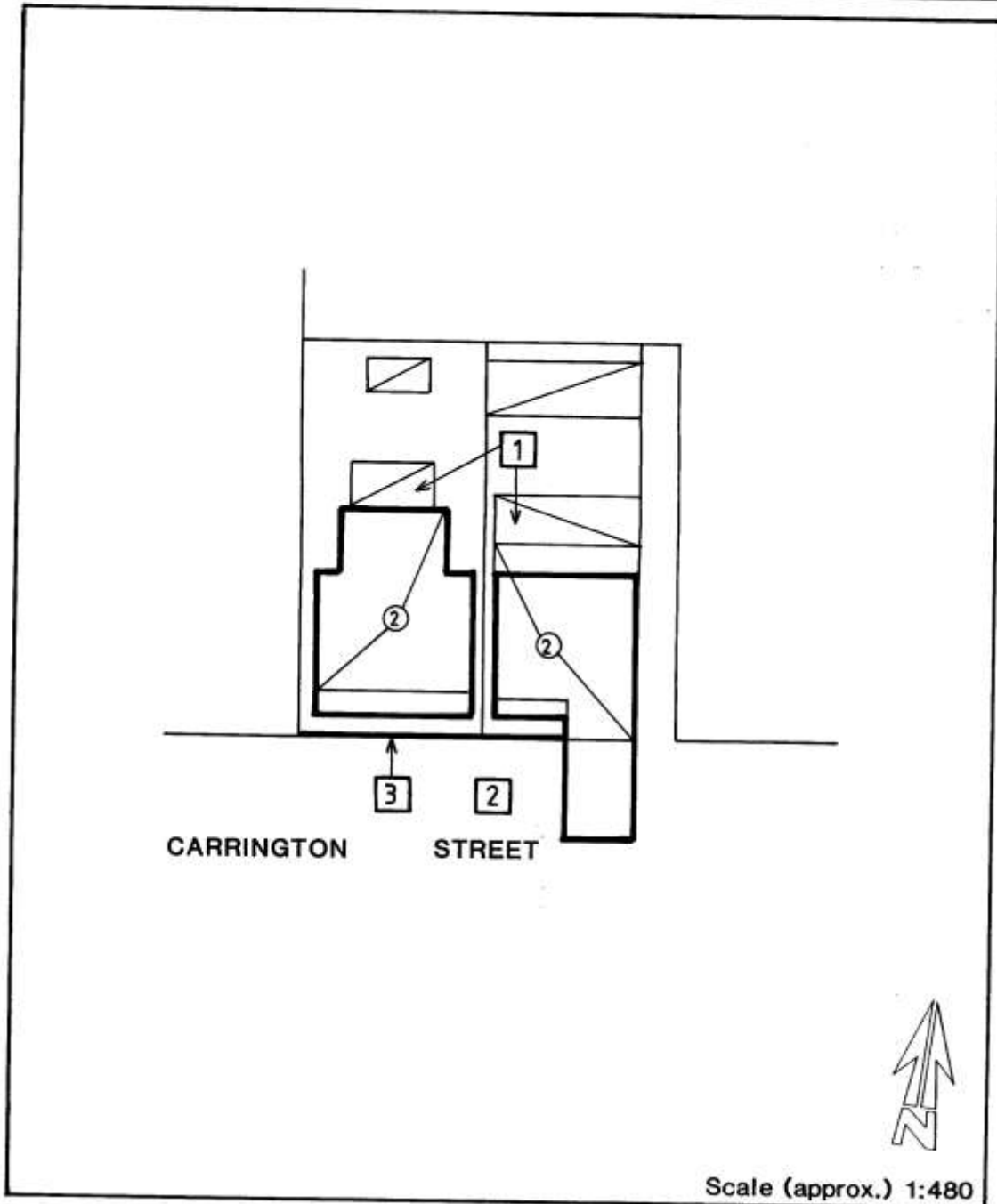

Image scanned - not to stated scale.

This Curtilage Map has been prepared as a guide only and no warranty or assurance is given about the accuracy of the content as it may contain obsolete information. The Corporation excludes all liability [including for negligence] in relation to your use of these documents.



CITY OF ADELAIDE HERITAGE STUDY

The City Heritage Register-Definition of Items

Prepared by the Dept. of Planning and Development

Item	HOUSES AND SHOPS	Building N ^o
Address	302-304 and 306-308 Carrington Street	17/0713 & 17/0711.1 CT 4066/174 & 175 CT 2057/121 & 122

NOTES:

1. Additions.
2. Note: Iron chimney tops.
3. Masonry wall and railings, although not original, included in curtilage.