

## WELLINGTON HOTEL

34-38 Wellington Square

The first owner of the Wellington Hotel, not the present building, was Edwin Cox, a carrier, who bought the land in 1848, licensed a hotel in 1851, and named it the Duke of Wellington.

In 1876 the hotel was sold to the brewing company of Haussen & Co. and remained in their ownership for well over a hundred years. This brewery was set up by E.J.F. Crawford in 1843 as the Hindmarsh Brewery. In 1868 the name changed to become Haussen & Catchlove, and six years later when the Botting family bought the business became Haussen & Co. The company changed the hotel's name to the Wellington Inn and in 1884 engaged the architects Bayer and Withall to design a new building.

A tender ' . . . for the rebuilding of the Wellington Inn, Wellington Square, North Adelaide' appeared in the *South Australian Register*, 1 October 1884. This was carried out in 1885 and in November of 1886 the hotel's rateable value was increased from £90 to £120.



(CD Ref 2016/33)

The Wellington Hotel is typical of many of Adelaide's hostleries of the time, but is important due to its high level of detailing and the relatively original state of the major facades. The cantilevered balcony is unusual for its timber detailing rather than the cast-iron embellishment of hotels of the earlier boom period. Veranda brackets reminiscent of Chinese Chippendale

style, as well as the crisp label moulds, are distinctive. The hotel is an important visual element in Wellington Square and is enhanced by its corner siting.

ACA, Assessments, Smith Survey 1880; GRO, Book 13, folio 187 (Edwin Cox); Hoad, J.L., *Hotels and publicans in South Australia 1836-1984*, 1986, part 3, p. 665; Jensen, E., & R., *Colonial architecture in South Australia*, 1980, p. 153; PRO, Miscellaneous newspaper cuttings, 1339/68/26.5.1936; *South Australian Register*, 1 October 1884; Ward, M.H., Some brief records of brewing in South Australia, 1950, pp. 7-8.

## Heritage of the City of Adelaide

---

The text in this Information Sheet was copied from the **Heritage of the City of Adelaide: *An Illustrated Guide***, (1996). The photographs contained in this Information Sheet are a selection of those held by Heritage Services, in digital format.

The property described in this Information Sheet is included in the Register of State Heritage places. A heritage listing does not mean or imply right of access by the public to such properties.

*The heritage related Principles of Development Control as well as the Precinct specific objectives and Principles of Development Control are contained in the Adelaide (City) Development Plan. These should be referred to in whole when contemplating any development.*

*Further information on the Heritage Incentives Scheme, an initiative of Council to sponsor timely and appropriate conservation action is available upon request of the Customer Service Centre.*



# CITY OF ADELAIDE HERITAGE STUDY

## The City Heritage Register-Definition of Items

Prepared by the Dept. of Planning and Development

Item	WELLINGTON HOTEL	Building No	30/2024
Address	34-38 Wellington Square, North Adelaide	CT	3506/106

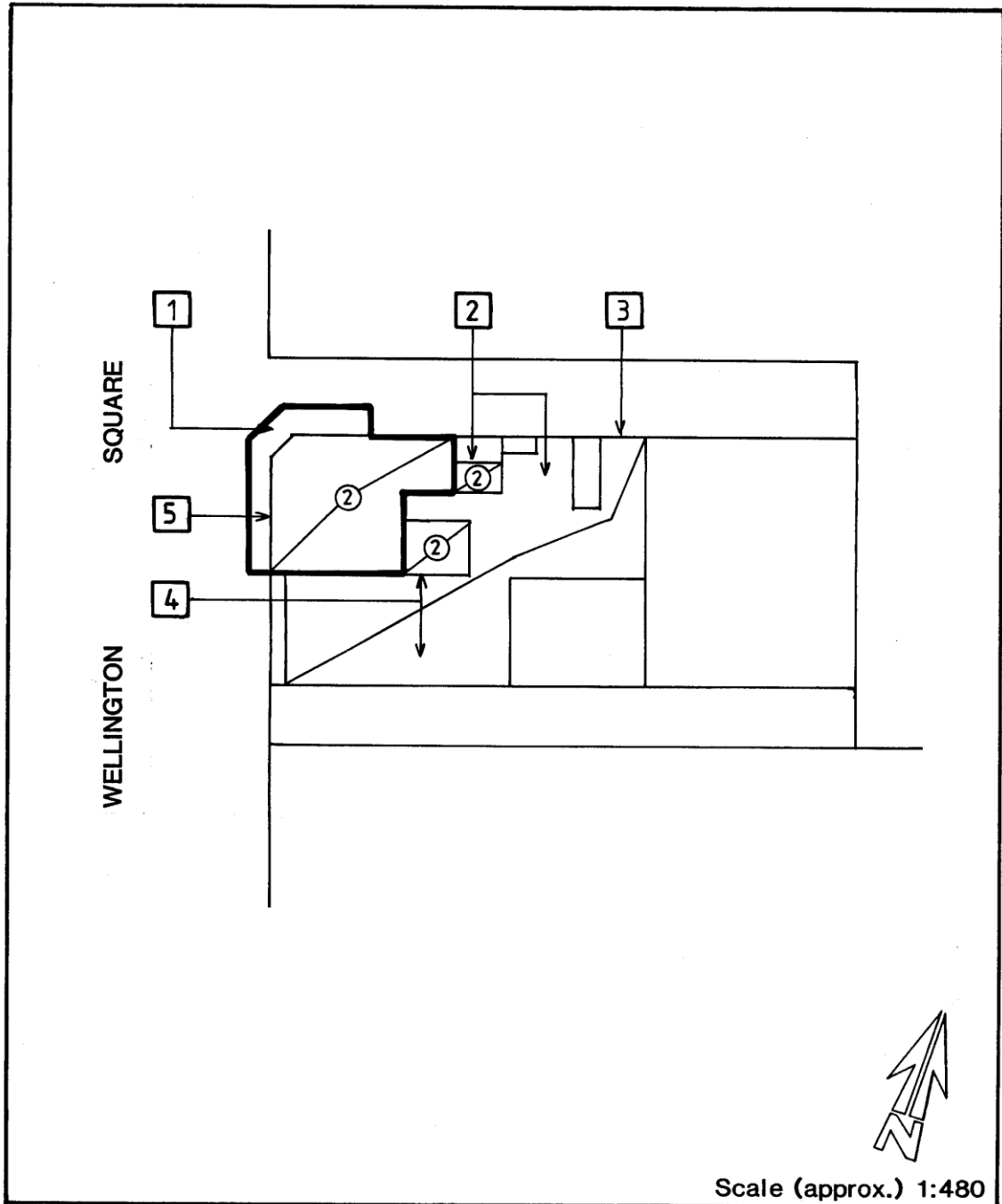

***Image scanned - not to stated scale.***

This Curtilage Map has been prepared as a guide only and no warranty or assurance is given about the accuracy of the content as it may contain obsolete information. The Corporation excludes all liability [including for negligence] in relation to your use of these documents.



# CITY OF ADELAIDE HERITAGE STUDY

## The City Heritage Register-Definition of Items

Prepared by the Dept. of Planning and Development

Item	WELLINGTON HOTEL	Building No
		30/2024
Address	34-38 Wellington Square, North Adelaide	CT 3506/106

### NOTES:

1. Cantilevered balcony with extensive timber detailing.
2. Brick additions.
3. Limestone rubble.
4. Concrete block additions.
5. Coursed random bluestone with stucco enrichment.