

FORMER HOUSES (PART OF LINCOLN COLLEGE)

35-37 Brougham Place



(CD Ref 1215/51)

These semidetached former houses were among the several grand residences built during the redevelopment of Brougham and Palmer places at the turn of the century.

The site was purchased by accountant Walter Edwin Dalton in 1896, plans for the houses being approved by Council in December 1896. The property passed to H. Dalton and J. Counsell in 1914. W.E. Dalton was born in Adelaide in 1855 and served with Price Maurice before starting his own business. In

1895 he joined James Counsell to form the company of Dalton and Counsell. Dalton acted as auditor for the Adelaide Steamship Company, the South Australian Gas Company, the Executor Trustee and Agency Company, and others. Dalton's success in the partnership was reflected in the construction of this substantial double residence in one of Adelaide's most prestigious locations. Built to be rented out to the well-to-do, the houses were occupied by such people as F.A. Lakeman of James Marshall and Co. between about 1908 and 1930. Several doctors also occupied one of the Dalton residences for a period.

In 1952 the two houses were bought by Lincoln College which was first established in the Milne property in Brougham Place then consolidated by the purchase of several other substantial properties adjacent.

The semidetached former residences comprise an important variation of the traditional suburban villa of the period. The duality and the strongly axial layout were originally obscured by a substantial veranda/balcony, now unfortunately removed. The roof form is typically broken by gables and gabled projections. The stuccoed enrichment to squared sandstone walling is remarkably crisp.

The building is complemented by a masonry boundary wall with piers and cast-iron railings.

It is an important element of the character of Brougham Place which retains a predominance of large residences of similar scale.

ACA, Assessments, *Digest of Proceedings*, 17 Dec 1896; Burgess, H.T., *Cyclopedia of South Australia*, Vol. 1, 1909, pp. 554-5; MLSA, Historical photographs (Town Acre 736); Shearer, C., *Lincoln College, the first twenty-five years, 1952-1976*.

Heritage of the City of Adelaide

The text in this Information Sheet was copied from the **Heritage of the City of Adelaide: *An Illustrated Guide***, (1996). The photographs contained in this Information Sheet are a selection of those held by Heritage Services, in digital format.

The property described in this Information Sheet is included in the Register of State Heritage places.
A heritage listing does not mean or imply right of access by the public to such properties.

The heritage related Principles of Development Control as well as the Precinct specific objectives and Principles of Development Control are contained in the Adelaide (City) Development Plan. These should be referred to in whole when contemplating any development.

Further information on the Heritage Incentives Scheme, an initiative of Council to sponsor timely and appropriate conservation action is available upon request of the Customer Service Centre.



CITY OF ADELAIDE HERITAGE STUDY

The City Heritage Register-Definition of Items

Prepared by the Dept. of Planning and Development

Item	HOUSE (PART LINCOLN COLLEGE)	Building No	34/0107-2
Address	35-37 Brougham Place, North Adelaide	CT	2755/181

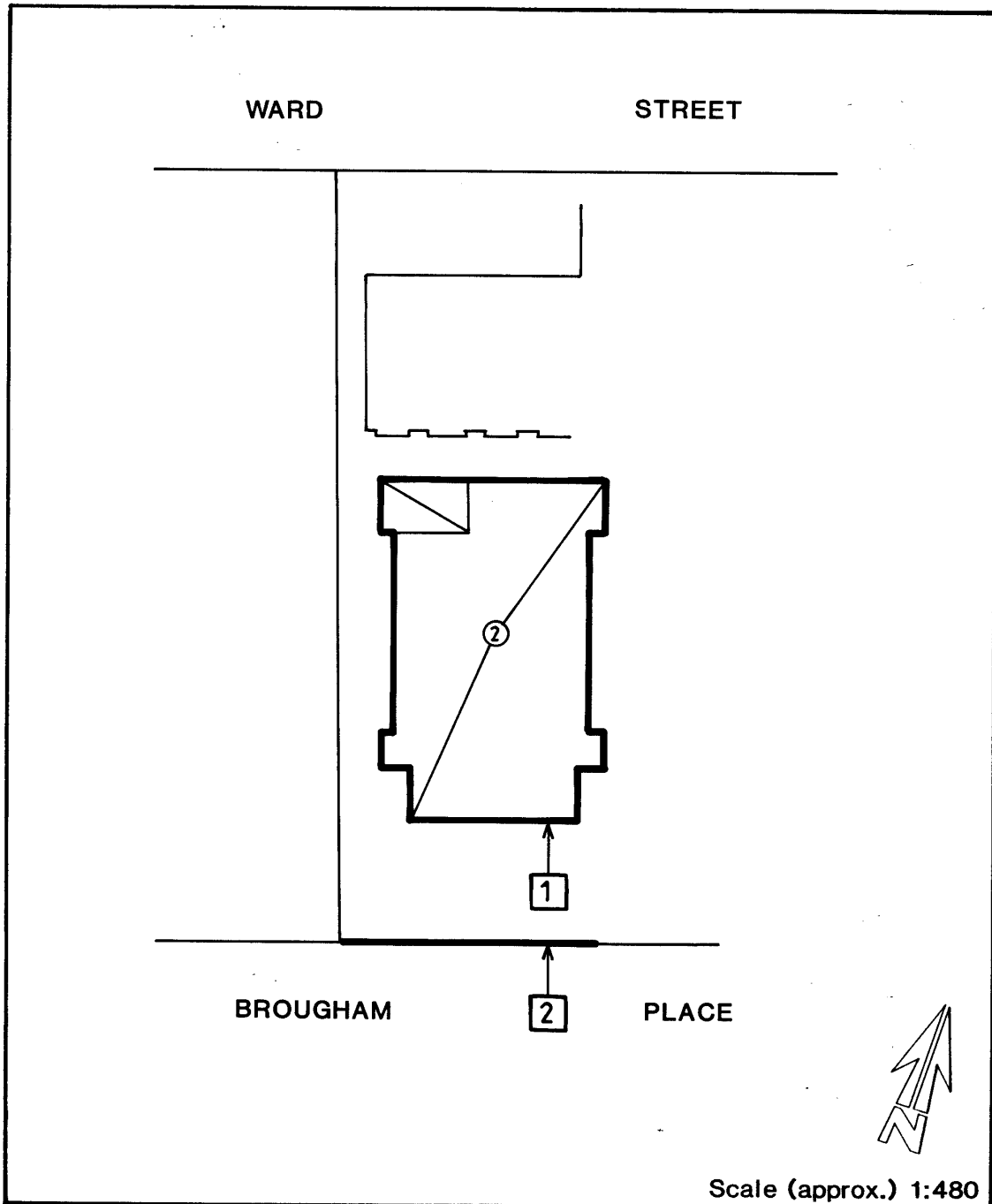

Image scanned - not to stated scale.

This Curtilage Map has been prepared as a guide only and no warranty or assurance is given about the accuracy of the content as it may contain obsolete information. The Corporation excludes all liability [including for negligence] in relation to your use of these documents.



CITY OF ADELAIDE HERITAGE STUDY

The City Heritage Register-Definition of Items

Prepared by the Dept. of Planning and Development

Item	HOUSE (PART LINCOLN COLLEGE)	Building N ^o
		34/0107-2
Address	35-37 Brougham Place, North Adelaide	
		CT 2755/181

NOTES:

1. Verandah/balcony removed.
2. Masonry wall, cast iron railings and gates.