

## FORMER HOUSE (PART OF LINCOLN COLLEGE)

38-41 Brougham Place



(CD Ref 1215/49)

This house was built for A.G. Rymill in 1907, and also occupied by his son (Sir) Arthur C. Rymill who was a member of the Adelaide City Council for twenty-three years, becoming lord mayor in 1950-54.

The house was eventually added to the stock of properties owned by Lincoln College as part of its overall development to become in the 1970s the largest of the four university colleges.

This former grand residence is an important element in an architectural assemblage along Brougham Place and exemplifies changes in architectural design during the Edwardian period. These changes are illustrated by the asymmetry of the composition, the informal grouping of elements, the corner feature with its spire, projecting oriel and bay, and the use of terracotta tiles. The building is well constructed of sandstone ashlar with brick dressings.

ACA, Assessments, *Digest of Proceedings*, 14 January 1907, Smith Survey 1880; *Advertiser*, 10 June 1954; Shearer, C., *Lincoln College, the first twenty-five years, 1952-1976*.

The text in this Information Sheet was copied from the **Heritage of the City of Adelaide: An Illustrated Guide**, (1996). The photographs contained in this Information Sheet are a selection of those held by Heritage Services, in digital format.

The property described in this Information Sheet is included in the Register of State Heritage places. A heritage listing does not mean or imply right of access by the public to such properties.

*The heritage related Principles of Development Control as well as the Precinct specific objectives and Principles of Development Control are contained in the Adelaide (City) Development Plan. These should be referred to in whole when contemplating any development.*

*Further information on the Heritage Incentives Scheme, an initiative of Council to sponsor timely and appropriate conservation action is available upon request of the Customer Service Centre.*



# CITY OF ADELAIDE HERITAGE STUDY

## The City Heritage Register-Definition of Items

Prepared by the Dept. of Planning and Development

Item	HOUSE (LINCOLN COLLEGE)	Building No	34/0106-3
Address	38-41 Brougham Place, North Adelaide 75-81 Ward Street	CT	866/40

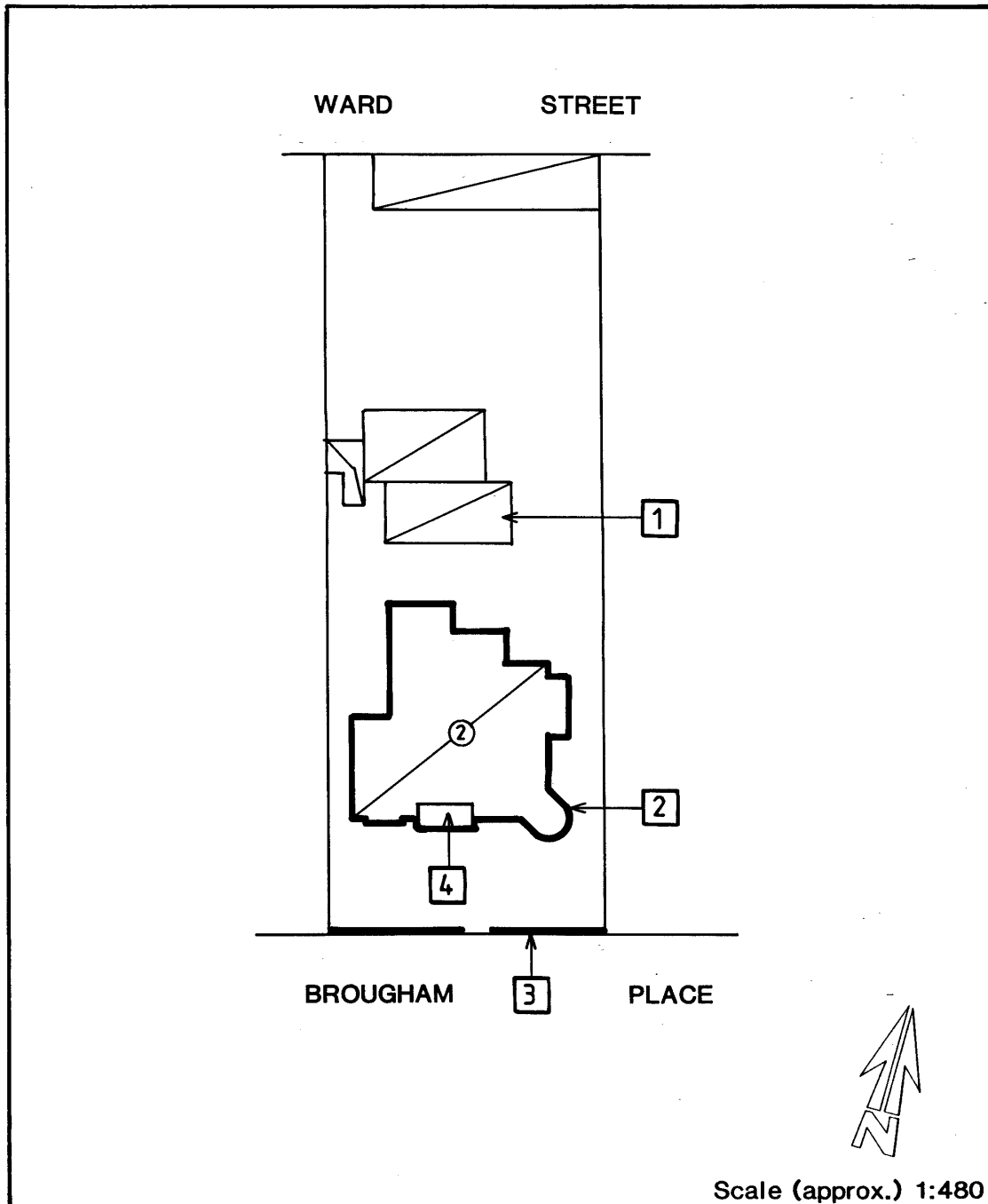

Scale (approx.) 1:480

***Image scanned - not to stated scale.***

This Curtilage Map has been prepared as a guide only and no warranty or assurance is given about the accuracy of the content as it may contain obsolete information. The Corporation excludes all liability [including for negligence] in relation to your use of these documents.



# CITY OF ADELAIDE HERITAGE STUDY

## The City Heritage Register-Definition of Items

Prepared by the Dept.of Planning and Development

<b>Item</b>	HOUSE (LINCOLN COLLEGE)	<b>Building N<sup>o</sup></b>
<b>Address</b>	38-41 Brougham Place, North Adelaide 75-81 Ward Street	34/0106-3 CT 866/40

### NOTES:

1. Outbuilding, now altered.
2. Corner feature with spire.
3. Note Wall and cast iron railings.
4. Balcony.