

WALKLEY COTTAGE, ST MARK'S COLLEGE

42 Pennington Terrace



(CD Ref 3971/53)

Dwarfed by the grand residences of the late nineteenth century and the nearby St Peters Cathedral, this cottage has survived from the earliest days of the colony. The original house was a prefabricated timber dwelling or 'portable colonial cottage' made by Henry Manning of High Holborn, London, and erected on Pennington Terrace in 1839. The building illustrates well the piecemeal development of early Australian houses, the brickwork of later years now totally encasing the original timber house.

Henry Watson, brother-in-law and business associate of the prominent South Australian colonist John Barton Hack, arrived with his family in South Australia in March 1839. There is little doubt that his association with Hack led him to bring out a Manning house. Hack had arrived in South Australia in early 1837 when building improvements in Adelaide were few, but by the time of the Watsons' arrival, Hack had erected a fine, two storey stone house in Hindley Street (a desirable address at that time) where the Watson family first lived.

The Watson family was disenchanted with the prospects of occupying the Manning house which was, after all, designed to be transportable and therefore easily erected or struck. In May 1839 Watson wrote, ' . . . we have not yet decided whether to erect it on the South Terrace or in North Adelaide, in the hopes of selling it and the land . . . It is now no longer necessary to bring wooden houses'. In June he recorded that he was in the process of erecting the house on Pennington Terrace and shortly afterwards it was advertised for sale. Due to the onset of economic difficulties and lack of liquidity which bedevilled the colony in the early 1840s, Watson was unable to sell the property for a good price. He wrote in complaint to a relative in England, 'Pray advise everyone you have any influence with not to commit the absurdity of bringing a house out with him. They are to [be] bought here cheaper than in London'. His family was forced to occupy the house during the winter of 1840.

Heritage of the City of Adelaide

By July the building had been surrounded by a brick paved veranda to all sides, and by late 1840 the Watsons ' . . . having been almost broiled' during the summer, had the building encased by a brick veneer. The house was eventually sold to E. Trimmer, and later purchased by George Morphett in 1848 and other private owners before finally becoming part of St Mark's which has renovated the building.

Originally a four roomed cottage, only the front two rooms now reveal evidence of the typical Manning panelling, although the gabled roof structure and loft remain hidden behind the brick parapet. The importance of this building has long been recognised although its origins have only recently been established. Its relationship with another Manning construction adjacent (Meeting Hall of the Religious Society of Friends) is unique. As such it is of great architectural and historical significance both within the setting of St Mark's College and to the landscaped character of Pennington Terrace. The building itself is of national and even international significance.

ACA, Assessments, Smith Survey 1880; Cockburn, R., *Pastoral pioneers of South Australia*, Vol. 1, 1925, pp. 122-3; Gilbert, S.H., & Berry, D.W., 'Regional pioneer building techniques', Project 9 of the National Estate Programme 1975/1976; Morgan, E.J.R., & Gilbert, S.H., *Early Adelaide architecture 1836 to 1886*, 1969, pp. 98-9.

The text in this Information Sheet was copied from the **Heritage of the City of Adelaide: An Illustrated Guide**, (1996). The photographs contained in this Information Sheet are a selection of those held by Heritage Services, in digital format.

The property described in this Information Sheet is included in the Register of State Heritage places.
A heritage listing does not mean or imply right of access by the public to such properties.

The heritage related Principles of Development Control as well as the Precinct specific objectives and Principles of Development Control are contained in the Adelaide (City) Development Plan. These should be referred to in whole when contemplating any development.

Further information on the Heritage Incentives Scheme, an initiative of Council to sponsor timely and appropriate conservation action is available upon request of the Customer Service Centre.



CITY OF ADELAIDE HERITAGE STUDY

The City Heritage Register - Definition of Items

Prepared by the Dept. of Planning and Development

Item	COTTAGE (ST. MARK'S COLLEGE)	Building N ^o	35/2214-2
Address	42-44 Pennington Terrace, North Adelaide		CT 1171/95

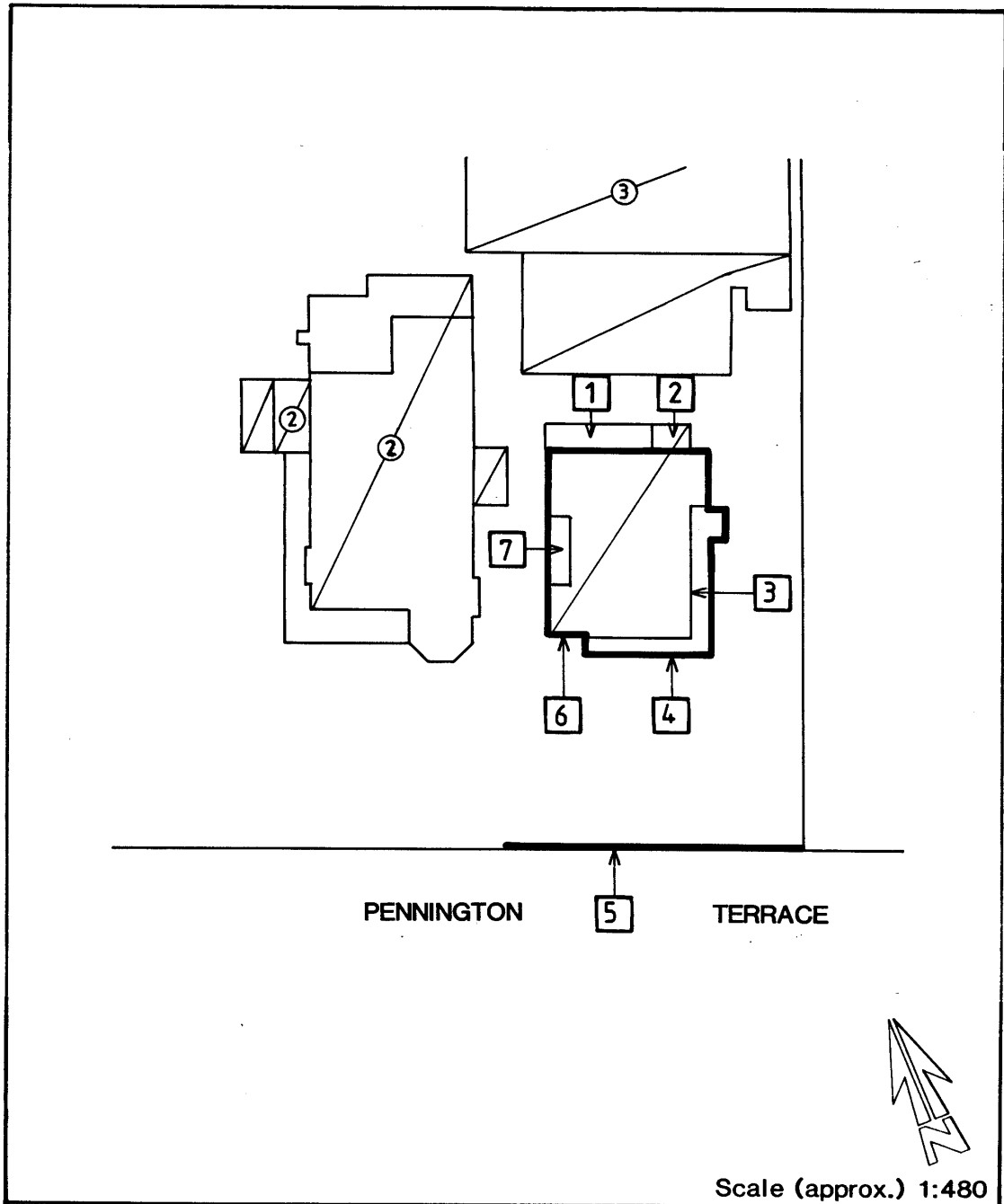

Image scanned - not to stated scale.

This Curtilage Map has been prepared as a guide only and no warranty or assurance is given about the accuracy of the content as it may contain obsolete information. The Corporation excludes all liability [including for negligence] in relation to your use of these documents.



CITY OF ADELAIDE HERITAGE STUDY

The City Heritage Register-Definition of Items

Prepared by the Dept. of Planning and Development

Item	COTTAGE (ST. MARK'S COLLEGE)	Building No
Address	42-44 Pennington Terrace, North Adelaide	35/2214-2
		CT 1171/95

NOTES:

1. Verandah not original.
2. Brick addition.
3. Note: Parapet with dentils.
4. Note: Concave verandah and timber joinery.
5. Bluestone, brick and iron rail fence.
6. Brick construction.
7. Timber gable of original cottage visible.

