

HOUSE

5-7 Brougham Place



(CD Ref 1215/32)

This house, and its neighbour Taylor House, are important survivors of the redevelopment of Brougham and Palmer places which occurred around the turn of the century. They make a considerable contribution to the special character of the Brougham Place ridge.

The site was purchased by Charles Henry and Helen Augusta Goode in 1901. Plans for the building were approved by Council in November 1907. The house effectively commemorates the mercantile success of Goode and his company Goode Durrant and Co.

C.H. Goode was born in Herefordshire in 1827 and was apprenticed to a draper at the age of twelve. He arrived in South Australia in 1849 and entered into partnership with Thomas Good, opening a softgoods store in Kermodie Street, North Adelaide. Goode was later joined by his brothers Samuel and Matthew, and in thirty years of commerce they built warehouses in Rundle and Grenfell streets and Stephens Place. The partnership of Goode Brothers was dissolved in 1882, C.H. Goode joining W.H. Durrant of London, the firm eventually becoming known as Goode, Durrant, Tite and Company. Branches were established in London, Broken Hill, Perth and Kalgoorlie, and the firm was considered one of the colony's leading business houses.

Goode represented East Torrens in the House of Assembly and was also actively associated with the Destitute Act Commission, State Children's Council, the YMCA, Flinders Street Baptist Church, North Adelaide Institute, the Belair Retreat, the Convalescent Home and the Adelaide Benevolent and Strangers' Friend Society. He played an important part in establishing the Royal Institution for the Blind, and the Blind, Deaf and Dumb Mission. The *Cyclopedia of South Australia* commented '... his truly catholic spirit leads him to extend his beneficence over many fields'.

The house is an important example of federation period architecture. The architect has not been traced, but it is well detailed internally and externally, displaying a disciplined eclecticism in its combination of picturesque and classically derived elements. The fireplaces and overmantles are particularly significant in this regard. The relatively high integrity of the house is also seen in the survival of internal finishes - in particular, the imported walnut fire surrounds and the leaded stained-glass. The stair hall and internal planning in general are well-conceived and illustrate the interest of the period in the asymmetrical plan form.

Heritage of the City of Adelaide

ACA, *Digest of Proceedings*, 18 November 1907; Burgess, H.T., *Cyclopedia of South Australia*, Vol. 1, 1909, pp. 587-90; MLSA, Historical photographs (Town Acre 733).

The text in this Information Sheet was copied from the **Heritage of the City of Adelaide: An Illustrated Guide**, (1996). The photographs contained in this Information Sheet are a selection of those held by Heritage Services, in digital format.

The property described in this Information Sheet is included in the Register of State Heritage places. A heritage listing does not mean or imply right of access by the public to such properties.

The heritage related Principles of Development Control as well as the Precinct specific objectives and Principles of Development Control are contained in the Adelaide (City) Development Plan. These should be referred to in whole when contemplating any development.

Further information on the Heritage Incentives Scheme, an initiative of Council to sponsor timely and appropriate conservation action is available upon request of the Customer Service Centre.



CITY OF ADELAIDE HERITAGE STUDY

The City Heritage Register - Definition of Items

Prepared by the Dept. of Planning and Development

Item	HOUSE	Building N ^o	34/0204-2
Address	5-7 Brougham Place, 9-13 Ward Street, North Adelaide		CT 764/77

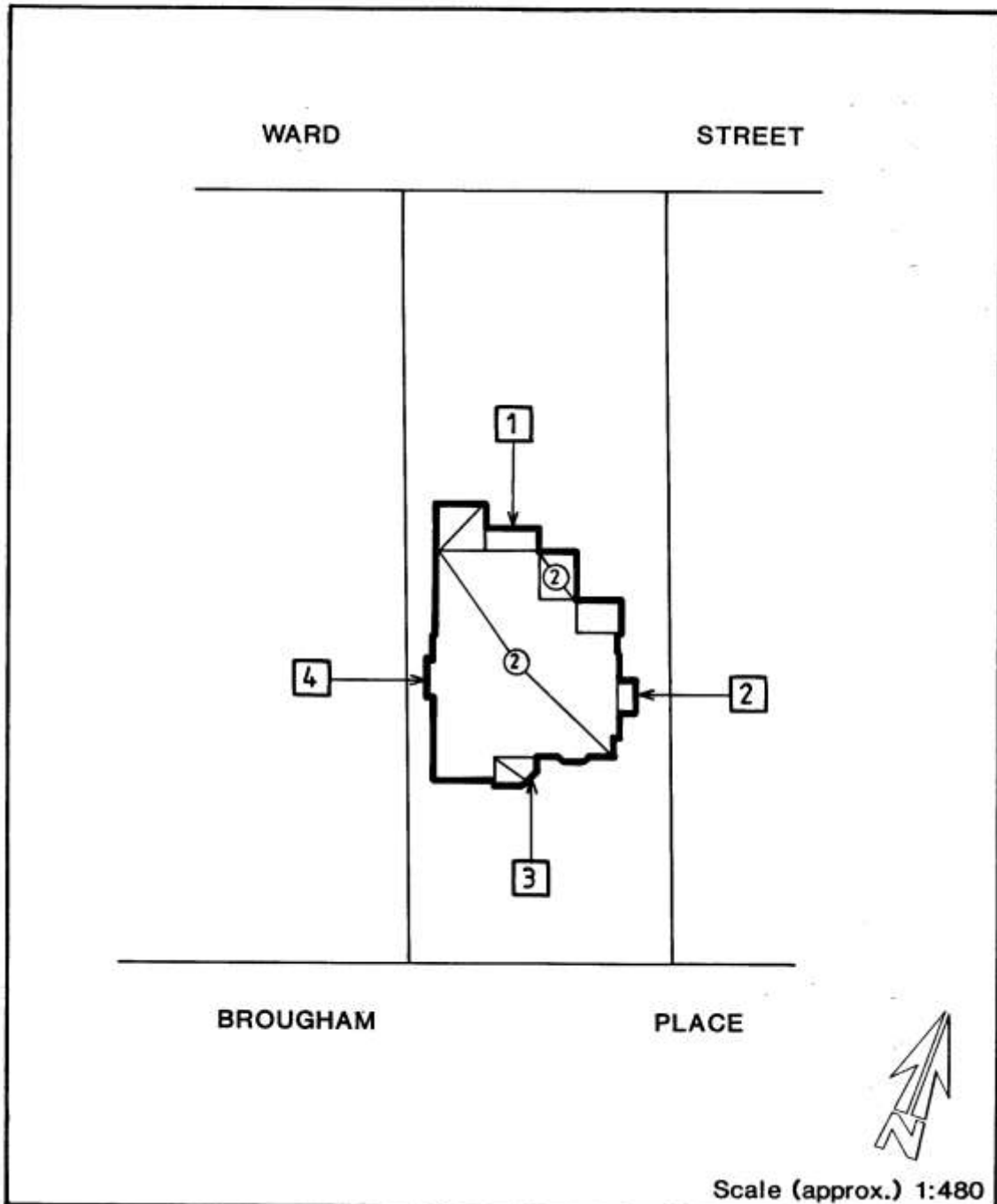

Image scanned - not to stated scale.

This Curtilage Map has been prepared as a guide only and no warranty or assurance is given about the accuracy of the content as it may contain obsolete information. The Corporation excludes all liability [including for negligence] in relation to your use of these documents.



CITY OF ADELAIDE HERITAGE STUDY

The City Heritage Register-Definition of Items

Prepared by the Dept. of Planning and Development

Item	HOUSE	Building No
Address	5-7 Brougham Place, 9-13 Ward Street, North Adelaide	34/0204-2
		CT 764/77

NOTES:

1. Verandah.
2. Balcony.
3. Porch.
4. Oriel window.