

HOUSE AND OUTBUILDING

53-56 Strangways Terrace



(CD Ref 1344/40)

North Adelaide's Park Lands frontages provided a very fashionable address, and well-to-do families who took up residence there during the nineteenth century prospered further by constructing houses similar to their own for sale or rental to other wealthy families.

George Catchlove built such a house next door to his own, designed in a similar but less ebullient style by the same architect, Rowland Rees.

The house was soon afterwards occupied by the Dominican Prioress, then Lady Milne, its owners in later years including Mrs Lilian Kither and professor of law, W.J. Brown.

While the design of this building is restrained (particularly for Rees) its quality workmanship and detailing are evident. The facade of squared, coursed, bush-hammered Tarlee bluestone is unusual and contrasts well with the bluestone rubble side walls. The asymmetrical composition is characteristic of Italianate villas of the time. There are rectangular heads to openings and an unusual treatment of cast-iron enrichment, especially cresting to guttering and the cantilevered balcony.

The building is in good order despite an enclosed porch and a new external tubular steel staircase. It is a vital element in the character of this part of Strangways Terrace and is 'paired' by Catchlove's adjoining Parramatta Villa. It contributes greatly to a notable Park Lands frontage.

ACA, Assessments, *Digest of Proceedings*, 27 February 1882; *Observer*, 22 October 1892; *South Australian Register*, 6 January 1882.



(CD Ref 1344/38)

Heritage of the City of Adelaide

The text in this Information Sheet was copied from the **Heritage of the City of Adelaide: *An Illustrated Guide***, (1996). The photographs contained in this Information Sheet are a selection of those held by Heritage Services, in digital format.

The property described in this Information Sheet is included in the Register of State Heritage places. A heritage listing does not mean or imply right of access by the public to such properties.

The heritage related Principles of Development Control as well as the Precinct specific objectives and Principles of Development Control are contained in the Adelaide (City) Development Plan. These should be referred to in whole when contemplating any development.

Further information on the Heritage Incentives Scheme, an initiative of Council to sponsor timely and appropriate conservation action is available upon request of the Customer Service Centre.



CITY OF ADELAIDE HERITAGE STUDY

The City Heritage Register-Definition of Items

Prepared by the Dept. of Planning and Development

Item	HOUSE AND OUTBUILDING	Building No	28/2015-1 & 2
Address	53-56 Strangways Terrace, North Adelaide; 285-291 Ward Street	CT	3391/194

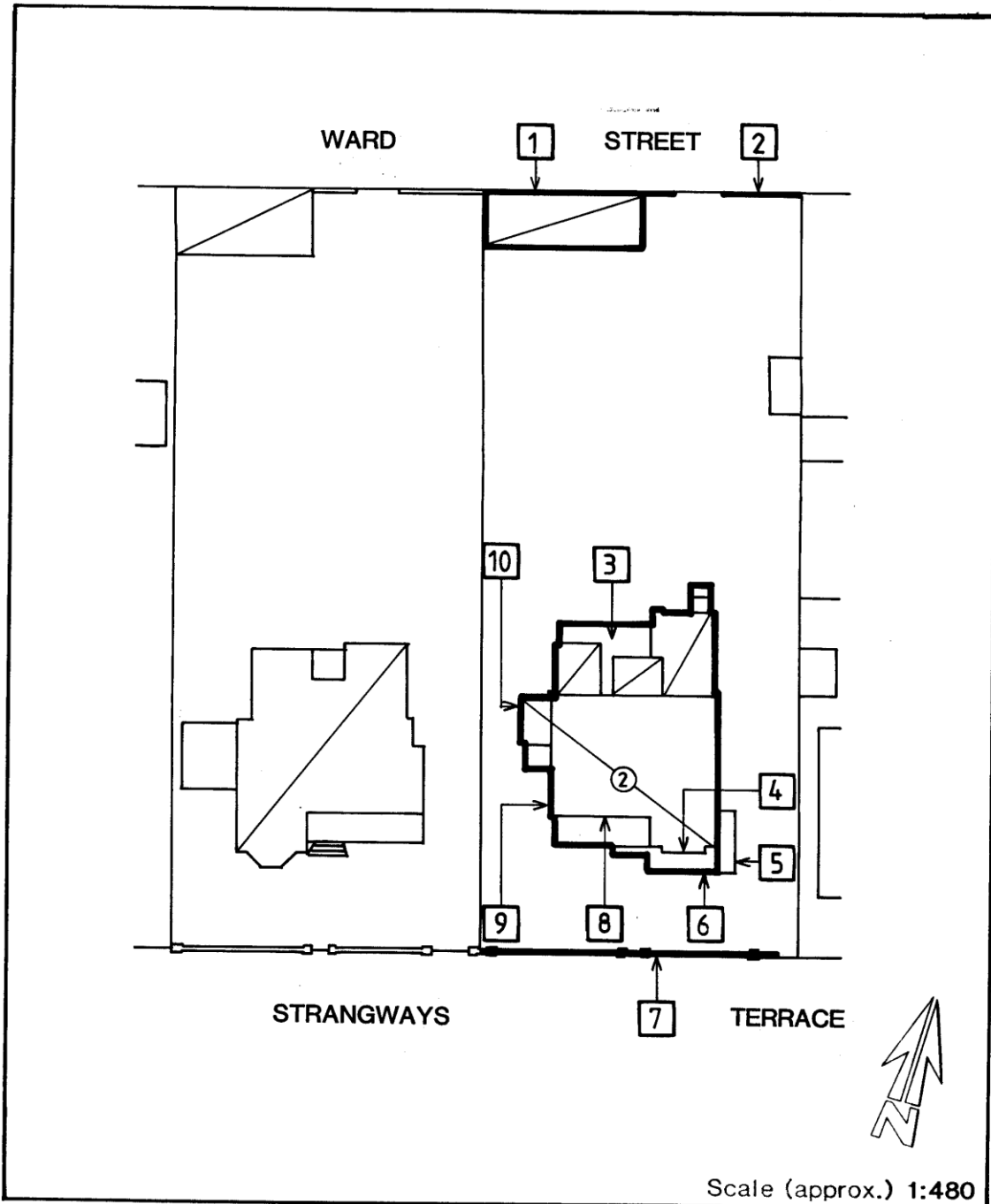

Image scanned - not to stated scale.

This Curtilage Map has been prepared as a guide only and no warranty or assurance is given about the accuracy of the content as it may contain obsolete information. The Corporation excludes all liability [including for negligence] in relation to your use of these documents.



CITY OF ADELAIDE HERITAGE STUDY

The City Heritage Register-Definition of Items

Prepared by the Dept. of Planning and Development

Item	HOUSE AND OUTBUILDING	Building No
Address	53-56 Strangways Terrace, North Adelaide; 285-291 Ward Street	28/2015-1 & 2 CT 3391/194

NOTES:

1. Note: Slit windows.
2. Limestone rubble with brick quoins. Note: Embedded glass in walling.
3. Verandah.
4. Rendered bay window.
5. Steel staircase.
6. Substantial verandah and cantilevered balcony. Note: Cast-iron brackets balustrading frieze and columns.
7. Bluestone fence with rendered coping and pillars and cast-iron railings.
8. Squared coursed hammered Tarlee bluestone with stucco enrichment.
9. Bluestone rubble. Note: Rusticated quoins.
10. First floor balcony enclosed.