

LUTHERAN BOOKSHOP (Former Huntsman Hotel)

54-60 O'Connell Street

The former Huntsman Hotel is an impressive survivor from the halcyon days of South Australia's boom of the early 1880s. It is typical of the city's better-quality late nineteenth century developments, with substantial two storey form, elaborate stuccoed dressings, and contrasting squared sandstone. The robust if eccentric detailing to chimney tops and window surrounds, and especially the broken arch pediment with pendant swags, have no counterpart in the city. The design is by Rowland Rees, who in partnership with Patterson, advertised tenders for the re building of the hotel in the *South Australian Register*, 2 October 1882.

While the structure is of obvious architectural interest, the relatively high integrity of the building and its corner location make this former hotel one of the most visually interesting buildings in North Adelaide. The hotel was erected for the prominent brewers W.H. Beaglehole, J. Johnston and J.M. Gasquoine. Beaglehole, Johnston and Gasquoine also used the services of the architect for this hotel, Rowland Rees, in the rebuilding of the British Hotel in Finnis Street. Beaglehole, Johnston and Gasquoine's operations were renamed the Lion Brewing and Malting Co. Ltd. in 1892, this concern continuing to lease the structure for some years. Subsequently, it was associated with the Walkerville Co-operative Brewing Co. Ltd., and the SA Brewing Co. Ltd. By 1960 the hotel had been delicensed and in that year it was purchased by the United Evangelical Lutheran Church of Australia Inc.



(CD Ref 1724/12)

The building recaptures some of the character of this dormitory suburb of Adelaide where corner shops and hostelries played such an important role in the community. While the removal of upper decoration (a cantilevered balcony originally graced the main facade), and the erection of an insensitive awning over large shop fronts, have marred the elevation to O'Connell Street, the former hotel is still readily identifiable with the

period when many of Adelaide's hotels were rebuilt (circa 1875-85).

While the physical changes made to the building may have detracted from its appearance, the new function may be considered of national significance. When the former hotel was bought, the Lutheran Church was divided into the United Evangelical Lutheran Church of Australia (the purchaser) and the Evangelical Lutheran Church of Australia. On 31 October 1966 the *Advertiser* reported an end to the 120-year rift between Lutherans with the agreement to amalgamate which was made at a constituting convention held at Tanunda. The convention, attended by almost 10 000 parishioners and pastors from all states, New Zealand and New Guinea, also agreed that Lutheran Church House in O'Connell Street should be the Australian

Heritage of the City of Adelaide

head office of the new church. The Lutheran Church of Australia formally came into being in 1967 and this building has been its federal church office ever since.

Thus, the building is of great significance on quite unrelated architectural and historical grounds, the former as an impressively designed 'boom era' hotel, the latter as the Australian headquarters of the first united Lutheran church since the very earliest days of German colonial settlement.

ACA, Assessments; *Advertiser*, 31 October 1966; *South Australian Register*, 2 October 1882; Ward, M.H., *Some brief records of brewing in South Australia*, 1950, p. 17.

The text in this Information Sheet was copied from the **Heritage of the City of Adelaide: An Illustrated Guide**, (1996). The photographs contained in this Information Sheet are a selection of those held by Heritage Services, in digital format.

The property described in this Information Sheet is included in the Register of State Heritage places. A heritage listing does not mean or imply right of access by the public to such properties.

The heritage related Principles of Development Control as well as the Precinct specific objectives and Principles of Development Control are contained in the Adelaide (City) Development Plan. These should be referred to in whole when contemplating any development.

Further information on the Heritage Incentives Scheme, an initiative of Council to sponsor timely and appropriate conservation action is available upon request of the Customer Service Centre.



CITY OF ADELAIDE HERITAGE STUDY

The City Heritage Register-Definition of Items

Prepared by the Dept. of Planning and Development

Item	LUTHERAN BOOKSHOP (former HUNTSMEN'S HOTEL)	Building No 33/2001-1
Address	54-60 O'Connell Street, North Adelaide; 101-119 Archer Street	CT 1713/184

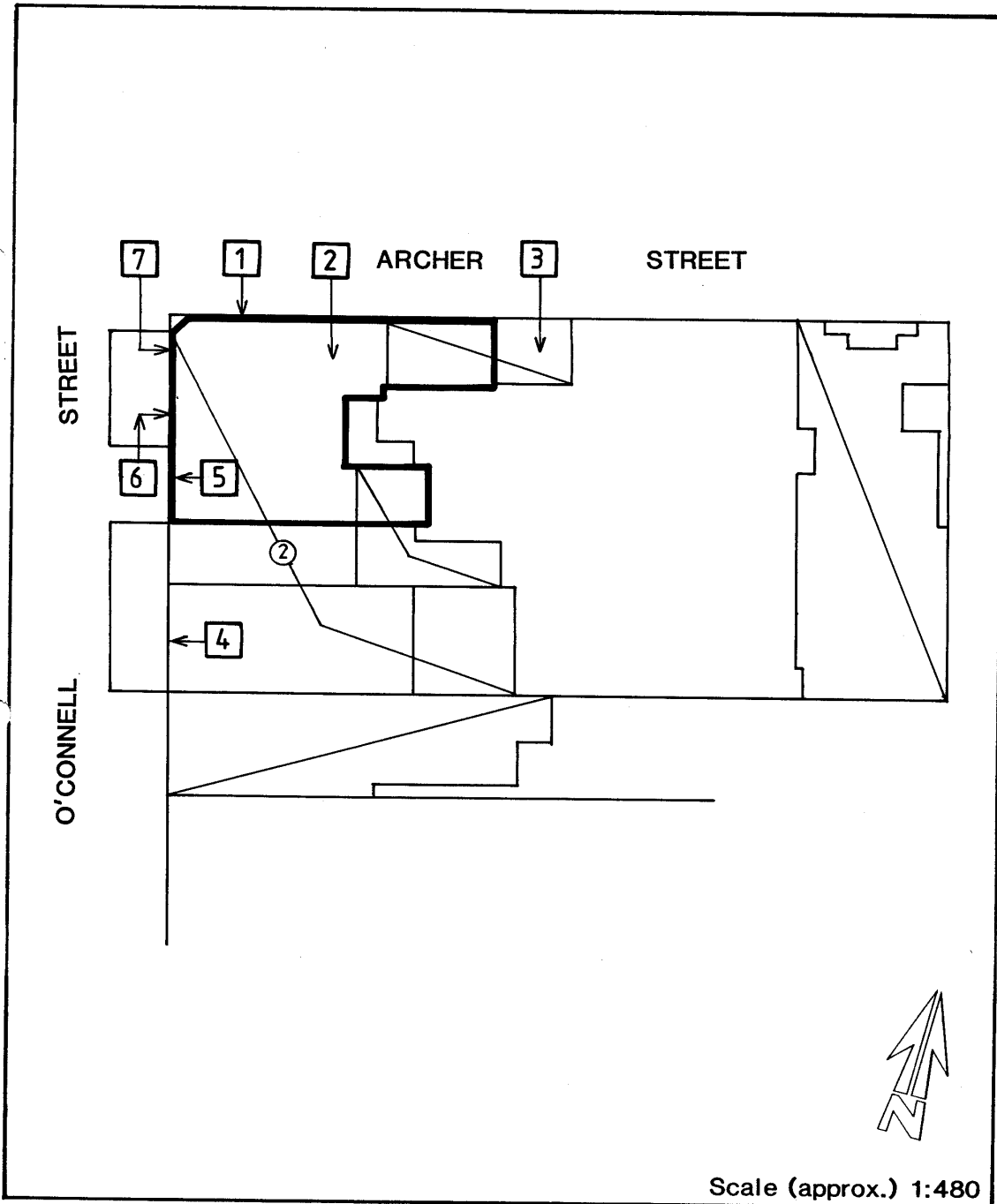

Image scanned - not to stated scale.

This Curtilage Map has been prepared as a guide only and no warranty or assurance is given about the accuracy of the content as it may contain obsolete information. The Corporation excludes all liability [including for negligence] in relation to your use of these documents.



CITY OF ADELAIDE HERITAGE STUDY

The City Heritage Register - Definition of Items

Prepared by the Dept. of Planning and Development

Item	LUTHERAN BOOKSHOP (former HUNTSMEN'S HOTEL)	Building No
Address	54-60 O'Connell Street, North Adelaide; 101-119 Archer Street	33/2001-1 CT 1713/184

NOTES:

1. Window and door closed off.
2. Note Chimneys.
3. Concrete block addition.
4. Complementary first floor facade.
5. Aluminium framed window.
6. Note Unsympathetic alterations to shop front and awning.
7. Hammered squared sandstone with stucco enrichment.