

SEMI-DETACHED HOUSES

61-63 Lefevre Terrace



(CD Ref 1724/37)

The two semi-detached houses were part of a major redevelopment carried out during the mid-1880s by Adelaide jeweller Henry Steiner.



(CD Ref 1724/32)

This building is part of an important group and highly representative of the boom period house with large projecting bay windows, asymmetrical plan form, and flamboyant detailing. The plan form allows entry from both Tynte Street and Lefevre Terrace, and the building is a local landmark and an important component of both streetscapes. It is one of the largest of this type of building to survive in the city.

ACA, Assessments; MLSA, Historical photographs (Town Acre 870).

The text in this Information Sheet was copied from the **Heritage of the City of Adelaide: An Illustrated Guide**, (1996). The photographs contained in this Information Sheet are a selection of those held by Heritage Services, in digital format.

The property described in this Information Sheet is included in the Register of State Heritage places. A heritage listing does not mean or imply right of access by the public to such properties.

Heritage of the City of Adelaide

The heritage related Principles of Development Control as well as the Precinct specific objectives and Principles of Development Control are contained in the Adelaide (City) Development Plan. These should be referred to in whole when contemplating any development.

Further information on the Heritage Incentives Scheme, an initiative of

Council to sponsor timely and appropriate conservation action is available upon request of the Customer Service Centre.



(CD Ref 1724/34)



CITY OF ADELAIDE HERITAGE STUDY

The City Heritage Register-Definition of Items

Prepared by the Dept. of Planning and Development

| | | |
|---------|--|------------------------|
| Item | SEMI-DETACHED HOUSES | Building No 32/2312 |
| Address | 61-63 Lefevre Terrace (Known as 62 and 63); 2-12 Tynte Street, North Adelaide | CT 4126/491 & 492 |

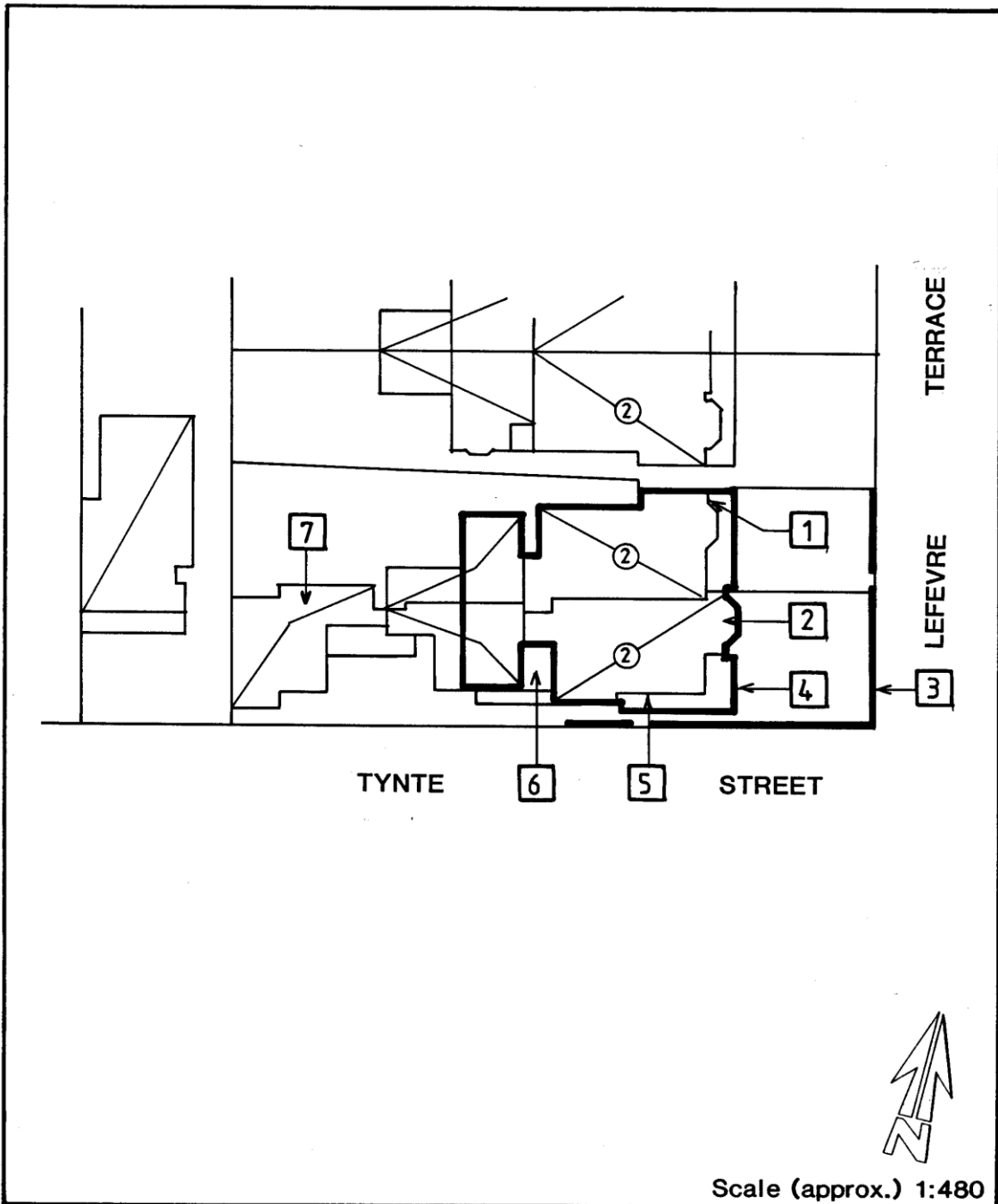

Image scanned - not to stated scale.

This Curtilage Map has been prepared as a guide only and no warranty or assurance is given about the accuracy of the content as it may contain obsolete information. The Corporation excludes all liability [including for negligence] in relation to your use of these documents.



CITY OF ADELAIDE HERITAGE STUDY

The City Heritage Register-Definition of Items

Prepared by the Dept. of Planning and Development

| | | |
|----------------|--|--------------------|
| Item | SEMI-DETACHED HOUSES | Building No |
| Address | 61-63 Lefevre Terrace (Known as 62 and 63); 2-12 Tynte Street, North Adelaide | 32/2312 |
| | | CT 4126/491 & 492 |

NOTES:

1. Coursed random bluestone with stucco enrichment.
2. Bay window with balcony and verandah above.
3. Cast iron and rendered masonry fence.
4. Cast iron balustrade, frieze, spandrels and columns.
5. Note leadlight.
6. Brick addition.
7. Separate residence.