

NORTH ADELAIDE POLICE STATION

61-69 Archer Street



(CD Ref 1724/13)

The police station with residence and lock-up was completed in 1864 for a cost of £385. The builder was J. Wheatley. In 1866 a tender for erecting a veranda was given to William Bunday.

The building replaced a former station in Kermode Street which was built in 1850. The new Archer

Street station was built when there was an upsurge of such buildings throughout South Australia as an important development of the South Australian Police Force.

The station is a good example of its type, built of bluestone with a hipped slate roof, since replaced by corrugated galvanised-iron.

ACA, Assessments 1864; Morgan, E.J.R., & Gilbert, S.H., *Early Adelaide architecture 1836 to 1886*, 1969, p. 125; PRO, GRG 38/7/1863/731, 38/7/1866/712, Records of Department of Housing and Construction; *South Australian Register*, 4 September 1865.

The text in this Information Sheet was copied from the **Heritage of the City of Adelaide: An Illustrated Guide**, (1996). The photographs contained in this Information Sheet are a selection of those held by Heritage Services, in digital format.

The property described in this Information Sheet is included in the Register of State Heritage places. A heritage listing does not mean or imply right of access by the public to such properties.

The heritage related Principles of Development Control as well as the Precinct specific objectives and Principles of Development Control are contained in the Adelaide (City) Development Plan. These should be referred to in whole when contemplating any development.

Further information on the Heritage Incentives Scheme, an initiative of Council to sponsor timely and appropriate conservation action is available upon request of the Customer Service Centre.



CITY OF ADELAIDE HERITAGE STUDY

The City Heritage Register - Definition of Items

Prepared by the Dept. of Planning and Development

Item	NORTH ADELAIDE POLICE STATION	Building No	33/2204-1
Address	On land 61-69 Archer Street, North Adelaide		CT 47/202

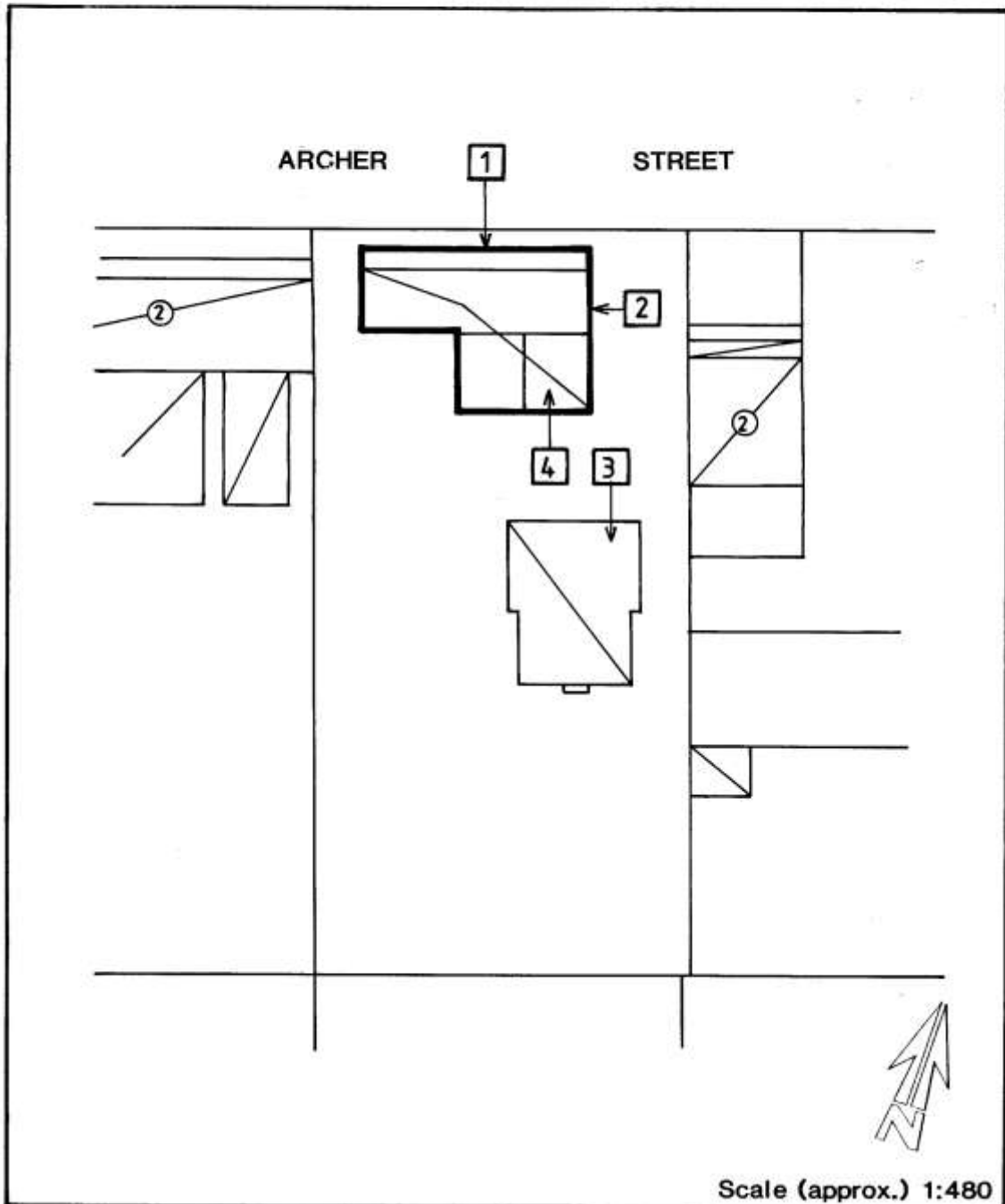

Image scanned - not to stated scale.

This Curtilage Map has been prepared as a guide only and no warranty or assurance is given about the accuracy of the content as it may contain obsolete information. The Corporation excludes all liability [including for negligence] in relation to your use of these documents.



CITY OF ADELAIDE HERITAGE STUDY

The City Heritage Register-Definition of Items

Prepared by the Dept. of Planning and Development

Item	NORTH ADELAIDE POLICE STATION	Building No 33/2204-1
Address	On land 61-69 Archer Street, North Adelaide	CT 47/202

NOTES:

1. Note Timber columns, spandrels and concave verandah.
2. Bluestone walling with red brick quoins.
3. Red brick house.
4. Partially open lean-to.