

SEMI-DETACHED HOUSES

68-70 Lefevre Terrace



(CD Ref 1724/37)

These houses were built for Henry Steiner as part of a speculative development in the mid-1880s. They were constructed as part of a group deliberately pitched to attract wealthy and prominent tenants to one of the main upper-class residential streets in North Adelaide. Early tenants, R. Raphael and V. Lawrence, were both prominent men in city financial circles.



(CD Ref 2016/97)

The building was designed by architect Joseph English. This building (part of an important group) is highly representative of the boom period house with large projecting bay windows, asymmetrical plan form, and flamboyant detailing, although its integrity has been compromised by the removal of balcony roof and of associated cast-iron decoration from the fence.* There have also been a number of alterations at ground floor level.

The building relates well in detail and scale to similar buildings along Lefevre Terrace and forms the northern end of a coherent group of three similar buildings (61-63, 64-67 and 68-70

Heritage of the City of Adelaide

Lefevre Terrace). The detailing and plan form of this building in relation to the two others in the group emphasises the ‘book-end’ function of this building in the group.

ACA, Assessments; MLSA, Historical photographs (Town Acre 870); Page, M., *Sculptors in space*, 1986, pp. 85, 157.

- * The balcony roof and associated cast iron decoration to the fence were reinstated in 1996.



(CD Ref 2017/3)

The text in this Information Sheet was copied from the **Heritage of the City of Adelaide: An Illustrated Guide**, (1996). The photographs contained in this Information Sheet are a selection of those held by Heritage Services, in digital format.

The property described in this Information Sheet is included in the Register of State Heritage places. A heritage listing does not mean or imply right of access by the public to such properties.

The heritage related Principles of Development Control as well as the Precinct specific objectives and Principles of Development Control are contained in the Adelaide (City) Development Plan. These should be referred to in whole when contemplating any development.

Further information on the Heritage Incentives Scheme, an initiative of Council to sponsor timely and appropriate conservation action is available upon request of the Customer Service Centre.



CITY OF ADELAIDE HERITAGE STUDY

The City Heritage Register-Definition of Items

Prepared by the Dept. of Planning and Development

Item	SEMI-DETACHED HOUSES	Building No	32/2308-1
Address	68-70 Lefevre Terrace, North Adelaide		CT 4059/481
			CT 4059/480

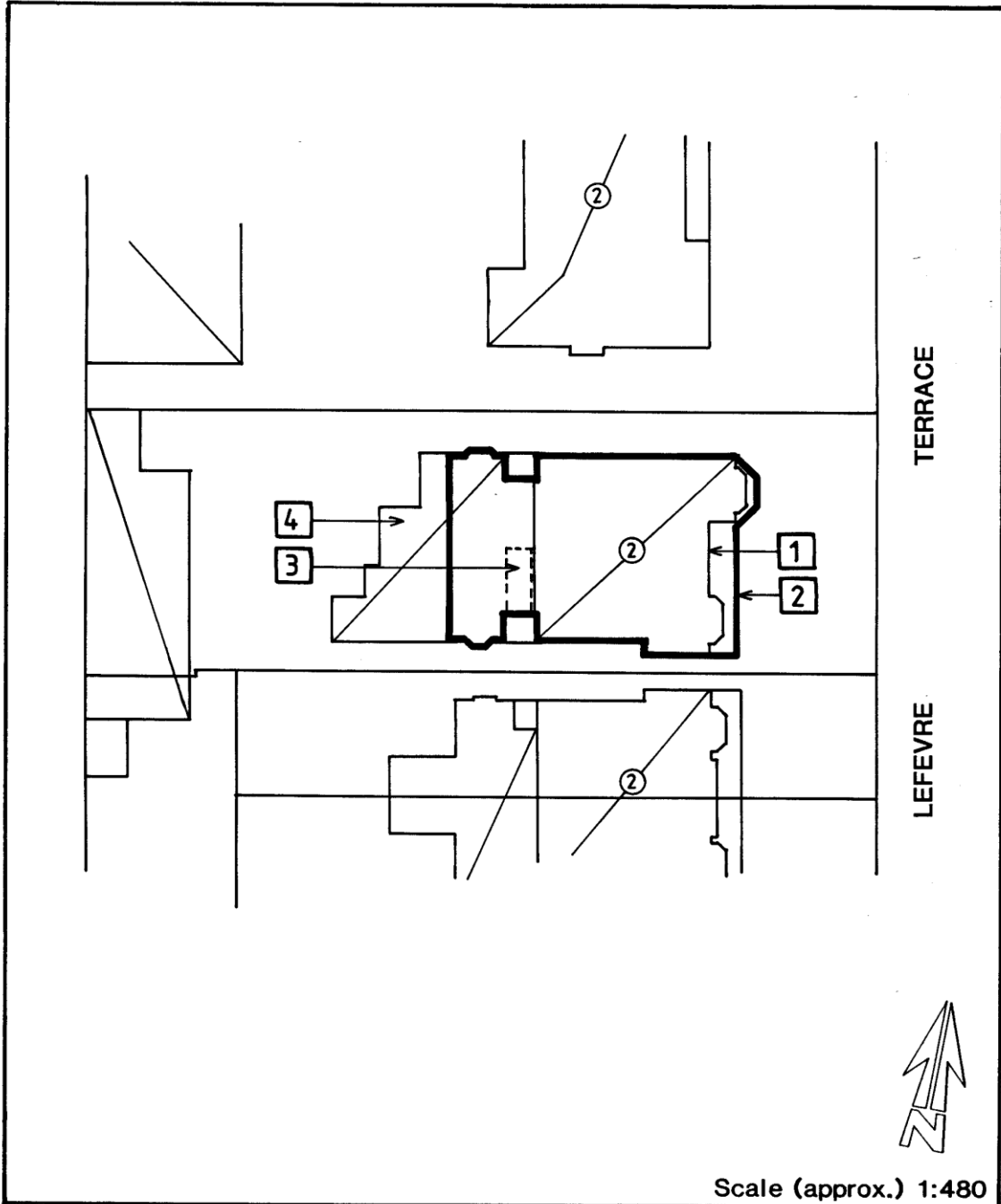

Image scanned - not to stated scale.

This Curtilage Map has been prepared as a guide only and no warranty or assurance is given about the accuracy of the content as it may contain obsolete information. The Corporation excludes all liability [including for negligence] in relation to your use of these documents.



CITY OF ADELAIDE HERITAGE STUDY

The City Heritage Register-Definition of Items

Prepared by the Dept. of Planning and Development

Item	SEMI-DETACHED HOUSES	Building No
Address	68-70 Lefevre Terrace, North Adelaide	32/2308-1
		CT 4059/481
		CT 4059/480

NOTES:

1. Coursed random bluestone with stucco enrichment.
2. Verandah removed at first floor level (cast iron balustrade retained).
3. Timber addition at first floor level excluded from curtilage.
4. Timber and stucco additions.