

FORMER SANDS & MCDUGALL WAREHOUSE

73-79 Light Square

Economic good fortune touched each of the colonial capitals during the 1880s. As businesses expanded they constructed splendid new offices and impressive warehouses, not only in their own home town but also in other cities. The great frenzy of building speculation and genuine commercial growth was in Melbourne. This unusually tall warehouse in Light Square is one local outcome of that boom.

In 1853 John Sands and Thomas Kenny bought a stationery business and set up in Collins Street, Melbourne. The firm became Sands and McDougall in 1861 (that spelling has been retained, although the key figure in the firm's expansion from the 1870s was James MacDougall who joined the firm around 1862). The firm competed with imports by printing all types of stationery with an emphasis on quality. A branch was opened in London in 1875, and in Adelaide in 1882.

The company's Adelaide headquarters in King William Street was run by a new partner, Robert Brown Fraser. In common with other businesses the firm chose a less central site for its warehouse, but still within the limits of the city.

In the late 1880s James MacDougall travelled to Europe and the United States to assess the stationery market and came back to Australia with plans for an ambitious building program for the company. As a result of his trip the massive six storey building in Spencer Street, Melbourne, was constructed for the company. A similar but smaller scale building was built in Light Square, Adelaide, the architects being D. Garlick & Son, with the building contract being awarded to W. Rogers.



(CD Ref 3964/1)

The mayor's report of 1889 noted that the premises were almost fire resistant, as each floor was ' . . . separated by arches turned in cement concrete and resting upon iron joists'. It was a prominent feature of the city and the design of the building was described as 'bold and substantial'.

Architectural interest lies in the bold brick and rendered detailing, with giant order pilasters linking first and second floors, and paired pilasters on the top floor. String courses articulate and provide a sense of proportion to the elevations to Light Square and Waymouth Street.

The external integrity of the building is high, while its bulk and sharp detailing make a major contribution to the character of Light Square. The building's contribution is enhanced by adjacent buildings and the brick and plaster decoration which predominates in several structures of this type in Light Square.

ACA, *Annual report 1889*, p. 103, Assessments; *The Age*, 2 February 1983, p. 24; *Australasian Builder and Contractor's News*, 7 July 1888; Down, H.P., *A century in printing*

Heritage of the City of Adelaide

- *the story of Sands and McDougall 1853-1953*; MLSA, Historical photographs (Town Acre 180).

The text in this Information Sheet was copied from the **Heritage of the City of Adelaide: An Illustrated Guide**, (1996). The photographs contained in this Information Sheet are a selection of those held by Heritage Services, in digital format.

The property described in this Information Sheet is included in the Register of State Heritage places. A heritage listing does not mean or imply right of access by the public to such properties.

The heritage related Principles of Development Control as well as the Precinct specific objectives and Principles of Development Control are contained in the Adelaide (City) Development Plan. These should be referred to in whole when contemplating any development.

Further information on the Heritage Incentives Scheme, an initiative of Council to sponsor timely and appropriate conservation action is available upon request of the Customer Service Centre.



CITY OF ADELAIDE HERITAGE STUDY

The City Heritage Register-Definition of Items

Prepared by the Dept. of Planning and Development

Item	FORMER SANDS AND MacDOUGALL WAREHOUSE	Building No 5/0509
Address	73-79 Light Square, 182-188 Waymouth Street	CT 4219/624

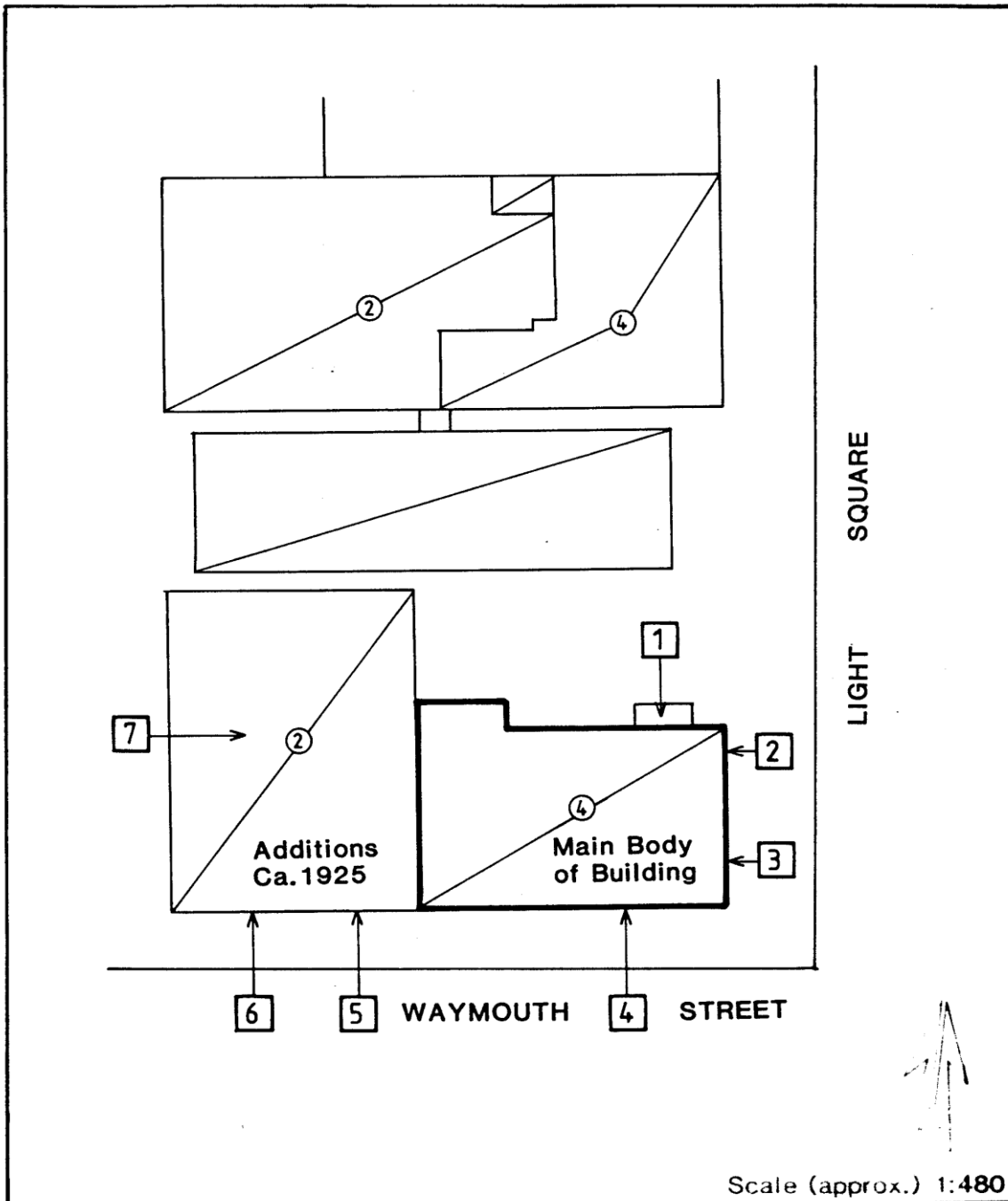

Image scanned - not to stated scale.

This Curtilage Map has been prepared as a guide only and no warranty or assurance is given about the accuracy of the content as it may contain obsolete information. The Corporation excludes all liability [including for negligence] in relation to your use of these documents.



CITY OF ADELAIDE HERITAGE STUDY

The City Heritage Register-Definition of Items

Prepared by the Dept. of Planning and Development

Item	FORMER SANDS AND MacDOUGALL WAREHOUSE	Building No 5/0509
Address	73-79 Light Square, 182-188 Waymouth Street	CT 4219/624

NOTES:

1. Unsightly fire escape.
2. Red brick English bond with moulded string courses and stucco enrichment. Rock faced (granite) plinth.
3. Aluminium framed windows.
4. Note Brick detailing around arched windows.
5. "Modernised" windows.
6. Red brick stretcher bond.
7. Adjoining building complements the Sands and MacDougall building.