

CALVARY HOSPITAL CHAPEL

61-69 Barnard Street

The historical significance of this chapel is tied to that of Calvary Hospital which reflects the philanthropic work of the Catholic Church. The order of nurses who conduct the hospital was founded for this work and this is its only institution in South Australia. The chapel and the hospital also reflect developments in private health care in South Australia.

In the 1870s Mary Potter became the foundress of the Little Company of Mary established in Hyson Green, Nottingham, England. This order, dedicated to the sick and dying, was the first such Catholic order to be established in England since the Reformation.

The Little Company of Mary expanded rapidly and by 1886 there were houses in Rome, Ireland, Australia and the United States. In 1884 when the Most Reverend Patrick Moran, bishop of Ossory in Ireland, was appointed archbishop of Sydney he decided to invite some of the blue-veiled Sisters to accompany him to Australia. In 1886 a small group of Sisters under the leadership of Mother Raphael arrived in Sydney and established the first Little Company of Mary in the suburb of Petersham. Moran gave the Sisters a site where a convent and a small hospital for women and children was opened in 1889 and became known as the Lewisham Hospital. The Little Company of Mary was invited to establish a community in Adelaide by Bessie and Elizabeth Baker in 1887 but the offer was not taken up as there were only a few members then of the Little Company.

Bessie and Elizabeth Baker had turned to the Little Company of Mary after their plans to establish a hospital administered by the Dominican Sisters had run into unforeseen difficulties (see also St Dominics Priory Chapel). Government regulations required that the hospital be set up as a formal institution admitting both male and female patients. However, the vicar of the master general of the Dominican Order would not let the Sisters engage in nursing in a hospital which included men.

As a temporary compromise the Dominican Sisters were allowed to manage the North Adelaide Private Hospital, while the nursing was done by lay-nurses. In 1900 a small group of the Little Company of Mary under the guidance of Mother M. Agatha arrived from Sydney to take over the hospital. Described as ' . . . a warren of passages and rooms', the Sisters were only allowed to live in it until they built a brand new hospital as the building was condemned by the health authorities.

From the beginning of the Little Company of Mary's involvement with the North Adelaide Private Hospital, prominent Adelaide doctors, notably Drs E. Way and A.C. Hamilton, were associated with it, and by the end of the first year the hospital was registered as a training school for nurses. The sisters raised money through fund-raising events and by donations from T. Barr Smith and Father O'Neil. The foundation stone for the new hospital was laid on 15 December 1905 and the building was opened without ceremony in 1906 when twenty-two patients were transferred from the old hospital to the new.

Heritage of the City of Adelaide

The name of Calvary Hospital was described by the *Southern Cross*, 13 November 1936 as a fitting name for the Little Company of Mary since their rules directed members to order their whole lives, their prayers, and works of charity and self-sacrifice:

. . . the end that the Divine Mercy may surround the dying. In the company of Mary, at the foot of the Cross, with humility and simplicity sharing in Mary's maternal office, the Sisters attended the death beds of those who have the happiness of breathing their last at 'Calvary'.

The hospital soon expanded. The foundation stone for the east wing extension was laid on 11 July 1917. Soon after its completion in 1918 a much-needed nurses home was also built. The foundation stone for a new convent was laid on 6 October 1929.

The 1930s heralded the golden jubilee of the arrival of the Little Company of Mary in Australia. As Dick Wordley wrote, ' . . . in less than a lifetime this international company of women had inspired monumental buildings and respected medical services as well as contributing towards medical developments and training of nurses'. Within this jubilee period the chapel at Calvary Hospital was built.

The chapel was designed by Louis Laybourne Smith who was a partner in the firm of Woods Bagot Laybourne Smith and Irwin. He also designed at Cuthbert's Church of England, Prospect, in 1914; the Adult Deaf and Dumb Mission building on South Terrace in 1928; and the War Memorial on North Terrace. The

foundation stone of the convent chapel 'dedicated to the maternal heart of Mary', was laid on 12 September 1938.

In form this building is reminiscent of the basilica of the Byzantine period, with a severe and simple exterior relieved by Romanesque detailing. Gable decoration is simply, though effectively, handled with a pronounced corbel table in well-detailed brickwork. The interior is lavishly detailed with Corinthian and Doric columns, coffered ceiling and a gallery, enhanced by statues and richly applied detail. The integrity of this building is very high.

The chapel is set amid other hospital buildings and remains an important element of this significant complex.



(CD Ref 1344/29)

Heritage of the City of Adelaide

Dougherty, P., *Mother Mary Potter foundress of the Little Company of Mary*, 1960, pp. 97, 100, 127, 157, 190, 237; O'Sullivan, D., *Dominican Sisters - North Adelaide*, 1983, p. 1; *Southern Cross*, 13 November 1936; Walkley, G., *Louis Laybourne Smith: a memoir*, 1977, p. 16; Wordley, D., *No one dies alone*, 1976, pp. 55, 104.



(CD Ref 1344/27)

timely and appropriate conservation action is available upon request of the Customer Service Centre.

The text in this Information Sheet was copied from the **Heritage of the City of Adelaide: An Illustrated Guide**, (1996). The photographs contained in this Information Sheet are a selection of those held by Heritage Services, in digital format.

The property described in this Information Sheet is included in the Register of State Heritage places. A heritage listing does not mean or imply right of access by the public to such properties.

The heritage related Principles of Development Control as well as the Precinct specific objectives and Principles of Development Control are contained in the Adelaide (City) Development Plan. These should be referred to in whole when contemplating any development.

Further information on the Heritage Incentives Scheme, an initiative of Council to sponsor



CITY OF ADELAIDE HERITAGE STUDY

The City Heritage Register-Definition of Items

Prepared by the Dept. of Planning and Development

Item	CHAPEL, CALVARY HOSPITAL	Building No 28/0209-3
Address	61-69 Barnard Street, North Adelaide (On part of land at 61-99 Barnard Street)	CT 4197/541 CT 1003/30

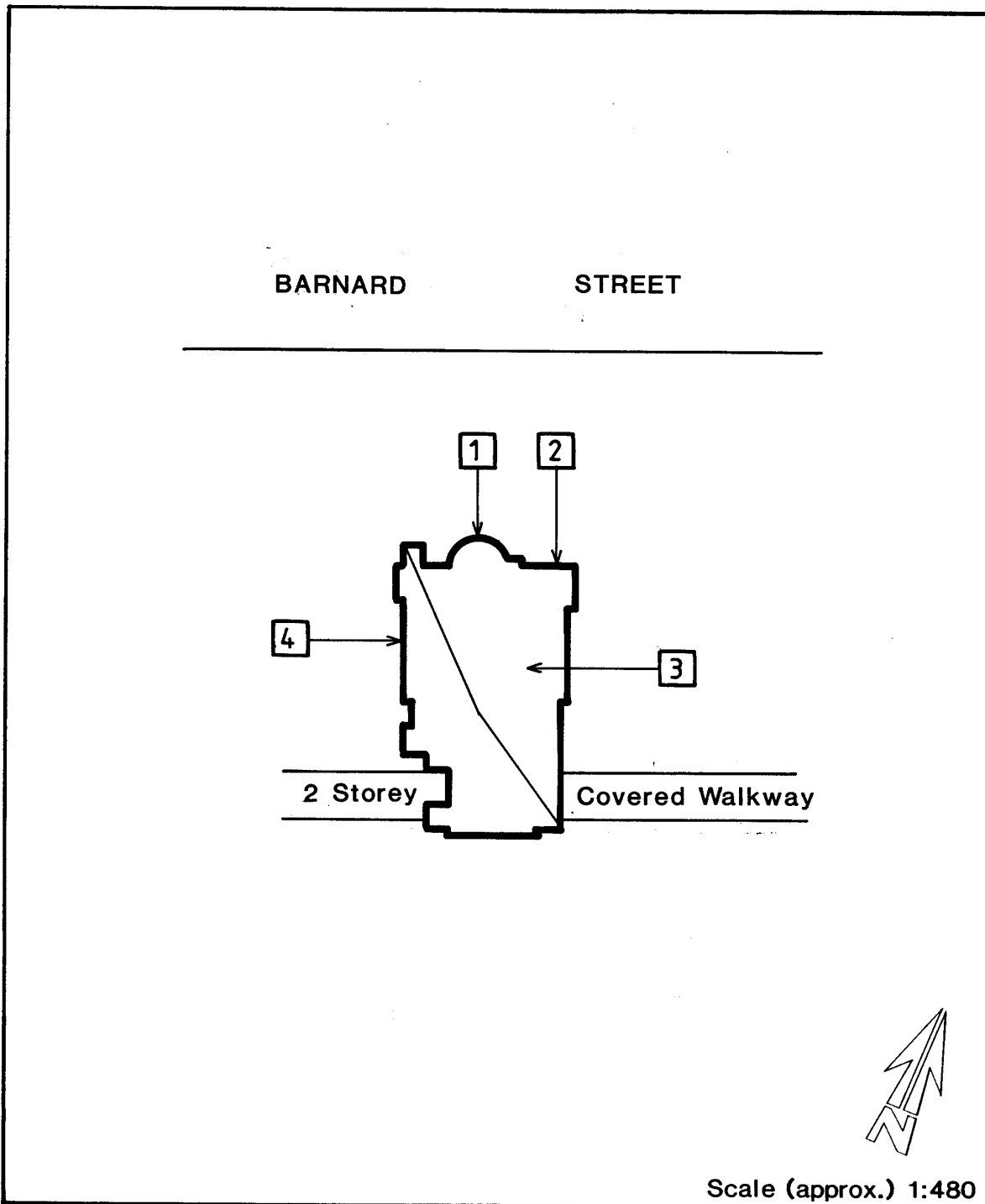

Image scanned - not to stated scale.



CITY OF ADELAIDE HERITAGE STUDY

The City Heritage Register - Definition of Items

Prepared by the Dept. of Planning and Development

Item	CHAPEL, CALVARY HOSPITAL	Building No 28/0209-3
Address	61-69 Barnard Street, North Adelaide (On part of land at 61-99 Barnard Street)	CT 4197/541 CT 1003/30

NOTES:

1. Apse with terra cotta shingle roof.
2. Brick construction and detailing with terra cotta tiled roof.
3. Interior significance.
4. Note: Stucco window surrounds.