

BUFFALO COTTAGE

88-90 Finnis Street

In 1852 this cottage stood on 4¼ acres of land owned by George Stevenson, one-time private secretary, to Governor Hindmarsh. These acres of land (town acres 991, 992, 965 and 966) contained the once-famous Stevenson's garden which, with Hack's Echunga gardens, were highly important in the propagation and establishment of new and exotic plants in the young colony. An article in the *South Australian Register*, 16 November 1839 illustrates Stevenson's level of expertise and the nature of gardening in South Australia at this time.



(CD Ref 1721/44)

Stevenson's association with this land began on 23 December 1837 when the four town acres were granted to him. A mortgage to Edward Stephens taken out on 10 March 1840 indicates impending improvements to the property. It is probable that part of the present Buffalo Cottage was completed by 1842, for its small-scale representation on the Kingston map is virtually identical with that included in the Smith

Survey and today it remains recognisably similar. It is of note that even by 1880 the four town acres still had not been subdivided; two were in fact noted as 'Chinaman's Garden'.

The buildings, of limestone brick and pug (pisé), are indicated as stone and brick in the Smith Survey, yet the Kingston map shows them as constructed of pisé. The almost identical plan form would, however, indicate a high degree of historical continuity. The structure displays pioneer building techniques and is one of the few buildings in the city



(CD Ref 1721/40)

to retain its roof cladding of rolled sheet iron, dating from 1872 (possibly indicating a later date for the front 'wing'). Although a distinctive element on Finnis Street, it makes little contribution to the streetscape because of its location behind a high fence.

Heritage of the City of Adelaide



ACA, Assessments, Smith Survey 1880; Kingston Map 1842; MLSA, Historical photographs (Town Acre 966). *South Australian Register*, 16 November 1839.

The property described in this Information Sheet is included in the Register of State Heritage places. A heritage listing does not mean or imply right of access by the public to such properties.

(CD Ref 1721/38)

The text in this Information Sheet was copied from the **Heritage of the City of Adelaide: An Illustrated Guide**, (1996). The photographs contained in this Information Sheet are a selection of those held by Heritage Services, in digital format.

The heritage related Principles of Development Control as well as the Precinct specific objectives and Principles of Development Control are contained in the Adelaide (City) Development Plan. These should be referred to in whole when contemplating any development.

Further information on the Heritage Incentives Scheme, an initiative of Council to sponsor timely and appropriate conservation action is available upon request of the Customer Service Centre.



CITY OF ADELAIDE HERITAGE STUDY

The City Heritage Register - Definition of Items

Prepared by the Dept. of Planning and Development

Item	BUFFALO COTTAGE	Building N ^o	37/0222
Address	88-90 Finnis Street, North Adelaide	CT	4246/755

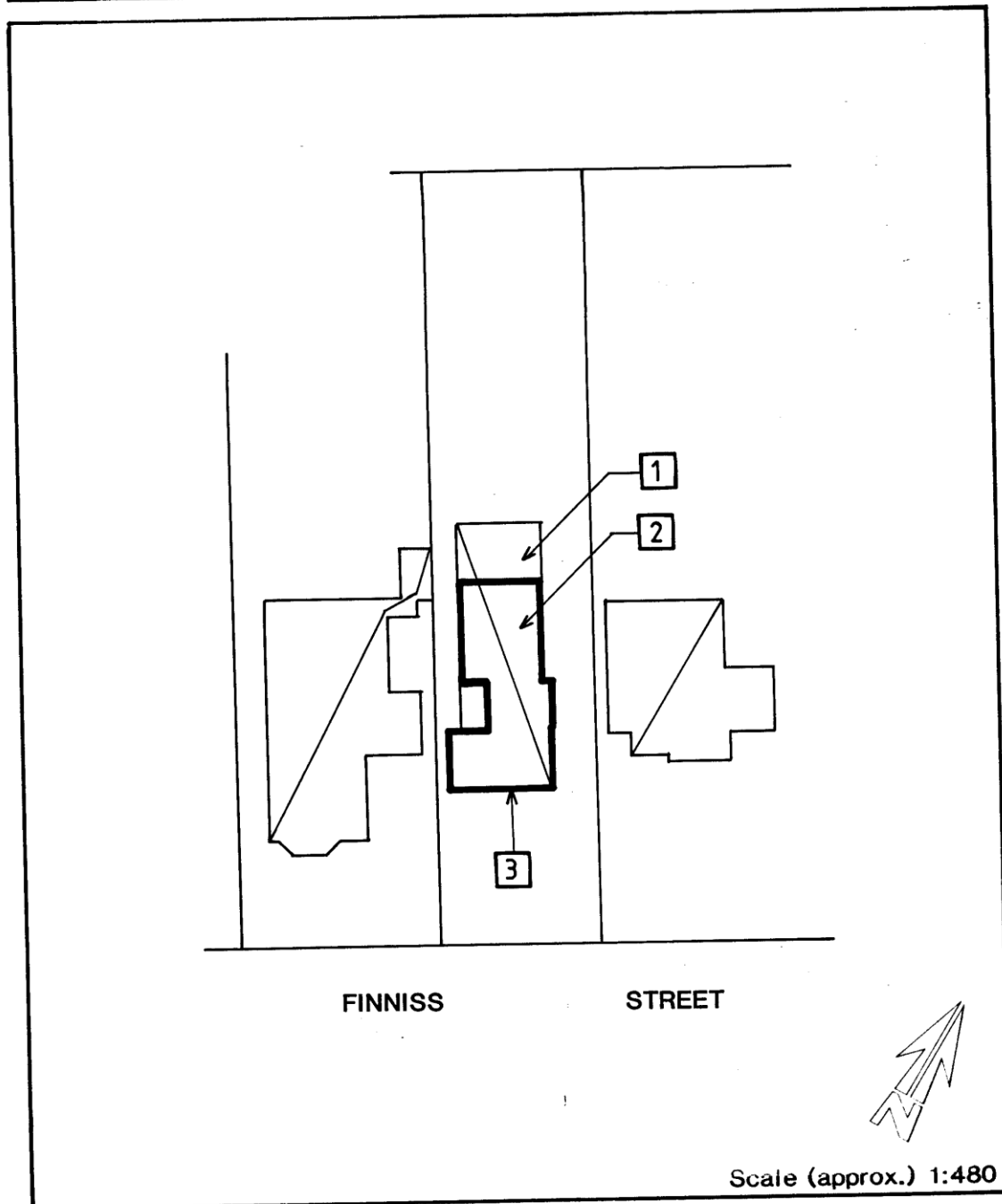

Image scanned - not to stated scale.

This Curtilage Map has been prepared as a guide only and no warranty or assurance is given about the accuracy of the content as it may contain obsolete information. The Corporation excludes all liability [including for negligence] in relation to your use of these documents.



CITY OF ADELAIDE HERITAGE STUDY

The City Heritage Register-Definition of Items

Prepared by the Dept. of Planning and Development

Item	BUFFALO COTTAGE	Building No	37/0222
Address	88-90 Finnis Street, North Adelaide		CT 4246/755

NOTES:

1. Recent addition.
2. This section of original cottage (shown on 1842 Kingston Map).
3. Limestone and brick wing (shown on 1880 Smith Survey) which replaced an earlier and larger section. Note: Sheet iron rolls to roof over this section.