

## FORMER GOLDSBROUGH MORT WAREHOUSE

9-19 Light Square



C 1982 (CD Ref 3982/52)

owned by Goldsbrough Mort and Company. This and subsequent changes of ownership exemplified the rationalisation of the many stock and station agencies which has taken place this century.



C 1991 (CD Ref 3982/51)



C 1991 (CD Ref 3982/49)

The architectural merit of this building lied primarily in its solid utilitarian construction, and the use of materials which link it with other notable brick buildings in the north and west of the Square. The building is well constructed, and is notable for the repetitive arches which distinguish it from its neighbours.

Environmentally this building is a prominent feature of Light Square which helps to define its north-west corner.

Exterior alterations appear to be minimal and the building appears to be sound and in good repair.

Donovan, Marsden, Stark, *City of Adelaide Heritage Survey*, 1981

## Heritage of the City of Adelaide

---

The text in this Information Sheet was copied from the **City of Adelaide Heritage Study**, October 1990, Volume Three, part of a review of the City of Adelaide Plan 1986-1991. The photographs contained in this Information Sheet are a selection of those held by Heritage Services, in digital format.

The property described in this Information Sheet is a place of Local Heritage (City Significance). A heritage listing does not mean or imply right of access by the public to such properties.

*The heritage related Principles of Development Control as well as the Precinct specific objectives and Principles of Development Control are contained in the Adelaide (City) Development Plan. These should be referred to in whole when contemplating any development.*

*Further information on the Heritage Incentives Scheme, an initiative of Council to sponsor timely and appropriate conservation action is available upon request of the Customer Service Centre.*

CITY of ADELAIDE HERITAGE STUDY  
THE CITY HERITAGE REGISTER — DEFINITION OF ITEMS

ITEM	FORMER WAREHOUSE	BUILDING NO.
ADDRESS	9-19 Light Square, Adelaide	

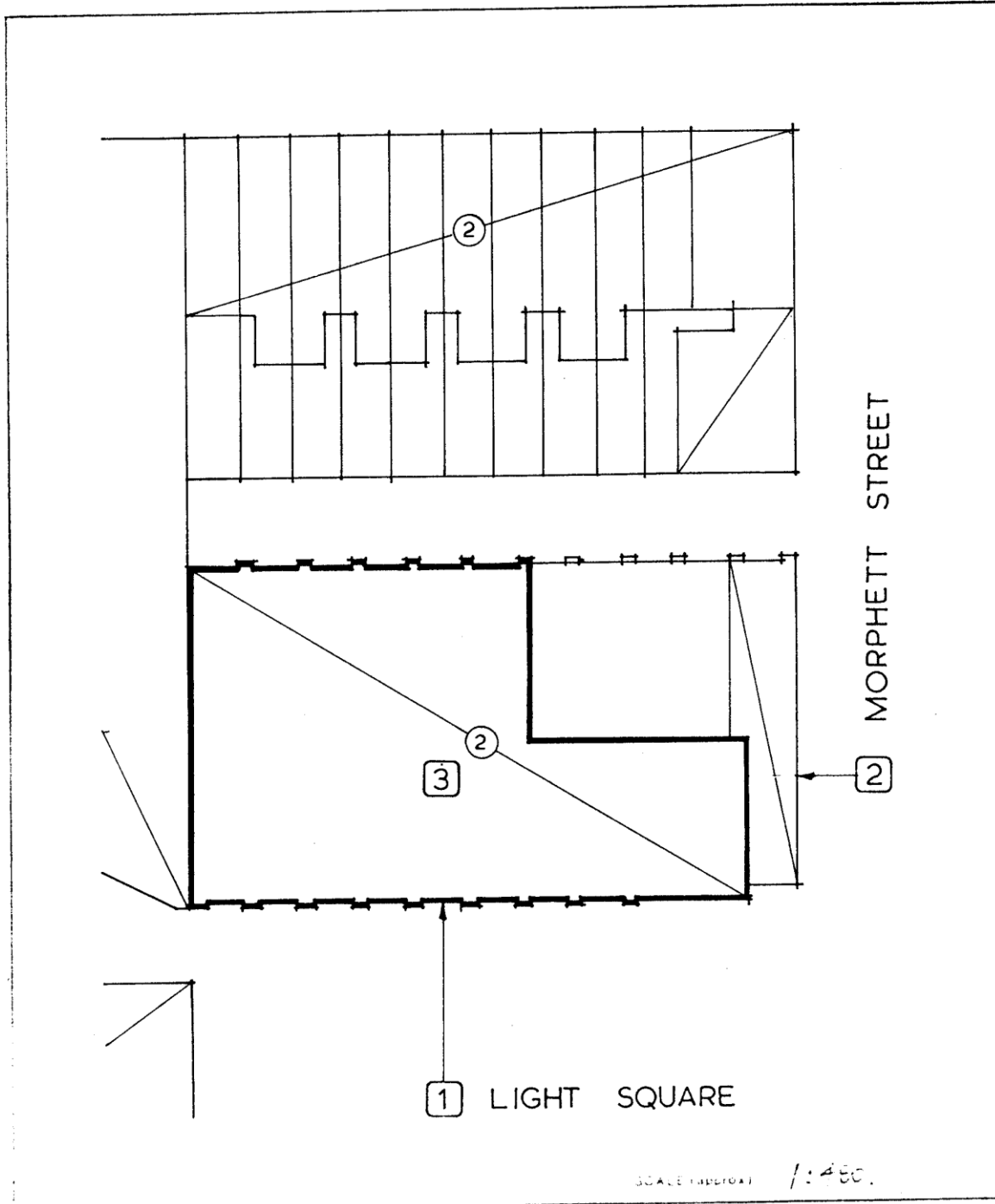

***Image scanned - not to stated scale.***

This Curtilage Map has been prepared as a guide only and no warranty or assurance is given about the accuracy of the content as it may contain obsolete information. The Corporation excludes all liability [including for negligence] in relation to your use of these documents.

**CITY of ADELAIDE HERITAGE STUDY**  
THE CITY HERITAGE REGISTER — DEFINITION OF ITEMS

<b>ITEM</b>	FORMER WAREHOUSE	<b>BUILDING NO.</b>
<b>ADDRESS</b>	9-19 Light Square, Adelaide	

1. Main body of building with well detailed brickwork and repetitive arching to Light Square frontage.
2. Rebuilt section of building addresses Morphett Street and is of quite a different appearance and construction.
3. Main body of two-storeyed warehouse.

SCALE (approx)

1:400.