

TAYLOR HOUSE

8-10 Brougham Place

Taylor House was one of several large houses built around the turn of the century which transformed Brougham Place into a precinct of grand style and wealthy residence.

The house was built in 1908-09 for W.D. Taylor, proprietor of the Lion Timber Mills, and Mrs Jessie Taylor. A tender notice ' . . . for the erection of a gentleman's residence in Brougham Place', was published in the *South Australian Register*, 30 July 1908 by the architects Edward Davies and Rutt.

The house takes its name from Jessie and Jean Taylor who owned the property in turn from 1908 until 1960. It was then bought by the Adelaide Children's Hospital - a sign of the times with the institutional and medical take-over of Brougham Place houses.

The prominent building marks a transition in form from the traditional Victorian bay-windowed villa to one which incorporates elements from the Queen Anne style with high hipped roof clad in Marseilles tiles and ornamental timber detailing to the cantilevered balcony. The applied decoration over the main entrance, leadlight windows and brickwork dressings are of high quality.

ACA, Assessments, BSO index, *Digest of Proceedings*, 24 August 1908; MLSA, Historical photographs (Town Acre 733); *South Australian Register*, 30 July 1908.

The text in this Information Sheet was copied from the **Heritage of the City of Adelaide: An Illustrated Guide**, (1996). The photographs contained in this Information Sheet are a selection of those held by Heritage Services, in digital format.

The property described in this Information Sheet is included in the Register of State Heritage places.
A heritage listing does not mean or imply right of access by the public to such properties.

The heritage related Principles of Development Control as well as the Precinct specific objectives and Principles of Development Control are contained in the Adelaide (City) Development Plan. These should be referred to in whole when contemplating any development.

Further information on the Heritage Incentives Scheme, an initiative of Council to sponsor timely and appropriate conservation action is available upon request of the Customer Service Centre.



CITY OF ADELAIDE HERITAGE STUDY

The City Heritage Register - Definition of Items

Prepared by the Dept. of Planning and Development

| | | | |
|---------|-------------------------------------|-------------|-----------|
| Item | TAYLOR HOUSE | Building No | 34/0203-2 |
| Address | 8-10 Brougham Place, North Adelaide | CT | 4247/401 |

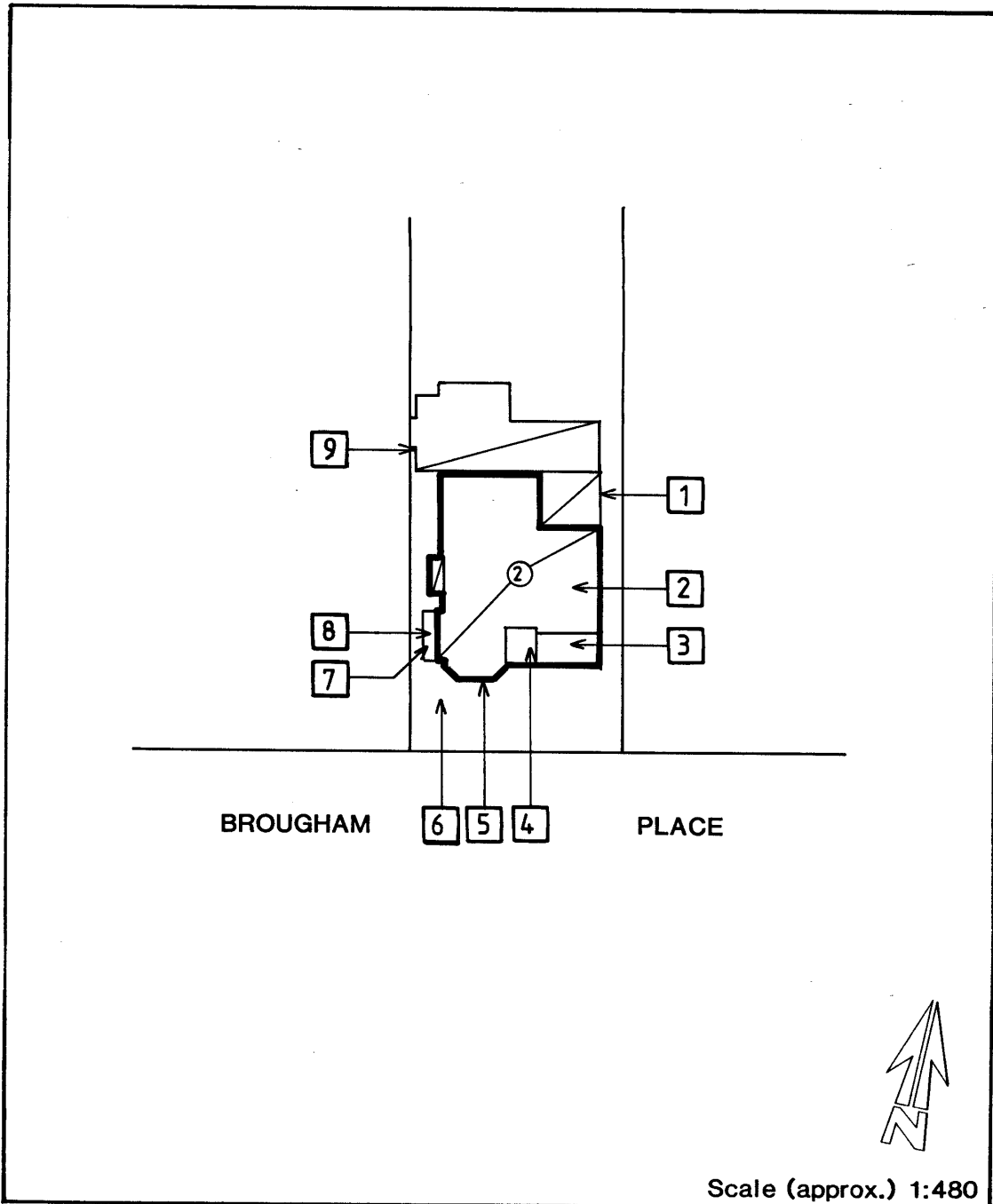

Image scanned - not to stated scale.

This Curtilage Map has been prepared as a guide only and no warranty or assurance is given about the accuracy of the content as it may contain obsolete information. The Corporation excludes all liability [including for negligence] in relation to your use of these documents.



CITY OF ADELAIDE HERITAGE STUDY

The City Heritage Register-Definition of Items

Prepared by the Dept. of Planning and Development

| | | |
|---------|-------------------------------------|-------------|
| Item | TAYLOR HOUSE | Building NO |
| | | 34/0203-2 |
| Address | 8-10 Brougham Place, North Adelaide | CT 4247/401 |

NOTES:

1. Sandstone.
2. Terra cotta tiled roof and cresting.
3. Balcony at first floor level.
4. Note: Portico with stucco scrolls.
5. Note: Bay window with leadlights.
6. Squared hammered sandstone with brick quoins and detailing and bluestone plinth.
7. Note: Leadlight windows in conservatory.
8. Balcony over conservatory.
9. Brick (English Bond).