

ADELAIDE HIGH SCHOOL **(Formerly Adelaide Boys' High School)**

Corner West Terrace/Glover Avenue



(CD Ref 2835/65)

At a state and local level the Adelaide High School is historically significant both because of its link with the state's first high school, and as an example of post-war development. Its style and design reflect the influences of architectural modernism.

The building embodies the later development of state education in South Australia, the complex having as its antecedent the original Model School in Grote Street. The Model School, erected in 1873, is renowned as the basis for the design and erection of subsequent state schools required by the Education Act of 1875.

This building was augmented by the subsequently established Teachers' Training School begun in 1876 and the State Secondary School called the 'The Advanced School for Girls' which was built in Grote Street in 1891. In 1908 these three institutions were amalgamated to form Adelaide High School. Increasing enrolment causing overcrowding led to a Parliamentary Standing Committee on Public Works which reported in 1938 that conditions were most unsatisfactory. The school was housed in five buildings in three locations, with playing fields located nearly a kilometre away from the Grote Street site.

A decision was taken to erect a new school building, the site initially selected was ' . . . contiguous with the Exhibition Building adjacent Frome Road'. This site was rejected and the present site endorsed. Plans for the new boys' high school were originally prepared by the Public Works architect-in-chief. Although approved by the minister of education the plans were initially rejected because of the absence of an assembly hall. It was then decided that a competition for the most suitable design, incorporating a school hall, should be held.

The nation-wide competition attracting over sixty separate designs was won by Sydney architects Edward B. Fitzgerald and John K. Brogan in 1940. However, the outbreak of war delayed construction until 1947. The new school was opened in 1951, having been

Heritage of the City of Adelaide

constructed by A.W. Baulderstone for £90 000. After the competition the magazine *Architecture* described the building in the following manner:

Two radial class room wings converged upon a curved block, which forms the main feature of the building facing West Terrace. The two wings are linked at the western end by a workshop section, thus enclosing a spacious quadrangle and protecting it from prevailing winds. One liberally-planned area for outdoor assembly and exercise purposes is considered more generally useful for a Boys' School than the two smaller areas some planners submitted, these being better suited to a mixed school. The two class-room flanks bearing in toward the office or administrative zone tend to economise in corridor length, and so reduce student traffic within the building . . .

Its expressive elevations are disciplined and consistently detailed. The parapet walls which hide the roofs, continuous horizontal window lines, curved elements and corners are representative of the 'modern' aesthetic which had as its basic philosophy the formal recognition of each function.

In 1977-78 the school became coeducational and in 1982 new additions, sympathetic to the original, were opened.

Architecture, December 1940; State Heritage Branch, File 6628-12557, Adelaide High School.

The text in this Information Sheet was copied from the **Heritage of the City of Adelaide: An Illustrated Guide**, (1996). The photographs contained in this Information Sheet are a selection of those held by Heritage Services, in digital format.

The property described in this Information Sheet is included in the Register of State Heritage places. A heritage listing does not mean or imply right of access by the public to such properties.

The heritage related Principles of Development Control as well as the Precinct specific objectives and Principles of Development Control are contained in the Adelaide (City) Development Plan. These should be referred to in whole when contemplating any development.

Further information on the Heritage Incentives Scheme, an initiative of Council to sponsor timely and appropriate conservation action is available upon request of the Customer Service Centre.



CITY OF ADELAIDE HERITAGE STUDY

The City Heritage Register-Definition of Items

Prepared by the Dept. of Planning and Development

Item ADELAIDE HIGH SCHOOL
(Former Adelaide Boys High School)
Address Corner Glover Avenue and West Terrace,
(Park No. 24,10)

Building No
241001

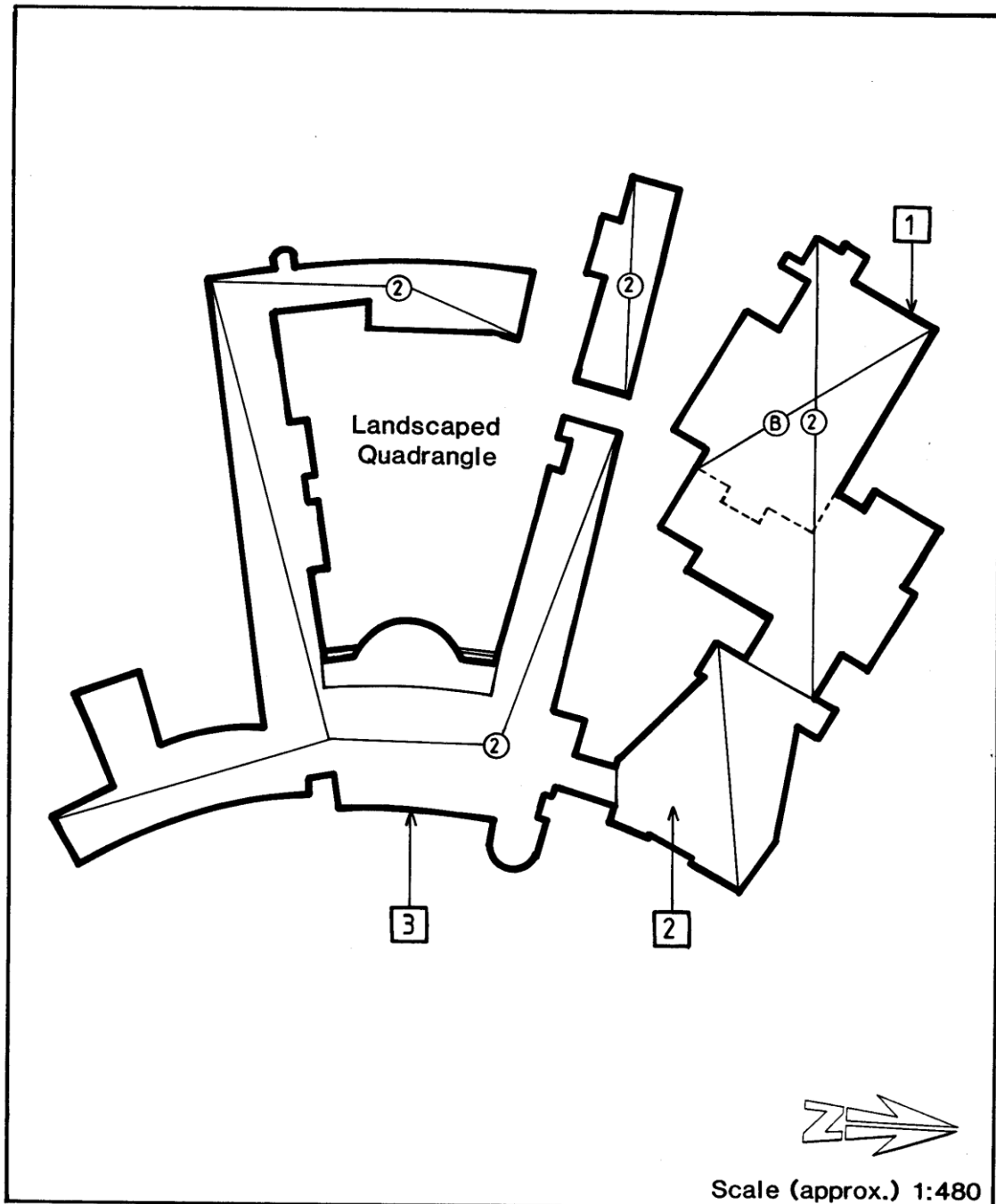

Image scanned - not to stated scale.

This Curtilage Map has been prepared as a guide only and no warranty or assurance is given about the accuracy of the content as it may contain obsolete information. The Corporation excludes all liability [including for negligence] in relation to your use of these documents.



CITY OF ADELAIDE HERITAGE STUDY

The City Heritage Register-Definition of Items

Prepared by the Dept. of Planning and Development

Item	ADELAIDE HIGH SCHOOL (Former Adelaide Boys High School)	Building No 241001
Address	Corner Glover Avenue and West Terrace, (Park No. 24.10)	

NOTES:

1. Sympathetic additions (1982).
2. Assembly Hall/Auditorium.
3. Note ribbon windows, curved elements and articulation of facade.